

STATE OF ILLINOIS
DEPARTMENT OF TRANSPORTATION
DIVISION OF HIGHWAYS

**PROPOSED
HIGHWAY PLANS**

FAP ROUTE 323 (US 36)
SECTION (144R)RS-2 & 145RS-3
RESURFACING INTERMITTENT
DOUGLAS COUNTY
HAYES BRANCH DITCH TO TR 122 E OF TUSCOLA
PROJECT NHF-0323(030)

F.A.P. RTE.	SECTION	COUNTY	TOTAL SHEETS	SHEET NO.
323	(144R)RS-2 & 145RS-3	DOUGLAS	21	1
		ILLINOIS	CONTRACT NO. 70902	

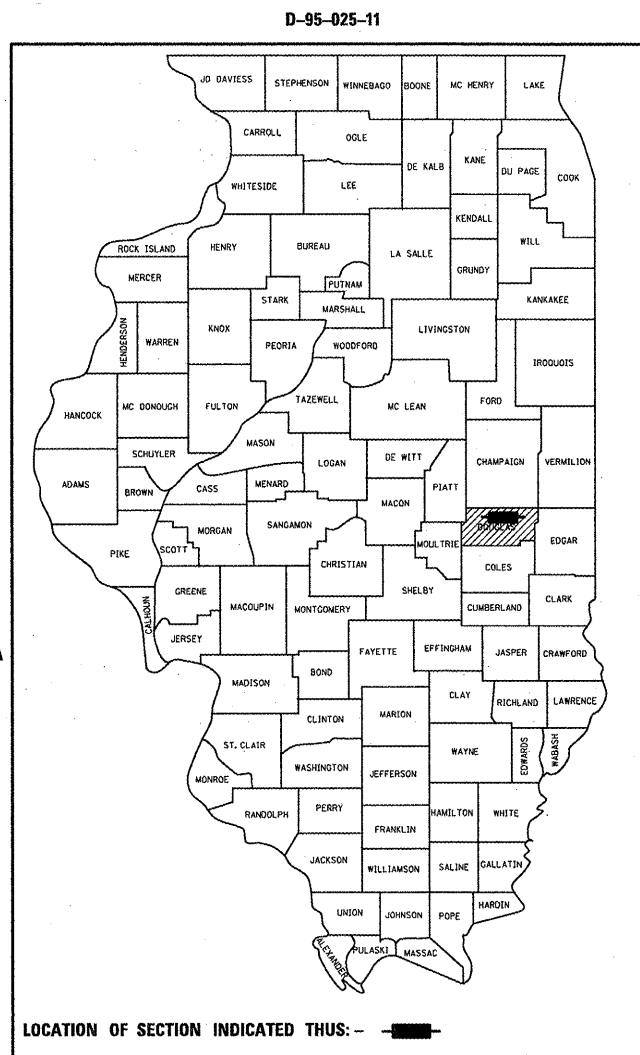

FOR INDEX OF SHEETS, SEE SHEET NO. 2
FOR SUMMARY OF QUANTITIES, SEE SHEET NO. 4

STRUCTURE INFORMATION

S.N.	SCOPE OF WORK
021-8017	MILL & INLAY

C-95-025-11

CURRENT ADT
OTHER PRINCIPAL ARTERIAL
FAP 323 (US 36) = 5,300 (2011)
SU = 4.9% MU = 4.7%

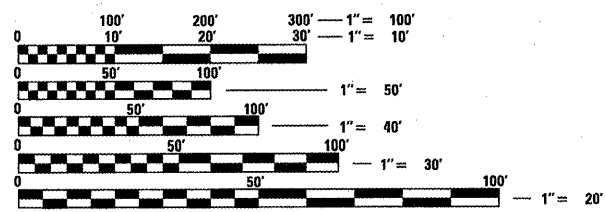

FULL SIZE PLANS HAVE BEEN PREPARED USING STANDARD ENGINEERING SCALES. REDUCED SIZED PLANS WILL NOT CONFORM TO STANDARD SCALES. IN MAKING MEASUREMENTS ON REDUCED PLANS, THE ABOVE SCALES MAY BE USED.

J.U.L.I.E.
JOINT UTILITY LOCATION INFORMATION FOR EXCAVATION
1-800-892-0123 TOWNSHIPS
OR 811 TUSCOLA

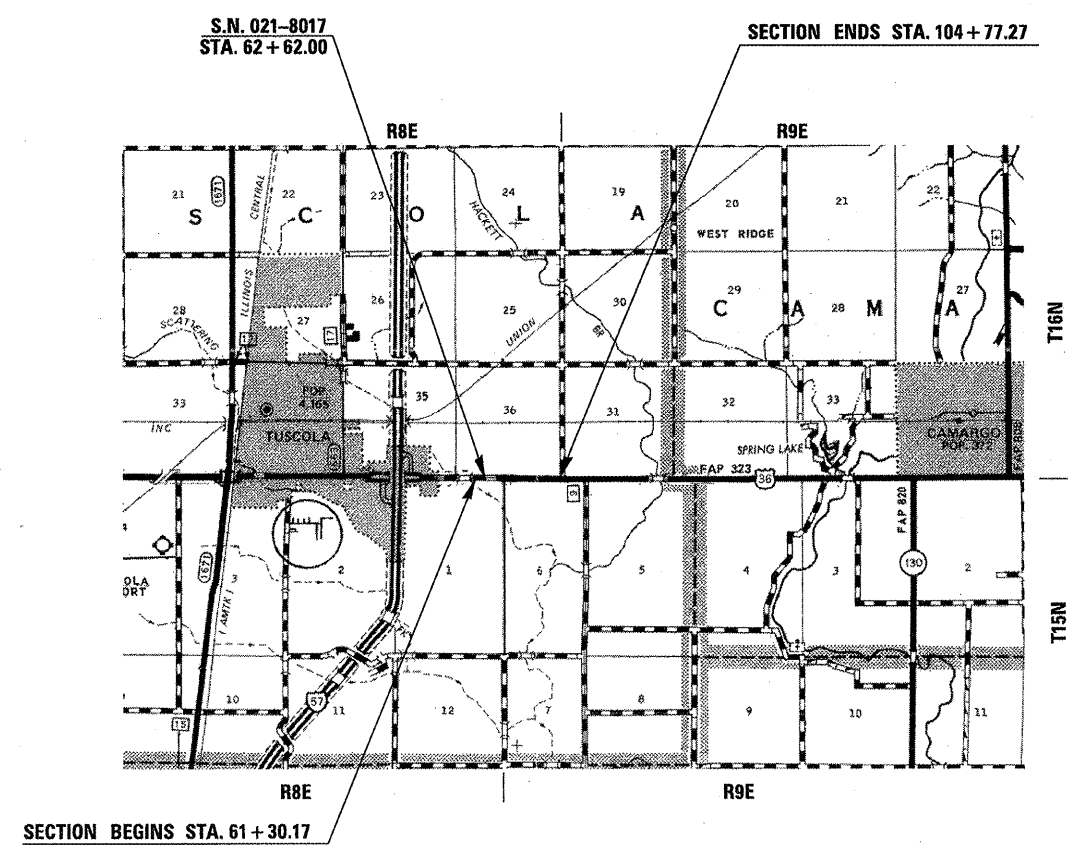

SECTION BEGINS STA. 61+30.17

GROSS LENGTH = 4,347.10 FT. = 0.823 MILE
NET LENGTH = 4,347.10 FT. = 0.823 MILE

STATE OF ILLINOIS
DEPARTMENT OF TRANSPORTATION
DIVISION OF HIGHWAYS

SUBMITTED 1/30 20 12

Justin A. Coombs
DEPUTY DIRECTOR OF HIGHWAYS, REGION ENGINEER

March 23 20 12
John D. Baranzelli, P.E.
acting ENGINEER OF DESIGN AND ENVIRONMENT

March 23 20 12
William R. Frey
acting DIRECTOR OF HIGHWAYS, CHIEF ENGINEER

**PRINTED BY THE AUTHORITY
OF THE STATE OF ILLINOIS**

PROJECT ENGINEER: NANCY FASIG
SQUAD LEADER: STEVE COOMBES
(217) 465-4181
CONTRACT NO. 70902