

SEE SHEET 13-M FOR
SIGN REPLACEMENT SCHEDULE

(16) NOTE: EX. AGG SHOULDER TO BE REMOVED FROM STA. 136+51.24 TO STA. 139+75.77 (NORTH BOUND)
FROM STA. 135+14.23 TO STA. 138+70.77 (SOUTH BOUND)
NOTE: EX. GUARDRAIL TO BE REMOVED FROM STA. 136+90.00 TO STA. 138+40.00 (NORTH BOUND)
FROM STA. 136+41.00 TO STA. 139+01.00 (SOUTH BOUND)

(17) +56.00
+81.00
+15.00

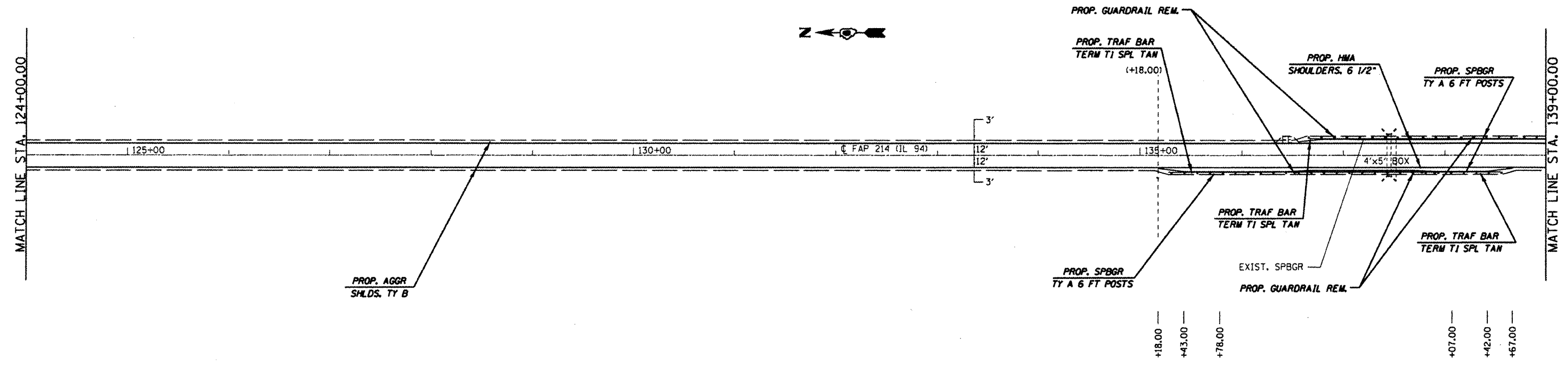

(17) +12.00
+47.00
+72.00

(18)

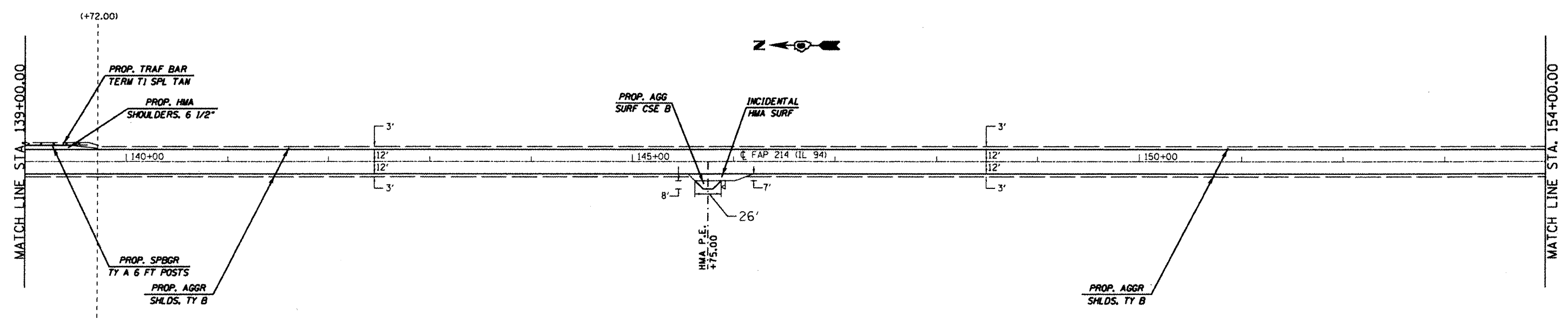

FILE NAME =	USER NAME = coxju	DESIGNED - JWC	REVISED -
ca:\pwwork\periods\coxju\18221152\067205	http:plan.dgn	DRAWN - JWC	REVISED -
PLOT SCALE = 1/8\"/>			

STATE OF ILLINOIS
DEPARTMENT OF TRANSPORTATION

PLAN SHEETS
SCALE: 50 SHEET NO. 5 OF 8 SHEETS STA. 124+00.00 TO STA. 154+00.00

F.A.P. RTE.	SECTION	COUNTY	TOTAL SHEETS	SHEET NO.
514	106RS-6	HANCOCK	26	19
CONTRACT NO. T2C92			ILLINOIS FED. AID PROJECT	