

STATE OF ILLINOIS
DEPARTMENT OF TRANSPORTATION
DIVISION OF HIGHWAYS

**PROPOSED
HIGHWAY PLANS**

FAP ROUTE 828 & 773 (ILL 121)
SECTION (108, 109, 110)RS-3
PROJECT F-000S(859)
HMA RESURFACING /BOX CULVERT REPLACEMENT
CUMBERLAND COUNTY

C-97-080-07

F.A.P. RTE.	SECTION	COUNTY	TOTAL SHEETS	SHEET NO.
*	(108,109,110)RS-3	Cumberland	56	1
ILLINOIS CONTRACT NO. 74252			** 56 + 1 = 57	

D97-071-09

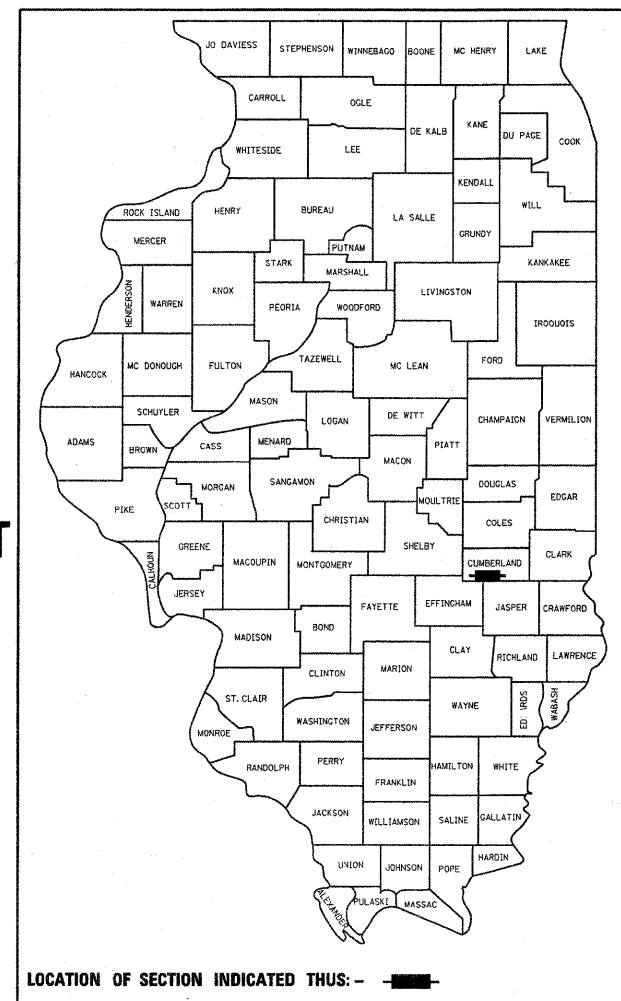

LOCATION OF SECTION INDICATED THUS: - ■ -

FOR INDEX OF SHEETS, SEE SHEET NO. 2

ADT = 2081(2009)

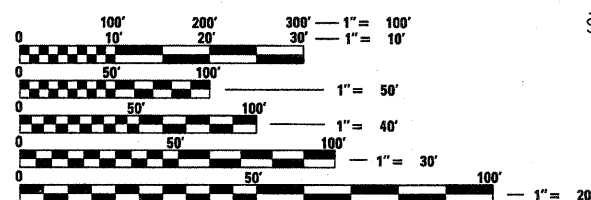

FULL SIZE PLANS HAVE BEEN PREPARED USING STANDARD ENGINEERING SCALES. REDUCED SIZED PLANS WILL NOT CONFORM TO STANDARD SCALES. IN MAKING MEASUREMENTS ON REDUCED PLANS, THE ABOVE SCALES MAY BE USED.

J.U.L.I.E.
JOINT UTILITY LOCATION INFORMATION FOR EXCAVATION
1-800-892-0123
OR 811

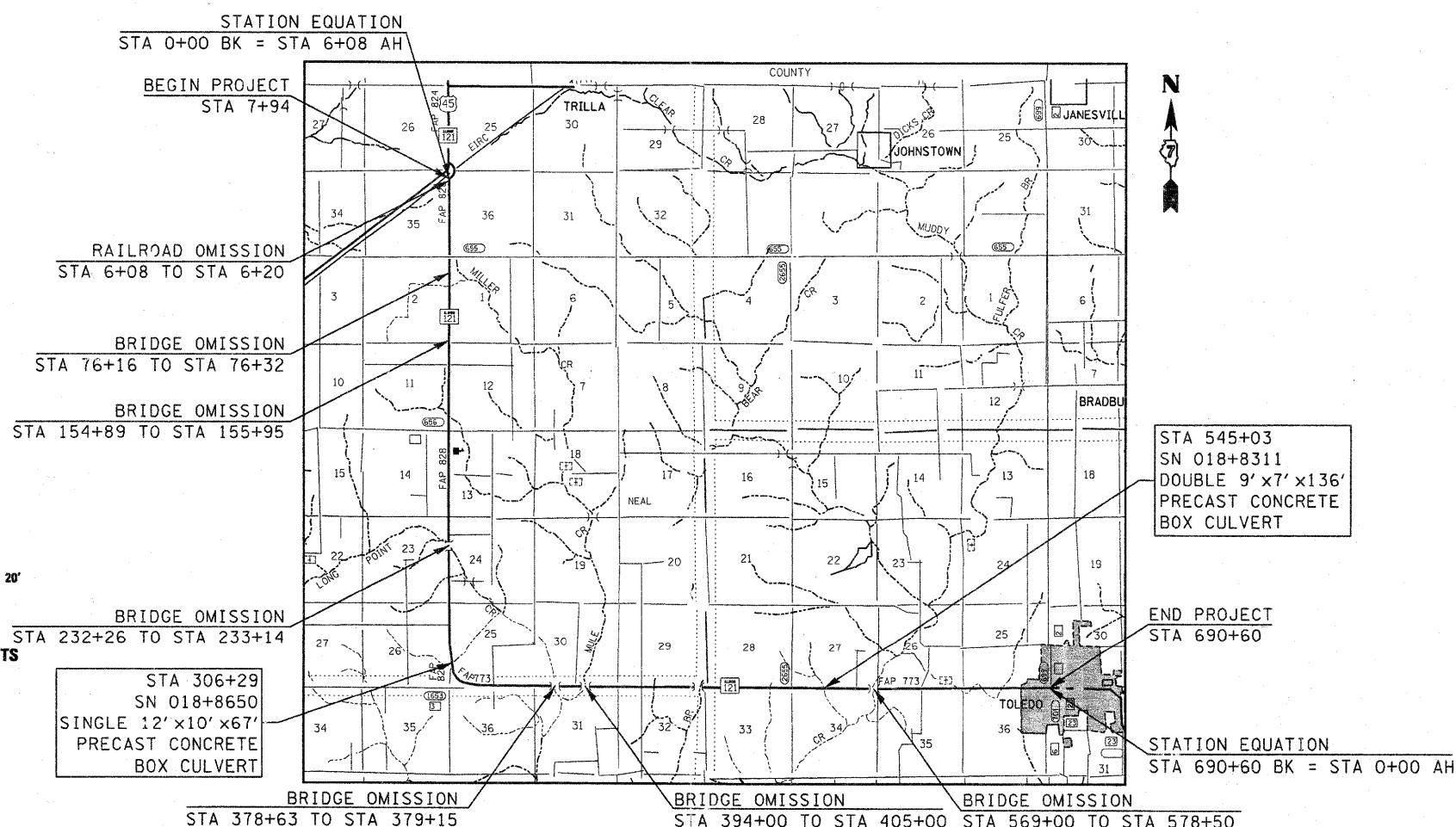

PROJECT ENGINEER: MARK DAUGHERTY
PROJECT MANAGER: JOYCE HEMMEN

CONTRACT NO. 74252

GROSS LENGTH = 69,246 FT. = 13.11 MILE
NET LENGTH = 66,922 FT. = 12.67 MILE

STATE OF ILLINOIS
DEPARTMENT OF TRANSPORTATION
DIVISION OF HIGHWAYS

SUBMITTED May 12 20 11
Roger L. Duvall
DEPUTY DIRECTOR OF HIGHWAYS, REGION ENGINEER

March 23 20 12
John D. Buannelli P.E.
ENGINEER OF DESIGN AND ENVIRONMENT

March 23 20 12
William R. Fley
DIRECTOR OF HIGHWAYS, CHIEF ENGINEER

PRINTED BY THE AUTHORITY
OF THE STATE OF ILLINOIS