

PLAN  
 SURVEYED BY  
 PLOTTED BY  
 GRADES CHECKED BY  
 STRUCTURE NOTATION CHECKED BY  
 CAD FILE NAME

PROFILE  
 SURVEYED BY  
 PLOTTED BY  
 GRADES CHECKED BY  
 STRUCTURE NOTATION CHECKED BY

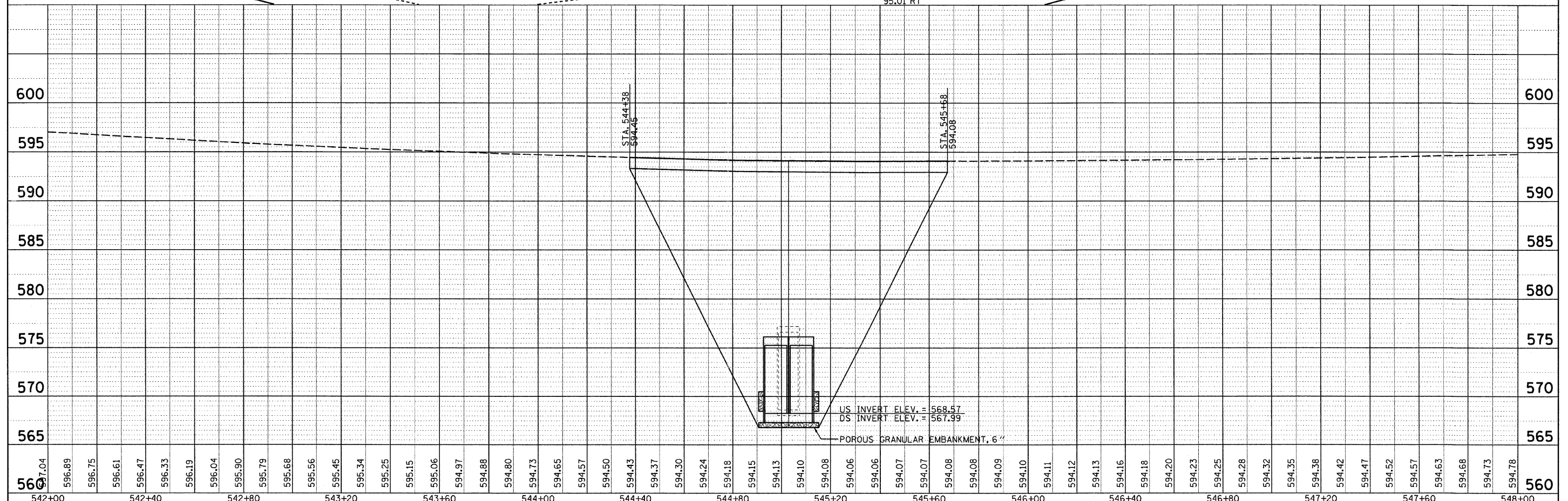
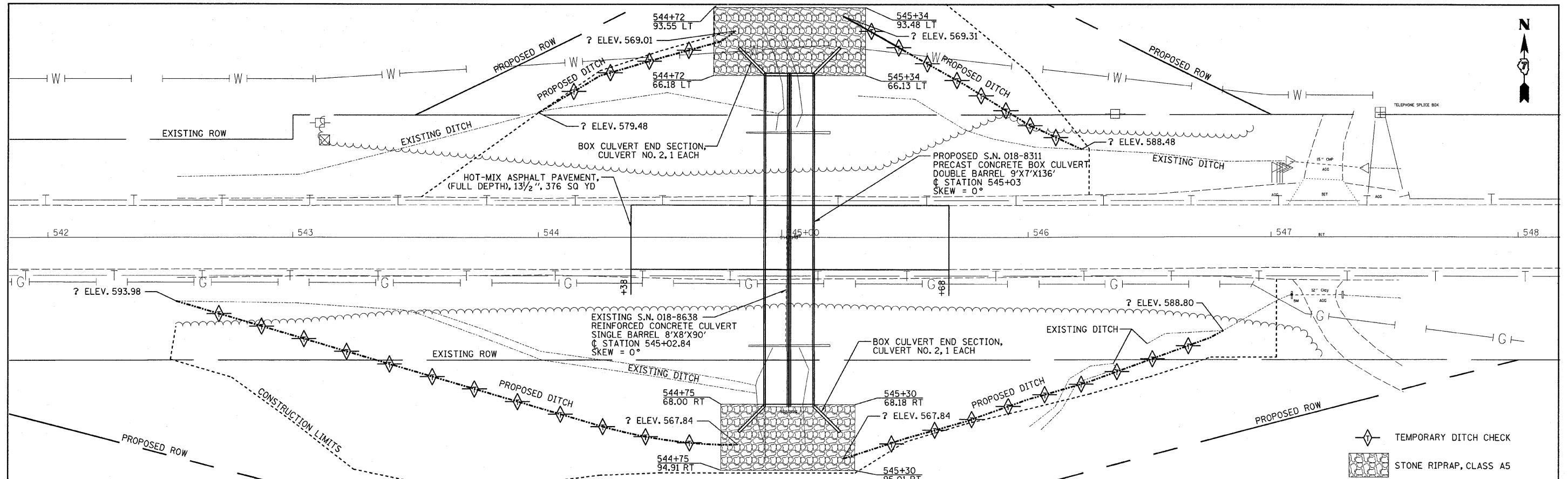

560	567.04	542+00	542+40	542+80	543+20	543+60	544+00	544+40	544+80	545+20	545+60	546+00	546+40	546+80	547+20	547+60	548+00	560
560	596.89																	560
	596.75																	
	596.61																	
	596.47																	
	596.33																	
	596.19																	
	596.04																	
	595.90																	
	595.79																	
	595.68																	
	595.56																	
	595.45																	
	595.34																	
	595.25																	
	595.15																	
	595.06																	
	594.97																	
	594.88																	
	594.80																	
	594.73																	
	594.65																	
	594.57																	
	594.50																	
	594.43																	
	594.37																	
	594.30																	
	594.24																	
	594.18																	
	594.15																	
	594.13																	
	594.10																	
	594.08																	
	594.06																	
	594.06																	
	594.07																	
	594.07																	
	594.08																	
	594.08																	
	594.09																	
	594.10																	
	594.11																	
	594.12																	
	594.13																	
	594.16																	
	594.18																	
	594.20																	
	594.23																	
	594.25																	
	594.28																	
	594.32																	
	594.35																	
	594.38																	
	594.42																	
	594.47																	
	594.52																	
	594.57																	
	594.63																	
	594.68																	
	594.73																	
	594.78																	
	560																	

STATE OF ILLINOIS  
 DEPARTMENT OF TRANSPORTATION

PLAN AND PROFILE  
 SN 018-8311

F.A.P. RTE.	SECTION	COUNTY	TOTAL SHEETS	SHEET NO.
	(108,109,110)RS-3	Cumberland	56	21
ILLINOIS FED. AID PROJECT			CONTRACT NO. 74252	