

Bench Marks: Chiseled "□" in top of NE wingwall. 17.2' Lt. Sta. 55+86.4: Elev. 468.92  
 R.R. spike in 16' elm. 40' Lt. Sta. 61+05: Elev. 484.73.

Existing structure: Structure No. 060-0072 built 1930 as S.B.I. Route 4, Section 64-B at Sta. 56+81 as a single span slab bridge, 24'-1" back to back abutments, 32'-2" out to out width. Existing structure is to be removed and replaced. Traffic will be maintained utilizing stage construction.

Salvage: None

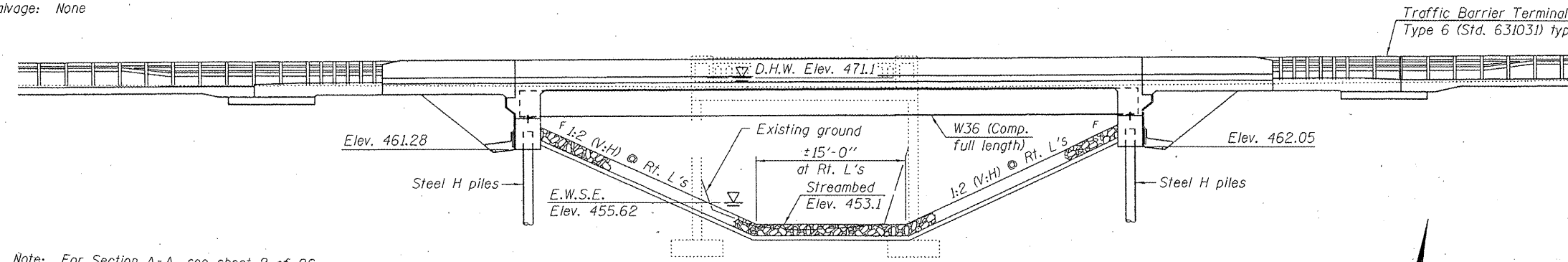

Note: For Section A-A, see sheet 2 of 26.

**ELEVATION**

**DESIGN SPECIFICATIONS**  
 2010 AASHTO LRFD Bridge Design Specifications, 5th Edition with 2010 Interims

**DESIGN STRESSES**  
**FIELD UNITS**  
 $f'_c = 3,500$  psi  
 $f_y = 50,000$  psi (Structural steel, M270 Gr 50W)  
 $f_y = 60,000$  psi (Reinforcement)

**LOADING HL-93**  
 Allow 50#/sq. ft. for future wearing surface.

**SEISMIC DATA**  
 Seismic Performance Zone (SPZ) = 3  
 Design Spectral Acceleration at 1.0 sec. ( $S_{D1}$ ) = 0.330  
 Design Spectral Acceleration at 0.2 sec. ( $S_{D5}$ ) = 0.741  
 Soil Site Class = E

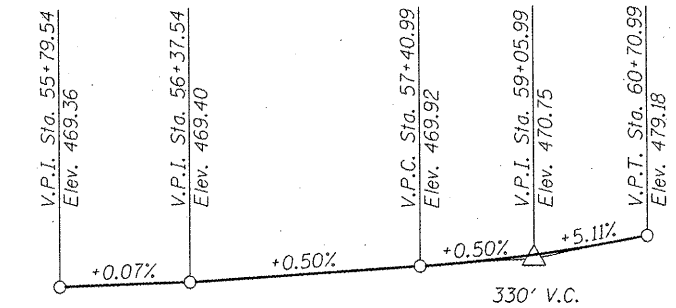

**PROFILE GRADE**  
 (Along @ roadway)

STATION 56+84.00  
 BUILT 20 BY  
 STATE OF ILLINOIS  
 F.A.S. RTE. 770 SEC. 64-1BR  
 LOADING HL-93  
 STRUCTURE NO. 060-0204

**NAME PLATE**  
 See Std. 515001

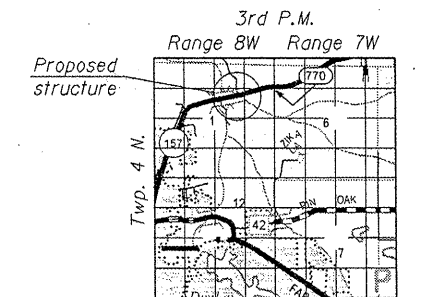

**LOCATION SKETCH**

**GENERAL PLAN & ELEVATION**  
 ILLINOIS ROUTE 157 OVER  
 SUGAR CREEK  
 F.A.S. ROUTE 770 SEC. 64-1BR  
 MADISON COUNTY  
 STA. 56+84.00  
 STRUCTURE NO. 060-0204

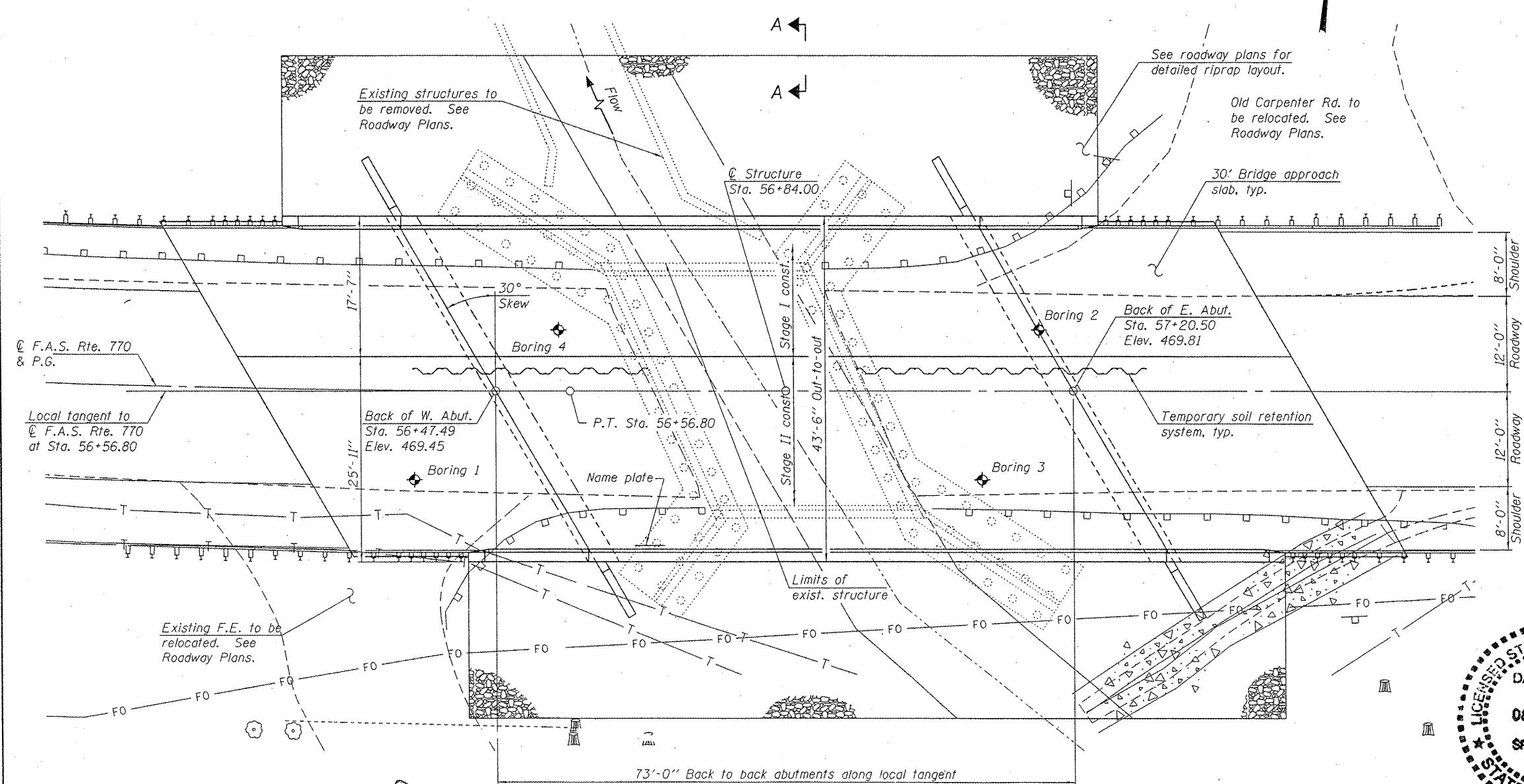

**PLAN**

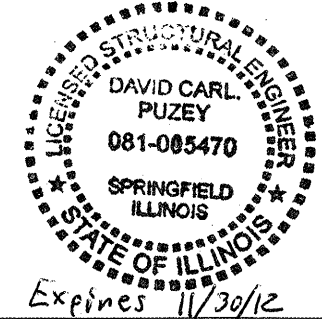

DESIGNED - S.M. Ryan  
 CHECKED - Fessell Tekel  
 DRAWN - n.t. duong  
 CHECKED - SMR/FT/GRA

EXAMINED - [Signature]  
 PASSED - [Signature]

DATE - 3-20-12

STATE OF ILLINOIS  
 DEPARTMENT OF TRANSPORTATION

GENERAL PLAN & ELEVATION  
 STRUCTURE NO. 060-0204

SHEET NO. 1 OF 26 SHEETS

F.A.S. RTE. 770	SECTION 64-1BR	COUNTY MADISON	TOTAL SHEETS 137	SHEET NO. 75
			CONTRACT NO. 76401	
ILLINOIS FED. AID PROJECT				