

BAUGH AVENUE

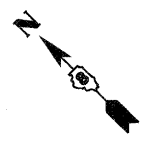

MATCH LINE STA 50+00 @ EB I-64
SEE SHEET 6 OF 19

MATCH LINE STA 55+50 @ EB I-64
SEE SHEET 8 OF 19

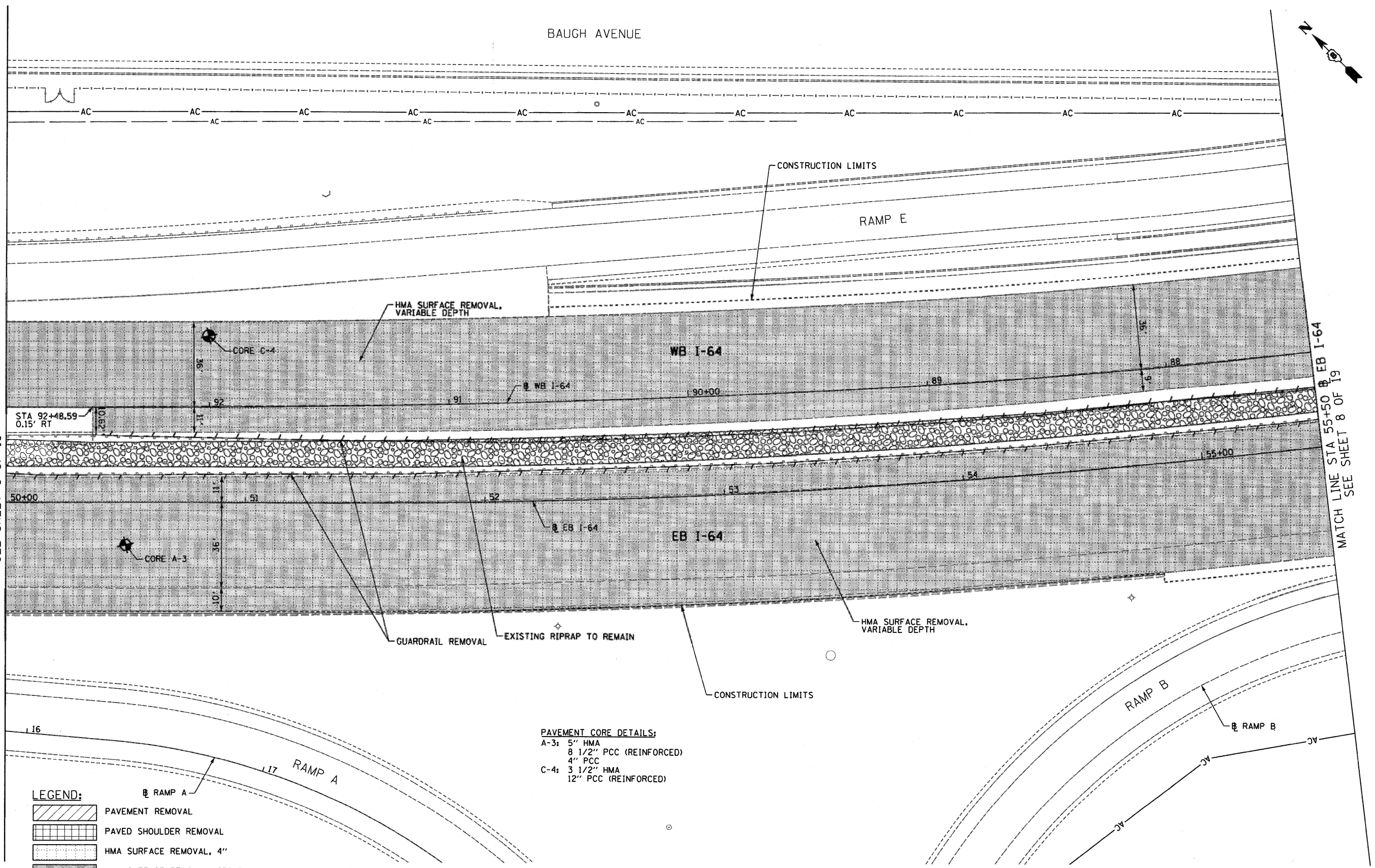

- LEGEND:**
- PAVEMENT REMOVAL
 - PAVED SHOULDER REMOVAL
 - HMA SURFACE REMOVAL, 4"
 - HMA SURFACE REMOVAL, SEE PLANS AND HMA TABLES FOR THICKNESS
 - LINEAR REMOVAL

PAVEMENT CORE DETAILS:
 A-3: 5" HMA
 8 1/2" PCC (REINFORCED)
 4" PCC
 C-4: 3 1/2" HMA
 12" PCC (REINFORCED)

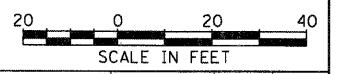

FILE NAME = DBTr-76C52-shtrrem-07.dgn	USER NAME = searsb	DESIGNED OP	REVISED -	STATE OF ILLINOIS DEPARTMENT OF TRANSPORTATION	REMOVAL PLAN EB I-64 & WB I-64			F.A.I. RTE.	SECTION	COUNTY	TOTAL SHEETS	SHEET NO.	
PLOT SCALE = 48.0000' / in.	DRAWN PHP	CHECKED DBM	REVISED -		SCALE: 1" = 20'	SHEET NO. 7 OF 19 SHEETS	STA. 50+00	TO STA. 55+50	82-1-R(A), 82-1-R(B)	ST. CLAIR	629	78	
PLOT DATE = 1/24/2012	DATE 1-20-12	REVISED -	REVISED -						64/998/70				CONTRACT NO. 76C52
									FED. ROAD DIST. NO.	ILLINOIS	FED. AID PROJECT		