

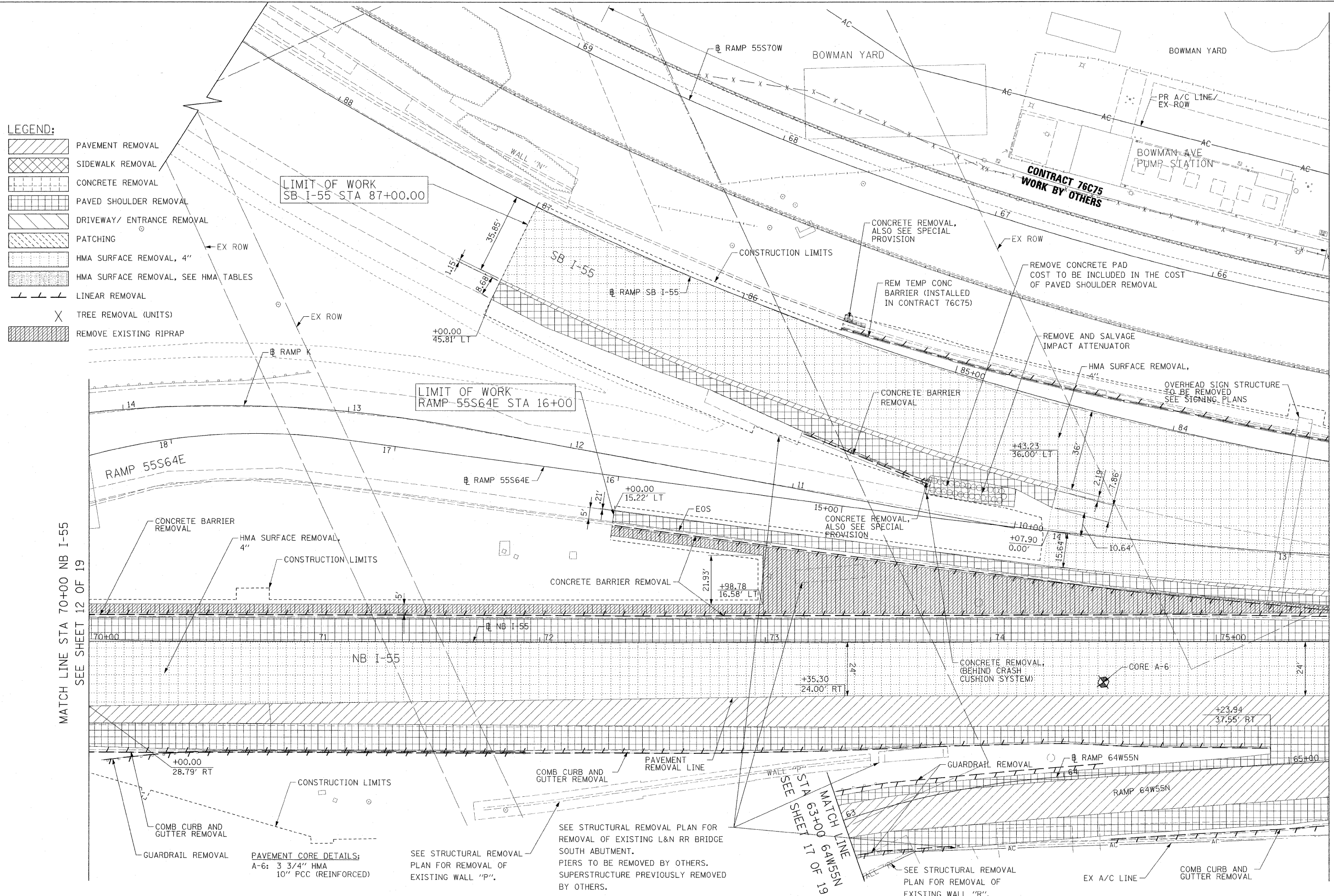

LEGEND:

	PAVEMENT REMOVAL
	SIDEWALK REMOVAL
	CONCRETE REMOVAL
	PAVED SHOULDER REMOVAL
	DRIVEWAY/ ENTRANCE REMOVAL
	PATCHING
	HMA SURFACE REMOVAL, 4"
	HMA SURFACE REMOVAL, SEE HMA TABLES
	LINEAR REMOVAL
	TREE REMOVAL (UNITS)
	REMOVE EXISTING RIPRAP



MATCH LINE STA 70+00 NB I-55
SEE SHEET 12 OF 19

MATCH LINE STA 75+50 NB I-55
SEE SHEET 14 OF 19

PAVEMENT CORE DETAILS:
A-6: 3 3/4" HMA
10" PCC (REINFORCED)

SEE STRUCTURAL REMOVAL PLAN FOR REMOVAL OF EXISTING WALL "P".
SEE STRUCTURAL REMOVAL PLAN FOR REMOVAL OF EXISTING WALL "R".

MATCH LINE
STA 63+00 NB I-55
SEE SHEET 17 OF 19

FILE NAME =
D8TR1-76C52-Sht-Rem-13.dgn

USER NAME = pmsarno
PLOT SCALE = 28.0000' / 1" / in.
PLOT DATE = 3/1/2012

DESIGNED KM
DRAWN KM
CHECKED DBM
DATE 03-01-12

REVISED -
REVISED -
REVISED -
REVISED -

**STATE OF ILLINOIS
DEPARTMENT OF TRANSPORTATION**

**REMOVAL PLAN
I-55**

SCALE: 1" = 20'
SHEET NO. 13 OF 19 SHEETS
STA. 70+00 TO STA. 75+50

F.A.I. RTE.	SECTION	COUNTY	TOTAL SHEETS	SHEET NO.
64/998/70	82-1-R(A), 82-1-R(B)	ST. CLAIR	629	84
FED. ROAD DIST. NO. [ILLINOIS] FED. AID PROJECT		CONTRACT NO. 76C52		