

SOUTH WEST
INTERSTATE 55 INTERSTATE 70
CLOSED AT IL 203
FOLLOW DETOUR
 OVERLAY PANEL TO REMAIN IN PLACE UNTIL CLOSURE IS ACTIVE
FRI MM/DD 9:00 PM

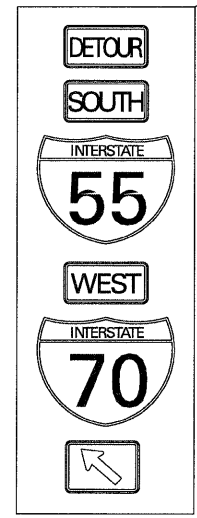

LEGEND
 —▶—▶—▶— PRIMARY ROUTE OF DETOUR
 - x - x - x - CLOSED TO TRAFFIC

NOTE:
 SEE SHEET 15 FOR SUGGESTED SIGN SEQUENCING AND SPACING

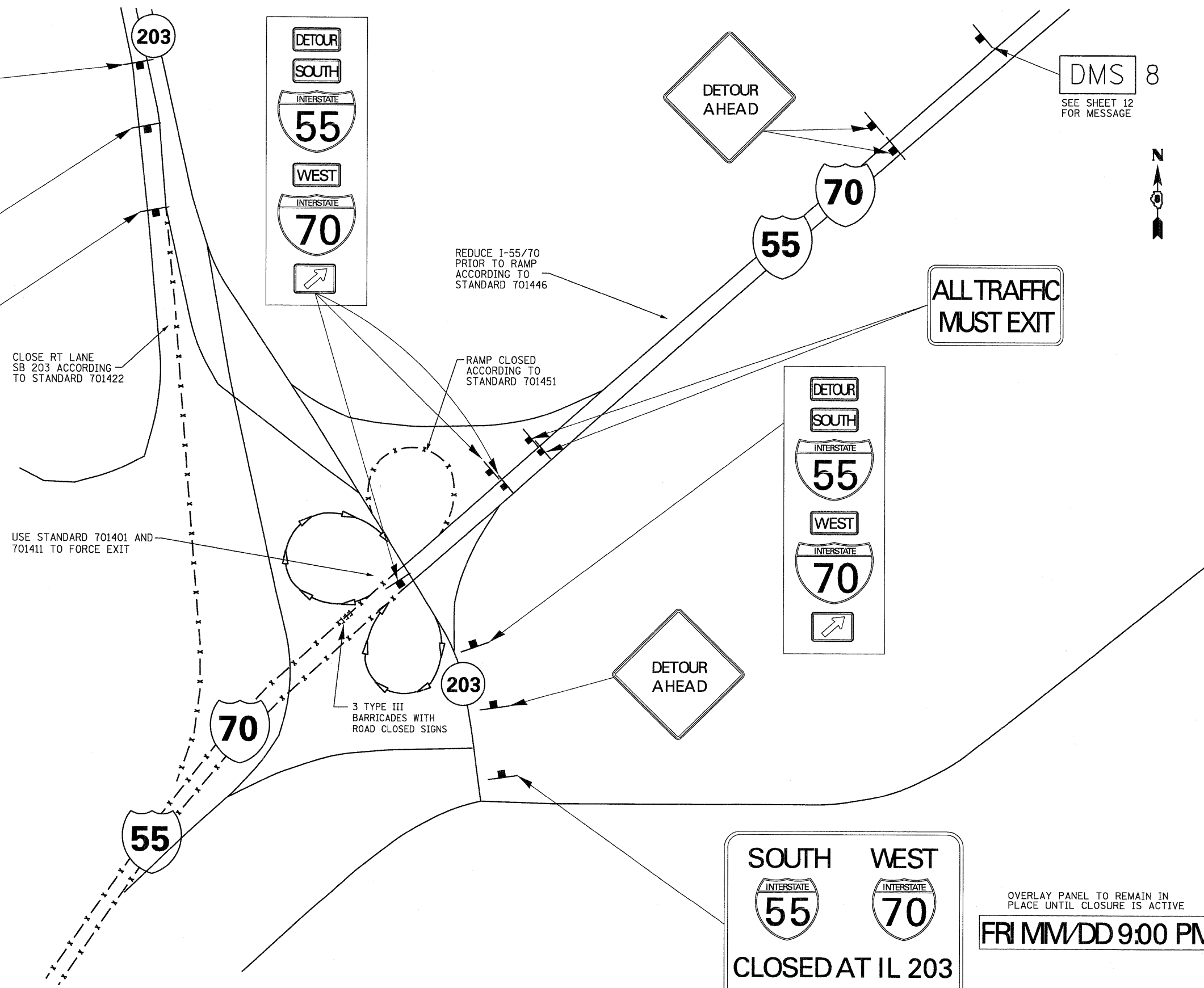

DMS 8
 SEE SHEET 12 FOR MESSAGE

SOUTH WEST
INTERSTATE 55 INTERSTATE 70
CLOSED AT IL 203
FOLLOW DETOUR

OVERLAY PANEL TO REMAIN IN PLACE UNTIL CLOSURE IS ACTIVE
FRI MM/DD 9:00 PM

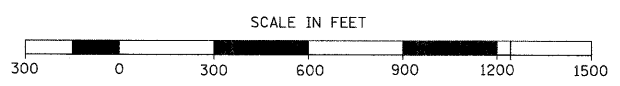

FILE NAME = 080verall-00-sht-staging03.dgn	USER NAME = jroggetz	DESIGNED - DS	REVISED -	STATE OF ILLINOIS DEPARTMENT OF TRANSPORTATION	INTERSTATE WEEKEND CLOSURE FOR INTERSTATE 55/70 INTERSTATE 55/70 AND ILLINOIS 203		F.A.I. RTE. 70	SECTION	COUNTY ST. CLAIR	TOTAL SHEETS 629	SHEET NO. 143
	PLOT SCALE = 600.0000' / in.	DRAWN - AS	REVISED -		SCALE: 1" = 300'	SHEET NO. 3 OF 15 SHEETS	STA.			CONTRACT NO. 76C52	
	PLOT DATE = 1/6/2012	CHECKED -	REVISED -				TO STA.				
		DATE - 01/06/12	REVISED -								