

**LEGEND**

▶ —▶ PRIMARY ROUTE OF DETOUR

- x - x - x - CLOSED TO TRAFFIC

DETOUR

SOUTH

INTERSTATE

55

WEST

INTERSTATE

70

↑

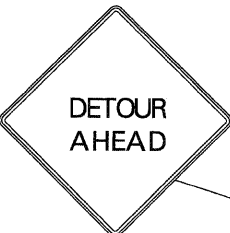

SOUTH WEST

INTERSTATE INTERSTATE

55 70

CLOSED AT IL 203  
FOLLOW DETOUR

OVERLAY PANEL TO REMAIN IN PLACE UNTIL CLOSURE IS ACTIVE

FRI MM/DD 9:00 PM

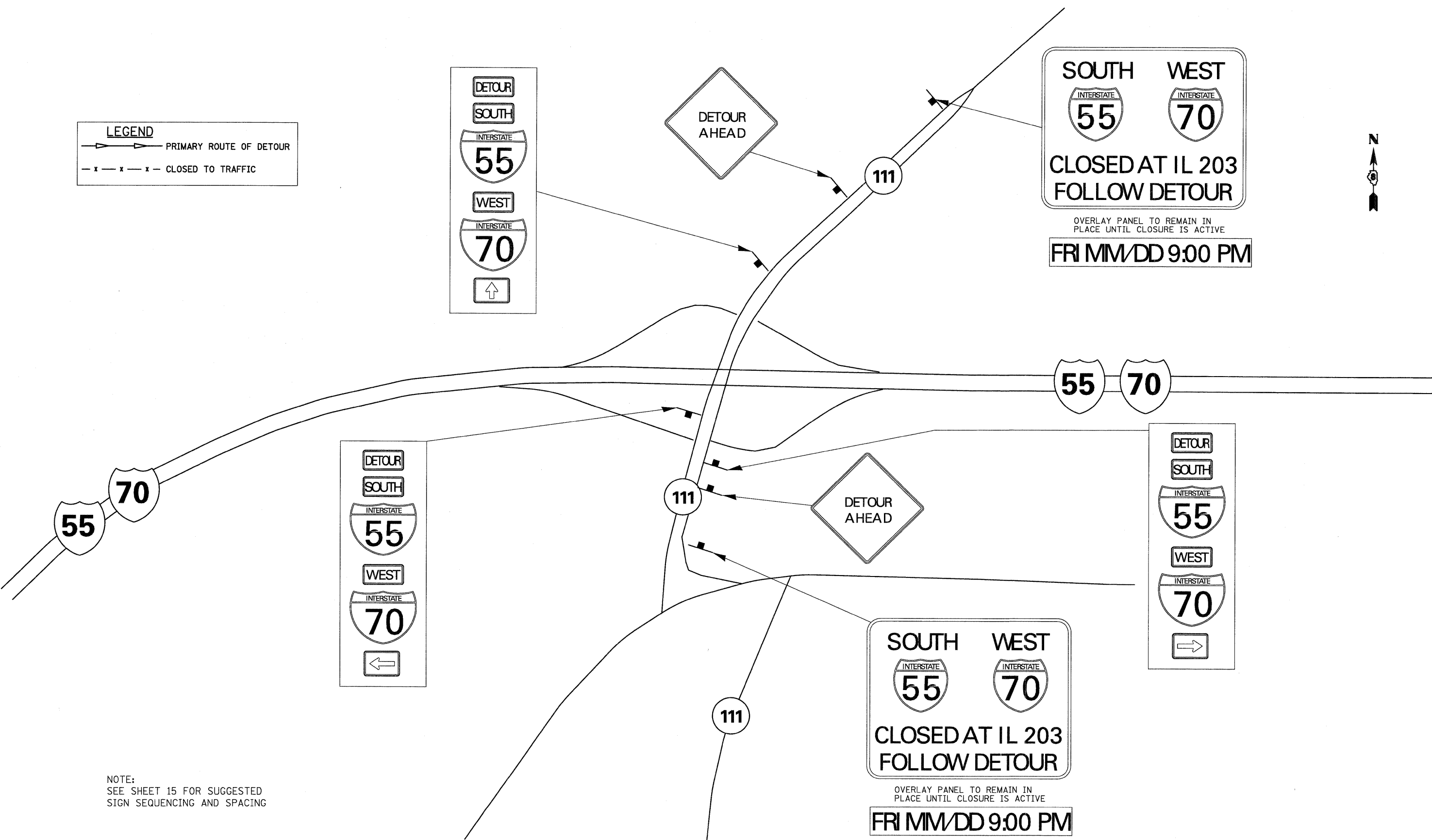

DETOUR

SOUTH

INTERSTATE

55

WEST

INTERSTATE

70

←



DETOUR

SOUTH

INTERSTATE

55

WEST

INTERSTATE

70

→

SOUTH WEST

INTERSTATE INTERSTATE

55 70

CLOSED AT IL 203  
FOLLOW DETOUR

OVERLAY PANEL TO REMAIN IN PLACE UNTIL CLOSURE IS ACTIVE

FRI MM/DD 9:00 PM

NOTE:  
SEE SHEET 15 FOR SUGGESTED  
SIGN SEQUENCING AND SPACING

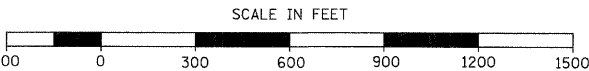

FILE NAME = D80verall-00-shr-staging04.dgn	USER NAME = jroggett	DESIGNED - DS	REVISED -	<b>STATE OF ILLINOIS DEPARTMENT OF TRANSPORTATION</b>	<b>INTERSTATE WEEKEND CLOSURE FOR INTERSTATE 55/70 AND ILLINOIS 111</b>			F.A.I. RTE. 70	SECTION	COUNTY ST. CLAIR	TOTAL SHEETS 629	SHEET NO. 144
	PLOT SCALE = 600.0000' / in.	DRAWN - AS	REVISED -		SCALE: 1" = 300'	SHEET NO. 4 OF 15 SHEETS	STA.	TO STA.	CONTRACT NO. 76C52			
	PLOT DATE = 1/6/2012	CHECKED -	REVISED -		ILLINOIS FED. AID PROJECT							
		DATE - 01/06/12	REVISED -									