

**NOTES:**

1. USE STANDARD 701411 FOR LANE CLOSURE AT EXIT RAMP A AND ENTRANCE RAMP E

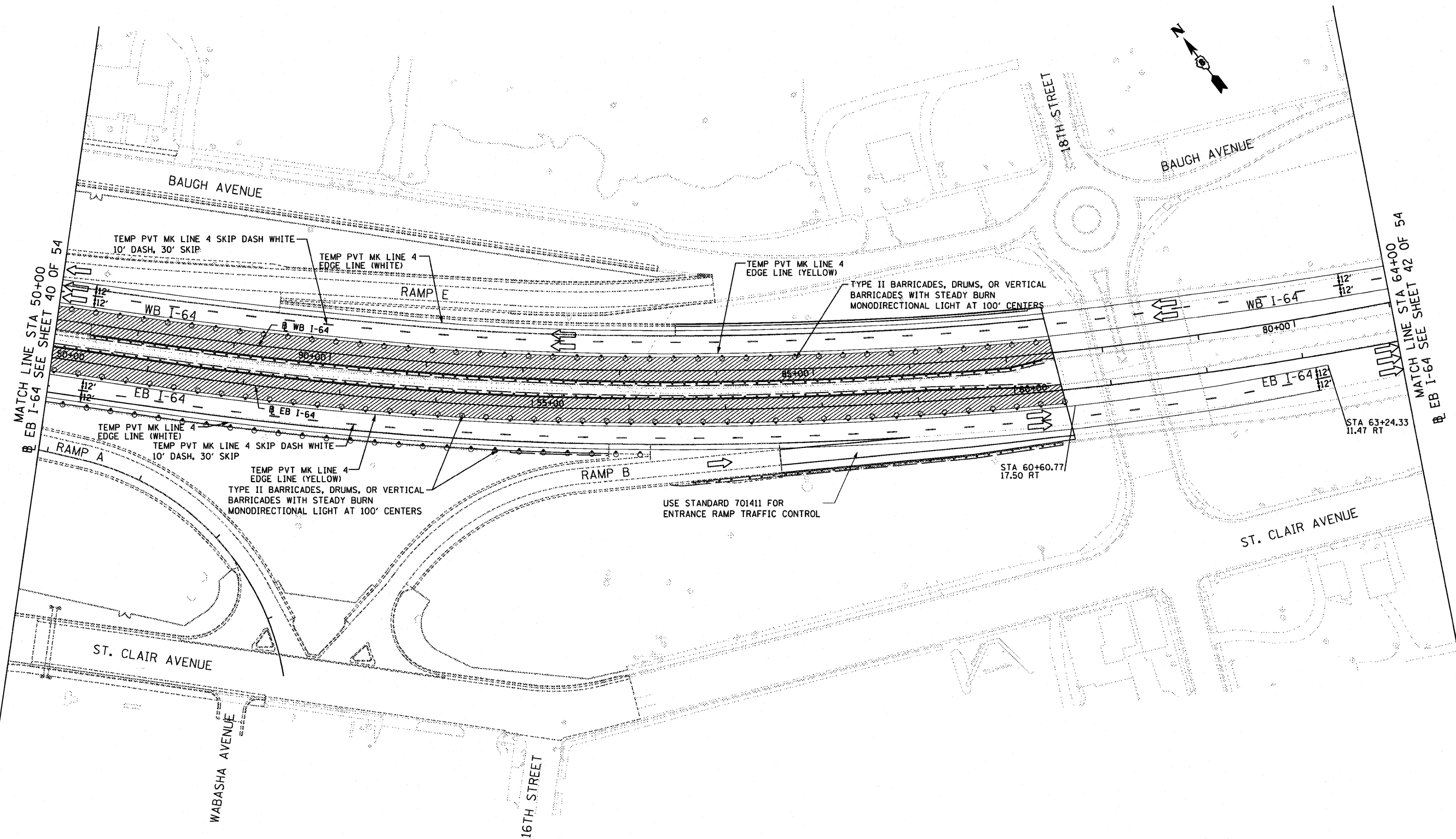

FILE NAME = DBTr-76C52-sh1-Stage5-03.dgn	USER NAME = searab	DESIGNED KM	REVISED -	<b>STATE OF ILLINOIS DEPARTMENT OF TRANSPORTATION</b>	<b>I-64 MAINLINE - SUGGESTED STAGES OF CONSTRUCTION AND TRAFFIC CONTROL PLAN - STAGE 5</b>	F.A.I. RTE.	SECTION	COUNTY	TOTAL SHEETS	SHEET NO.
	PLOT SCALE = 1/8" = 50'	CHECKED DBM	REVISED -			82-1-(A), 82-1-(B)	ST. CLAIR	629	223	
PLOT DATE = 1/25/2012	DATE 1-20-12	REVISED -	REVISED -	SCALE: 1" = 50'	SHEET NO. 42 OF 54 SHEETS	STA. 50+00	TO STA. 64+00	FED. ROAD DIST. NO.	ILLINOIS FED. AID PROJECT	CONTRACT NO. 76C52