

CONCRETE BARRIER, DOUBLE FACE, 42 INCH HEIGHT

SCALE: NONE
 ** INSIDE SHOULDER I-64 WB & RAMP 64W55S
 *** INSIDE SHOULDER I-64 EB & RAMP 64W70W

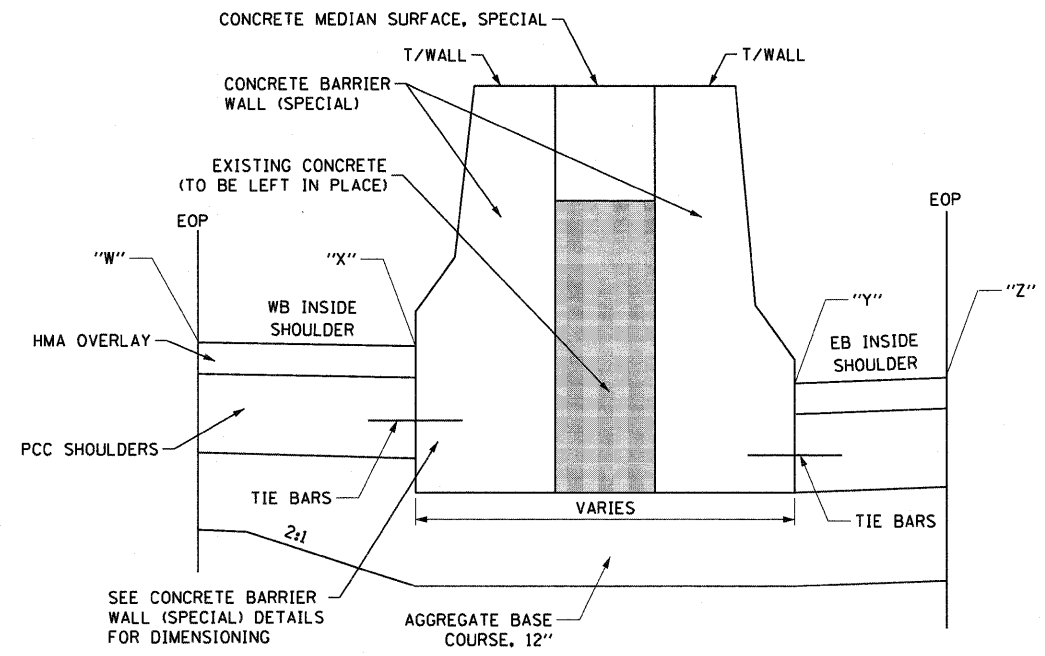

CONCRETE BARRIER WALL (SPECIAL) AROUND METROLINK RAILROAD BRIDGE PIER

SCALE: NONE
 NOTE: SEE SHEET OF FOR DETAILS.

DOUBLE FACE BARRIER WALL AND EDGE OF SHOULDER ELEVATIONS AND OFFSETS (I-64)

I-64 EB Station	W		X		Y		Z		T/WALL
	EL.	O/S	EL.	O/S	EL.	O/S	EL.	O/S	EL.
28+50.00	398.74	-31.43	398.20	-17.93	397.43	-14.93	398.03	0.00	401.70
28+75.00	398.21	-30.99	397.67	-17.48	397.15	-14.48	397.73	0.00	401.17
29+00.00	397.67	-30.42	397.13	-16.92	396.91	-13.91	397.47	0.00	400.63
29+25.00	397.23	-30.14	396.69	-16.64	396.66	-13.64	397.21	0.00	400.19
29+50.00	396.85	-30.12	396.31	-16.62	396.39	-13.62	396.94	0.00	399.89
29+75.00	396.62	-30.12	396.08	-16.62	396.17	-13.62	396.72	0.00	399.67
30+00.00	396.39	-30.12	395.85	-16.62	396.01	-13.62	396.56	0.00	399.51
30+25.00	396.33	-30.12	395.79	-16.62	395.90	-13.62	396.44	0.00	399.40
30+50.00	396.32	-30.12	395.78	-16.62	395.85	-13.62	396.39	0.00	399.35
30+75.00	396.43	-30.12	395.89	-16.62	395.85	-13.62	396.40	0.00	399.39
31+00.00	396.53	-30.12	395.99	-16.62	395.89	-13.62	396.43	0.00	399.49
31+25.00	396.70	-30.12	396.16	-16.62	396.01	-13.62	396.56	0.00	399.66
31+50.00	396.87	-30.12	396.33	-16.62	396.18	-13.62	396.72	0.00	399.83
31+75.00	397.05	-30.12	396.51	-16.62	396.36	-13.62	396.91	0.00	400.01
32+00.00	397.23	-30.12	396.69	-16.62	396.55	-13.62	397.09	0.00	400.19
32+25.00	397.40	-30.12	396.86	-16.62	396.75	-13.62	397.30	0.00	400.36
32+50.00	397.57	-30.12	397.03	-16.62	396.98	-13.62	397.52	0.00	400.53
32+75.00	397.71	-30.12	397.19	-17.33	397.21	-12.91	397.72	0.00	400.71
33+00.00	397.85	-30.12	397.31	-16.62	397.36	-13.62	397.91	0.00	400.86
33+25.00	397.99	-30.12	397.45	-16.62	397.53	-13.62	398.07	0.00	401.03
33+50.00	398.12	-30.12	397.58	-16.62	397.67	-13.62	398.22	0.00	401.17
33+75.00	398.24	-30.12	397.70	-16.62	397.81	-13.62	398.36	0.00	401.31
34+00.00	398.37	-30.12	397.83	-16.62	397.95	-13.62	398.50	0.00	401.45
34+25.00	398.45	-30.12	397.91	-16.62	398.07	-13.62	398.62	0.00	401.57
34+50.00	398.54	-30.12	398.00	-16.62	398.17	-13.62	398.72	0.00	401.67
34+75.00	398.64	-30.12	398.10	-16.62	398.24	-13.62	398.79	0.00	401.74
35+00.00	398.73	-30.12	398.20	-16.71	398.31	-12.50	398.81	0.00	401.81
BEGIN CONCRETE BARRIER WALL (SPECIAL) USED AROUND PIER. (SEE ROADWAY DETAIL)									
35+25.00	398.65	-30.12	398.12	-16.80	398.37	-11.11	398.81	0.00	402.12
35+50.00	398.64	-30.12	398.11	-16.80	398.40	-9.73	398.79	0.00	402.15
35+75.00	398.50	-30.12	397.97	-16.80	398.42	-8.34	398.75	0.00	402.17
36+00.00	398.49	-30.12	397.96	-16.83	398.38	-8.42	398.71	0.00	402.13
36+25.00	398.48	-30.12	397.95	-16.88	398.29	-9.00	398.65	0.00	402.04
36+50.00	398.47	-30.12	397.94	-16.95	398.14	-10.35	398.55	0.00	401.89
END CONCRETE BARRIER WALL (SPECIAL) USED AROUND PIER. (SEE ROADWAY DETAIL)									
36+75.00	398.43	-30.12	397.89	-16.62	398.00	-11.71	398.46	0.00	401.50
37+00.00	398.40	-30.12	397.86	-16.62	397.84	-13.07	398.36	0.00	401.36
37+25.00	398.25	-30.12	397.71	-16.62	397.72	-13.62	398.26	0.00	401.22
37+50.00	398.12	-30.12	397.58	-16.62	397.60	-13.62	398.15	0.00	401.10
37+75.00	398.02	-30.12	397.48	-16.62	397.49	-13.62	398.04	0.00	400.99
38+00.00	397.91	-30.12	397.37	-16.62	397.39	-13.62	397.93	0.00	400.89
38+25.00	397.80	-30.12	397.26	-16.62	397.26	-13.62	397.80	0.00	400.76
38+50.00	397.69	-30.12	397.15	-16.62	397.11	-13.62	397.66	0.00	400.65
38+75.00	397.55	-30.12	397.01	-16.62	396.97	-13.62	397.52	0.00	400.51
39+00.00	397.41	-30.12	396.87	-16.62	396.84	-13.62	397.38	0.00	400.37
39+25.00	397.21	-30.12	396.67	-16.62	396.70	-13.62	397.25	0.00	400.20

*ELEVATIONS AND OFFSETS LOCATED AT EXISTING SIGN FOUNDATION OR PIER TRANSITIONS SHALL BE FIELD VERIFIED PRIOR TO CONSTRUCTION.

I-64 EB Station	W		X		Y		Z		T/WALL
	EL.	O/S	EL.	O/S	EL.	O/S	EL.	O/S	EL.
39+50.00	397.01	-30.12	396.47	-16.62	396.57	-13.62	397.11	0.00	400.07
39+75.00	396.86	-30.12	396.32	-16.62	396.45	-13.62	396.99	0.00	399.95
40+00.00	396.77	-30.12	396.23	-16.62	396.34	-13.62	396.88	0.00	399.84
40+25.00	396.63	-30.14	396.09	-16.64	396.22	-13.64	396.76	0.00	399.72
40+50.00	396.49	-30.21	395.95	-16.71	396.08	-13.71	396.63	0.00	399.58
40+75.00	396.28	-30.34	395.74	-16.84	395.97	-13.84	396.52	0.00	399.47
41+00.00	396.12	-30.51	395.58	-17.01	395.88	-14.01	396.44	0.00	399.38
41+25.00	396.02	-30.74	395.48	-17.24	395.77	-14.24	396.34	0.00	399.27
41+50.00	395.91	-31.02	395.37	-17.46	395.63	-14.46	396.21	0.00	399.13
41+75.00	395.80	-31.36	395.25	-17.54	395.49	-14.54	396.08	0.00	398.99
42+00.00	395.68	-31.74	395.12	-17.66	395.35	-14.66	395.94	0.00	398.85
42+25.00	395.59	-32.18	395.02	-17.83	395.16	-14.83	395.75	0.00	398.66
42+50.00	395.51	-32.61	394.92	-18.01	395.07	-15.01	395.67	0.00	398.57
42+75.00	395.42	-33.05	394.83	-18.19	394.97	-15.19	395.58	0.00	398.47
43+00.00	395.34	-33.48	394.74	-18.63	394.85	-15.63	395.48	0.00	398.35
43+25.00	395.21	-33.92	394.60	-18.54	394.73	-15.54	395.35	0.00	398.23
43+50.00	395.09	-34.36	394.46	-18.72	394.59	-15.72	395.22	0.00	398.09
43+75.00	394.96	-34.79	394.32	-18.89	394.46	-15.89	395.10	0.00	397.96
44+00.00	394.83	-35.23	394.18	-19.07	394.32	-16.07	394.96	0.00	397.82
44+25.00	394.71	-35.67	394.05	-19.25	394.17	-16.25	394.82	0.00	397.67
44+50.00	394.59	-36.10	393.92	-19.42	394.03	-16.42	394.69	0.00	397.53
44+75.00	394.44	-36.54	393.77	-19.60	393.87	-16.60	394.54	0.00	397.37
45+00.00	394.30	-36.98	393.61	-19.84	393.72	-16.84	394.39	0.00	397.22
OMISSION - PED BRIDGE PIER. (SEE ROADWAY DETAIL)									
45+50.00	393.99	-37.85	393.28	-20.13	393.46	-17.13	394.14	0.00	396.96
45+75.00	393.87	-38.27	393.15	-20.29	393.34	-17.29	394.03	0.00	396.84
46+00.00	393.76	-38.64	393.03	-20.40	393.23	-17.40	393.93	0.00	396.73
46+25.00	393.70	-38.95	392.97	-20.50	393.19	-17.50	393.89	0.00	396.69
46+50.00	393.65	-39.22	392.91	-20.68	393.17	-17.68	393.87	0.00	396.67
46+75.00	393.71	-39.43	392.96	-20.80	393.24	-17.80	393.95	0.00	396.74
47+00.00	393.83	-39.59	393.08	-20.87	393.35	-17.87	394.06	0.00	396.85
47+25.00	394.06	-39.70	393.31	-20.89	393.55	-17.89	394.26	0.00	397.05
47+50.00	394.30	-39.75	393.54	-20.86	393.83	-17.86	394.54	0.00	397.33
47+75.00	394.65	-39.78	393.89	-20.79	394.15	-17.79	394.86	0.00	397.65
48+00.00	395.09	-39.80	394.33	-20.73	394.57	-17.73	395.28	0.00	398.07
48+25.00	395.58	-39.83	394.82	-20.66	395.07	-17.66	395.78	0.00	398.57
RAMP 64W55S									
STATION	EL.	O/S	EL.	O/S	EL.	O/S	EL.	O/S	T/WALL EL.
116+75.00	406.62	0.00	406.07	8.91	406.21	11.92	405.66	20.78	409.71
117+00.00	407.55	0.00	407.15	9.71	406.93	12.71	406.54	22.34	410.65
117+25.00	408.46	0.00	408.06	10.00	407.61	13.59	407.41	23.60	411.56
117+50.00	409.35	0.00	408.95	10.00	408.13	14.55	408.13	24.55	412.45

- NOTES:**
- SEE IDOT HIGHWAY STANDARD 637006 FOR CONCRETE BARRIER, DOUBLE FACE, 42" HEIGHT DIMENSIONS. FOR VARIABLE SHOULDER ELEVATIONS MAINTAIN A 36" WIDTH AND ADJUST THE ANGLE OF THE BARRIER FACE ON THE LOW SIDE OF THE SHOULDER.
 - TWO VERTICAL EPOXY COATED, NO. 6 TIE BARS, 12" LONG, SHALL BE PLACED AT EQUIDISTANT SPACING ALONG THE CONCRETE BARRIER TRANSITION. TIE BARS SHALL BE INCLUDED IN THE COST OF CONCRETE BARRIER TRANSITION.
 - HORIZONTAL TIE BARS SHALL BE NO. 6 EPOXY COATED, 24" LONG, 24" C-C AND SHALL BE INCLUDED IN THE COST OF THE BARRIER BASE.