

THOUGH EXISTING SEWERS ARE SHOWN, NO OTHER EXISTING UTILITIES ARE PROVIDED ON THE CROSS SECTIONS. PROPOSED SEWERS ARE BASED ON THE PROPOSED DRAINAGE DESIGN SHOWN WITHIN THESE PLANS. THE CONTRACTOR IS RESPONSIBLE FOR IDENTIFYING ALL EXISTING UTILITIES PRIOR TO CONSTRUCTION. THE CONTRACTOR SHALL REFER TO S.U.E. PLANS FOR EXISTING UTILITY INFORMATION.

DATE	
BY	
FINAL SURVEY	
PLOTTED	
NOTE BOOK	
AREAS CHECKED	

DATE	
BY	
ORIGINAL SURVEY	
PLOTTED	
NOTE BOOK	
AREAS CHECKED	

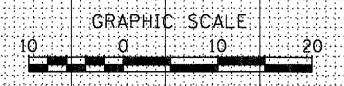
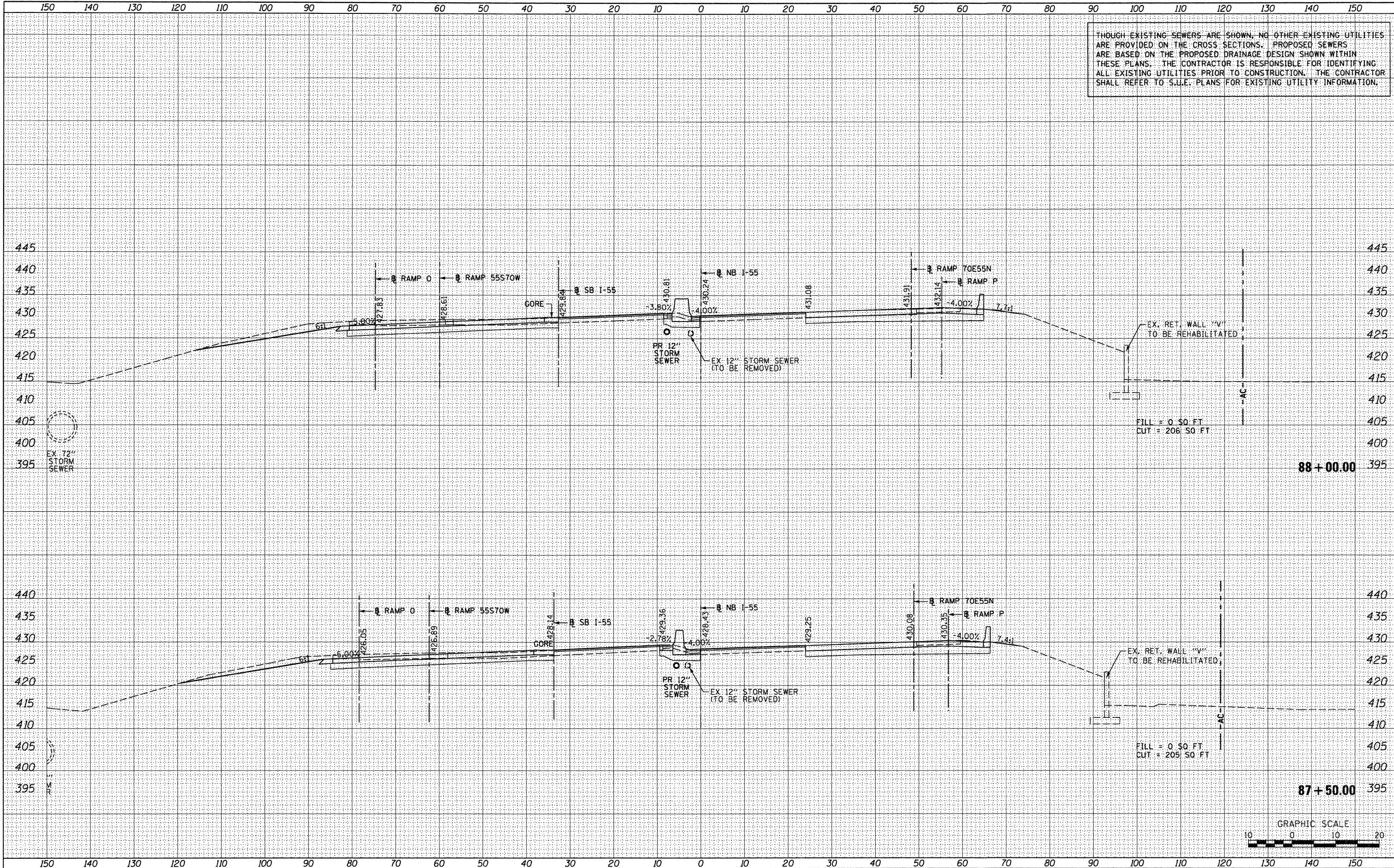

FILE NAME =	USER NAME = sear-sb	DESIGNED - KM	REVISED -	STATE OF ILLINOIS DEPARTMENT OF TRANSPORTATION	CROSS SECTIONS - NB I-55			F.A. RTE.	SECTION	COUNTY	TOTAL SHEETS	SHEET NO.
*FILE#		DRAWN - KM	REVISED -		64/998	82-1-RIA)	ST. CLAIR	629	548			
		CHECKED - DBM	REVISED -		SCALE: 1" = 10' SHEET NO. 21 OF 25 SHEETS STA. 87+50.00 TO STA. 88+00.00			CONTRACT NO. 76C52				
		PLLOT DATE = 1/24/2012	DATE = 1-20-12		ILLINOIS FED. AID PROJECT							