

DATE	
BY	
FINAL SURVEY	SURVEYED
NOTE BOOK	PLOTTED
NO.	TEMPLATE
	AREAS CHECKED

DATE	
BY	
ORIGINAL SURVEY	SURVEYED
NOTE BOOK	PLOTTED
NO.	TEMPLATE
	AREAS CHECKED

THOUGH EXISTING SEWERS ARE SHOWN, NO OTHER EXISTING UTILITIES ARE PROVIDED ON THE CROSS SECTIONS. PROPOSED SEWERS ARE BASED ON THE PROPOSED DRAINAGE DESIGN SHOWN WITHIN THESE PLANS. THE CONTRACTOR IS RESPONSIBLE FOR IDENTIFYING ALL EXISTING UTILITIES PRIOR TO CONSTRUCTION. THE CONTRACTOR SHALL REFER TO S.U.E. PLANS FOR EXISTING UTILITY INFORMATION.

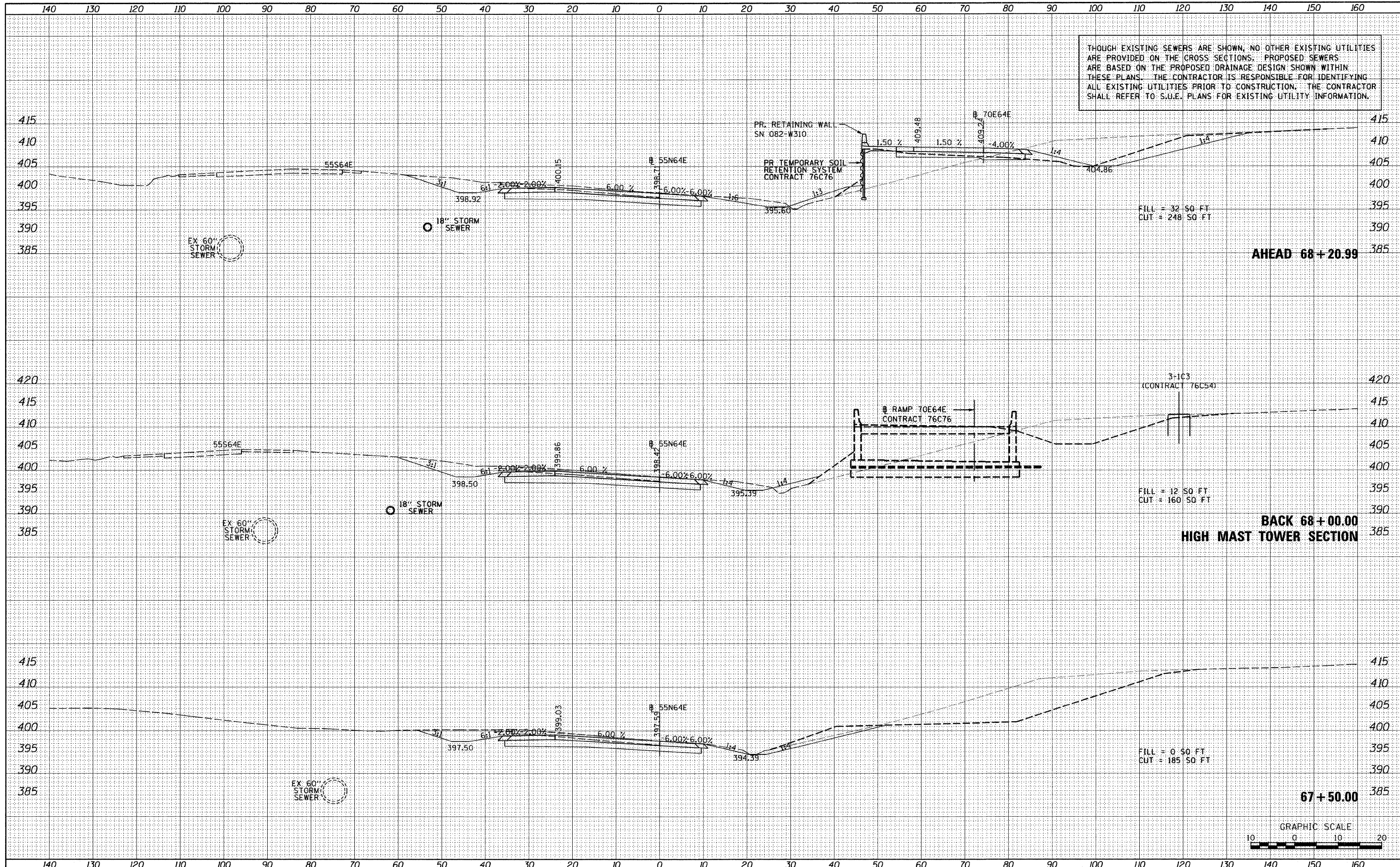

FILE NAME =	USER NAME = searsb	DESIGNED - SDH	REVISED -	<b>STATE OF ILLINOIS</b> <b>DEPARTMENT OF TRANSPORTATION</b>	<b>CROSS SECTIONS - RAMP 55N64E</b>	I.A. RTE. 64/998 SECTION 82-1-RIA COUNTY ST. CLAIR TOTAL SHEETS 629 SHEET NO. 577 CONTRACT NO. 76C52
#FILE#		DRAWN - SDH	REVISED -			
PLOT SCALE = 20.0000' / 1"		CHECKED - DBM	REVISED -			
PLOT DATE = 3/1/2012		DATE - 03-01-12	REVISED -			
				SCALE: 1" = 10'		SHEET NO. 6 OF 10 SHEETS
						STA. 67+50.00 TO STA. 68+20.99
						ILLINOIS FED. AID PROJECT