

THOUGH EXISTING SEWERS ARE SHOWN, NO OTHER EXISTING UTILITIES ARE PROVIDED ON THE CROSS SECTIONS. PROPOSED SEWERS ARE BASED ON THE PROPOSED DRAINAGE DESIGN SHOWN WITHIN THESE PLANS. THE CONTRACTOR IS RESPONSIBLE FOR IDENTIFYING ALL EXISTING UTILITIES PRIOR TO CONSTRUCTION. THE CONTRACTOR SHALL REFER TO S.U.E. PLANS FOR EXISTING UTILITY INFORMATION.

DATE	
BY	
FINAL SURVEY	
PLOTTED	
TEMPLATE	
NOTE BOOK	
AREAS CHECKED	
NO.	

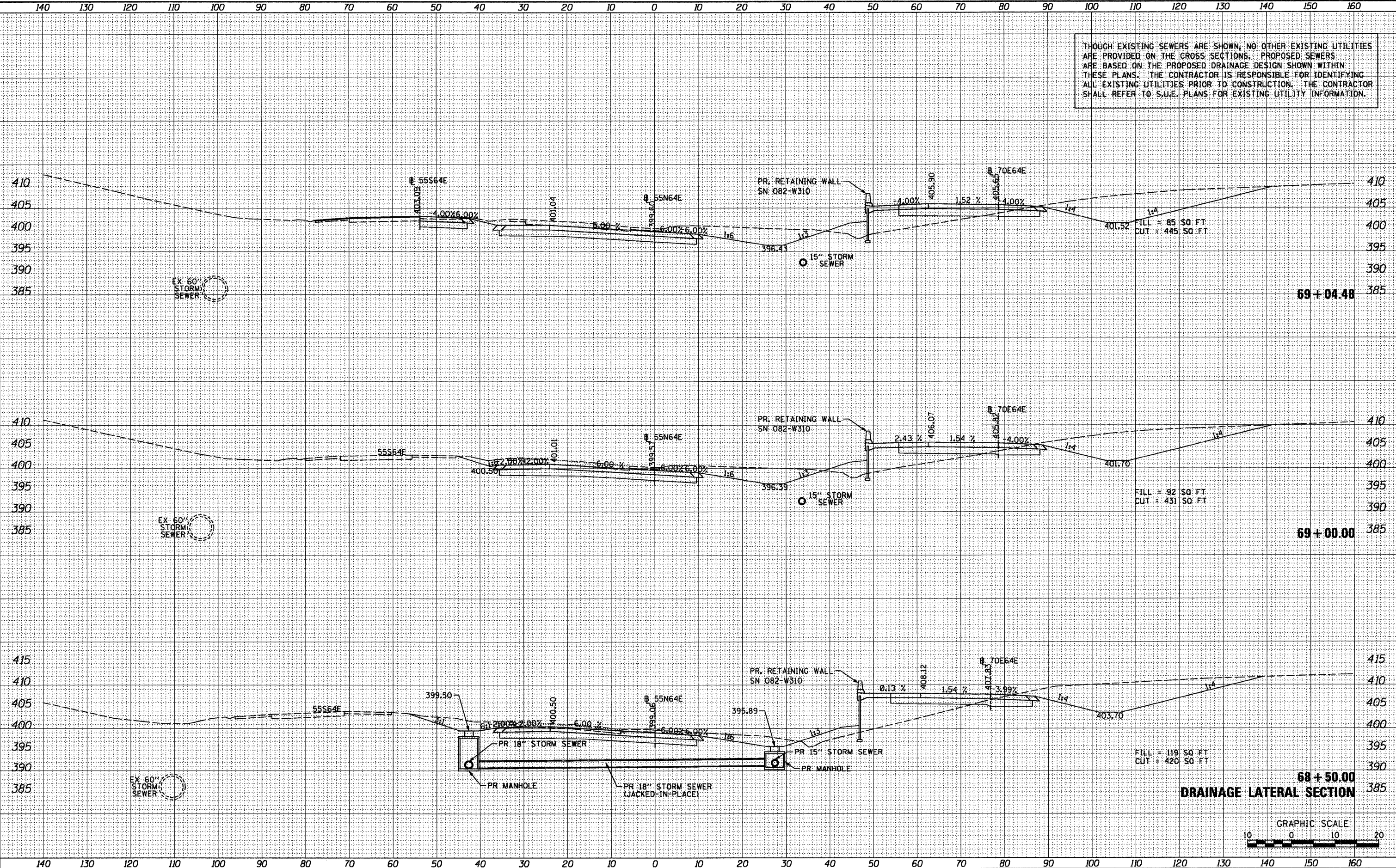

DATE	
BY	
ORIGINAL SURVEY	
PLOTTED	
TEMPLATE	
NOTE BOOK	
AREAS CHECKED	
NO.	

68 + 50.00
DRAINAGE LATERAL SECTION

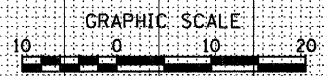

FILE NAME =	USER NAME = searab	DESIGNED - SDH	REVISED -	STATE OF ILLINOIS DEPARTMENT OF TRANSPORTATION	CROSS SECTIONS - RAMP 55N64E		F.A. RTE. 64/998	SECTION 82-1-RIA)	COUNTY ST. CLAIR	TOTAL SHEETS 629	SHEET NO. 578	
#FILE#	PLOT SCALE = 28.0000' / in.	DRAWN - SDH	REVISED -		SCALE: 1" = 10'	SHEET NO. 7 OF 10 SHEETS	STA. 68+50.00 TO STA. 69+04.48	CONTRACT NO. 76C52		ILLINOIS FED. AID PROJECT		
	PLOT DATE = 1/25/2012	CHECKED - DBM	REVISED -									
		DATE - 1-20-12	REVISED -									