

THOUGH EXISTING SEWERS ARE SHOWN, NO OTHER EXISTING UTILITIES ARE PROVIDED ON THE CROSS SECTIONS. PROPOSED SEWERS ARE BASED ON THE PROPOSED DRAINAGE DESIGN SHOWN WITHIN THESE PLANS. THE CONTRACTOR IS RESPONSIBLE FOR IDENTIFYING ALL EXISTING UTILITIES PRIOR TO CONSTRUCTION. THE CONTRACTOR SHALL REFER TO S.U.E. PLANS FOR EXISTING UTILITY INFORMATION.

DATE: _____
 BY: _____
 SURVEYED: _____
 PLOTTED: _____
 NOTE BOOK: _____
 AREAS CHECKED: _____
 NO.: _____

DATE: _____
 BY: _____
 SURVEYED: _____
 PLOTTED: _____
 NOTE BOOK: _____
 AREAS CHECKED: _____
 NO.: _____

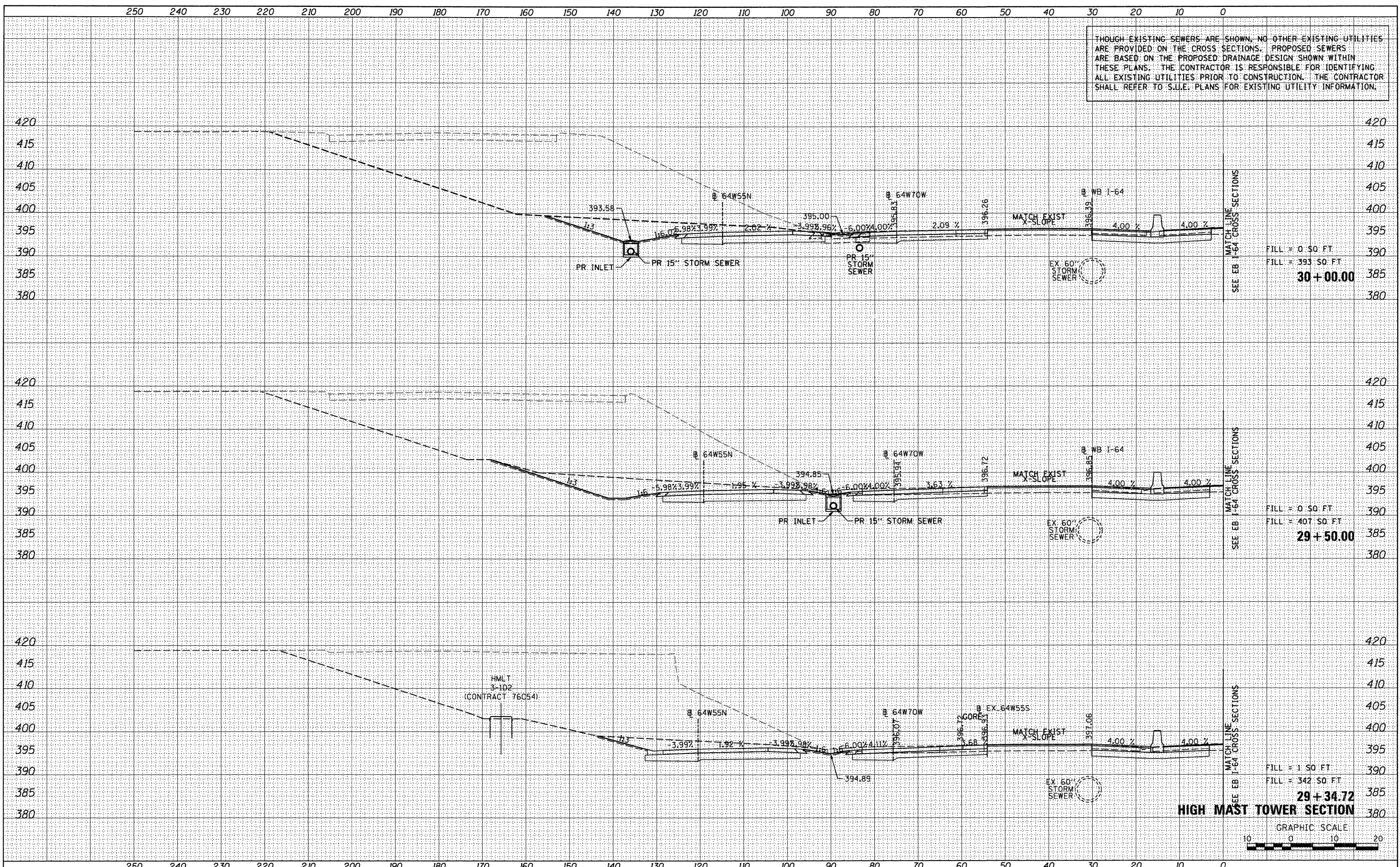

HIGH MAST TOWER SECTION

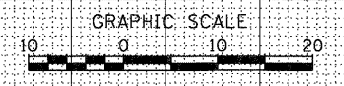

FILE NAME = #FILEL*	USER NAME = sear-st	DESIGNED - SDH	REVISED -	STATE OF ILLINOIS DEPARTMENT OF TRANSPORTATION	CROSS SECTIONS - WB I-64			F.A. RTE. 64/998	SECTION 82-1-RIA)	COUNTY ST. CLAIR	TOTAL SHEETS 629	SHEET NO. 589	
	PLOT SCALE = 20.0000' / in.	CHECKED - DBM	REVISED -		SCALE: 1" = 10'	SHEET NO. 4 OF 5 SHEETS	STA. 29+34.72 TO STA. 30+00.00	CONTRACT NO. 76C52		ILLINOIS FED. AID PROJECT			
	PLOT DATE = 1/24/2012	DATE - 1-20-12	REVISED -										