

THOUGH EXISTING SEWERS ARE SHOWN, NO OTHER EXISTING UTILITIES ARE PROVIDED ON THE CROSS SECTIONS. PROPOSED SEWERS ARE BASED ON THE PROPOSED DRAINAGE DESIGN SHOWN WITHIN THESE PLANS. THE CONTRACTOR IS RESPONSIBLE FOR IDENTIFYING ALL EXISTING UTILITIES PRIOR TO CONSTRUCTION. THE CONTRACTOR SHALL REFER TO S.U.E. PLANS FOR EXISTING UTILITY INFORMATION.

BY	DATE
SURVEYED	
PLOTTED	
NOTE BOOK	
AREAS	
CHECKED	
NO.	

BY	DATE
ORIGINAL SURVEY	
PLOTTED	
NOTE BOOK	
AREAS	
CHECKED	
NO.	

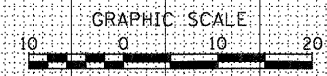
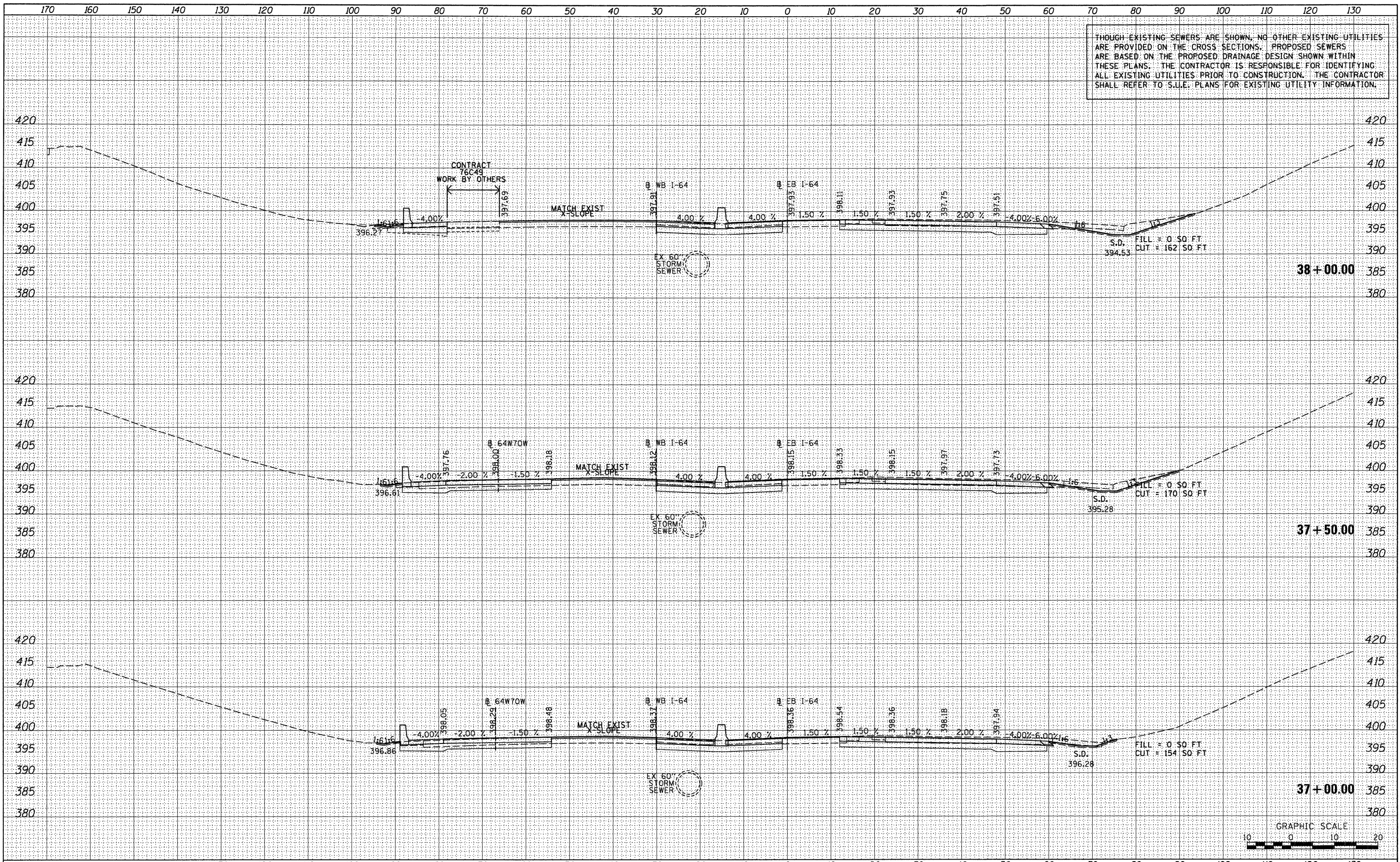

FILE NAME =	USER NAME = searab	DESIGNED - SDH	REVISED -	<b>STATE OF ILLINOIS DEPARTMENT OF TRANSPORTATION</b>	<b>CROSS SECTIONS - I-64</b>		F.A. RTE. 64/998	SECTION 82-1-RIA)	COUNTY ST. CLAIR	TOTAL SHEETS 629	SHEET NO. 603	
#FILEL#		DRAWN - SDH	REVISED -		SCALE: 1" = 10'	SHEET NO. 8 OF 25 SHEETS	STA. 37+00.00 TO STA. 38+00.00	CONTRACT NO. 76C52		ILLINOIS FED. AID PROJECT		
		CHECKED - DBM	REVISED -									
		DATE - 1-20-12	REVISED -									