

ALTHOUGH EXISTING SEWERS ARE SHOWN, NO OTHER EXISTING UTILITIES ARE PROVIDED ON THE CROSS SECTIONS. PROPOSED SEWERS ARE BASED ON THE PROPOSED DRAINAGE DESIGN SHOWN WITHIN THESE PLANS. THE CONTRACTOR IS RESPONSIBLE FOR IDENTIFYING ALL EXISTING UTILITIES PRIOR TO CONSTRUCTION. THE CONTRACTOR SHALL REFER TO S.U.E. PLANS FOR EXISTING UTILITY INFORMATION.

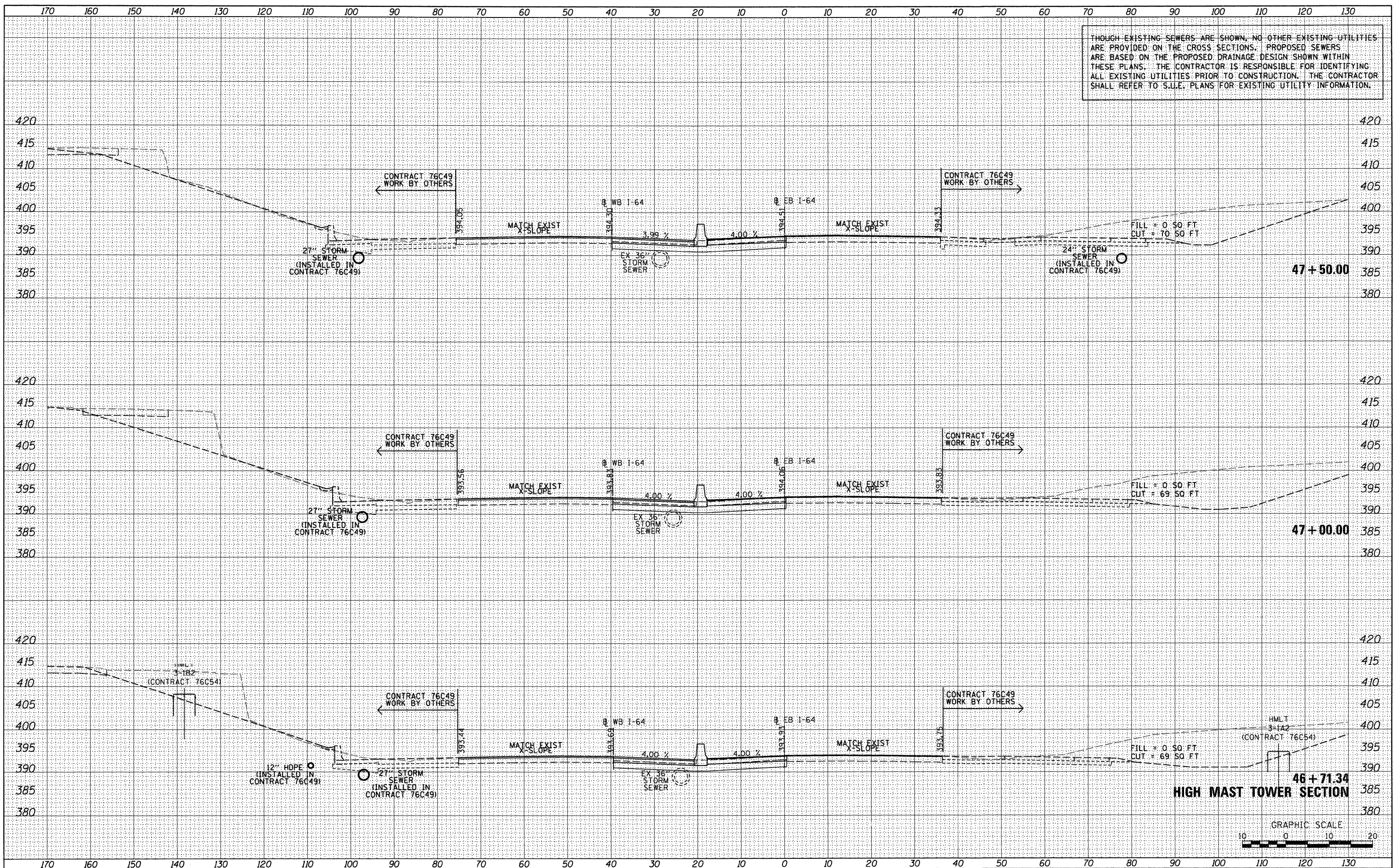

DATE _____
 BY _____
 SURVEYED _____
 PLOTTED _____
 ORIGINAL SURVEY _____
 NOTE BOOK _____
 NO. _____

DATE _____
 BY _____
 SURVEYED _____
 PLOTTED _____
 ORIGINAL SURVEY _____
 NOTE BOOK _____
 NO. _____

| | | | | | | | | |
|-------------|---------------------------|----------------|-----------|--|------------------|------------------|------------------|---------------|
| FILE NAME = | USER NAME = sear-sb | DESIGNED - SDH | REVISED - | F.A. RTE. 64/998 | SECTION 82-1-RIA | COUNTY ST. CLAIR | TOTAL SHEETS 629 | SHEET NO. 611 |
| *FILEL* | PLT SCALE = 20.0000' / 1" | DRAWN - SDH | REVISED - | CROSS SECTIONS - I-64 | | | | |
| | PLT DATE = 1/24/2012 | CHECKED - DBM | REVISED - | SCALE: 1" = 10' SHEET NO. 16 OF 25 SHEETS STA. 46+71.34 TO STA. 47+50.00 | | | | |
| | | DATE - 1-20-12 | REVISED - | ILLINOIS FED. AID PROJECT | | | | |

STATE OF ILLINOIS
 DEPARTMENT OF TRANSPORTATION

46 + 71.34
 HIGH MAST TOWER SECTION

