

ALTHOUGH EXISTING SEWERS ARE SHOWN, NO OTHER EXISTING UTILITIES ARE PROVIDED ON THE CROSS SECTIONS. PROPOSED SEWERS ARE BASED ON THE PROPOSED DRAINAGE DESIGN SHOWN WITHIN THESE PLANS. THE CONTRACTOR IS RESPONSIBLE FOR IDENTIFYING ALL EXISTING UTILITIES PRIOR TO CONSTRUCTION. THE CONTRACTOR SHALL REFER TO S.U.E. PLANS FOR EXISTING UTILITY INFORMATION.

BY	DATE
SURVEYED	
PLOTTED	
NOTE BOOK	
AREAS	
CHECKED	

BY	DATE
SURVEYED	
PLOTTED	
NOTE BOOK	
AREAS	
CHECKED	

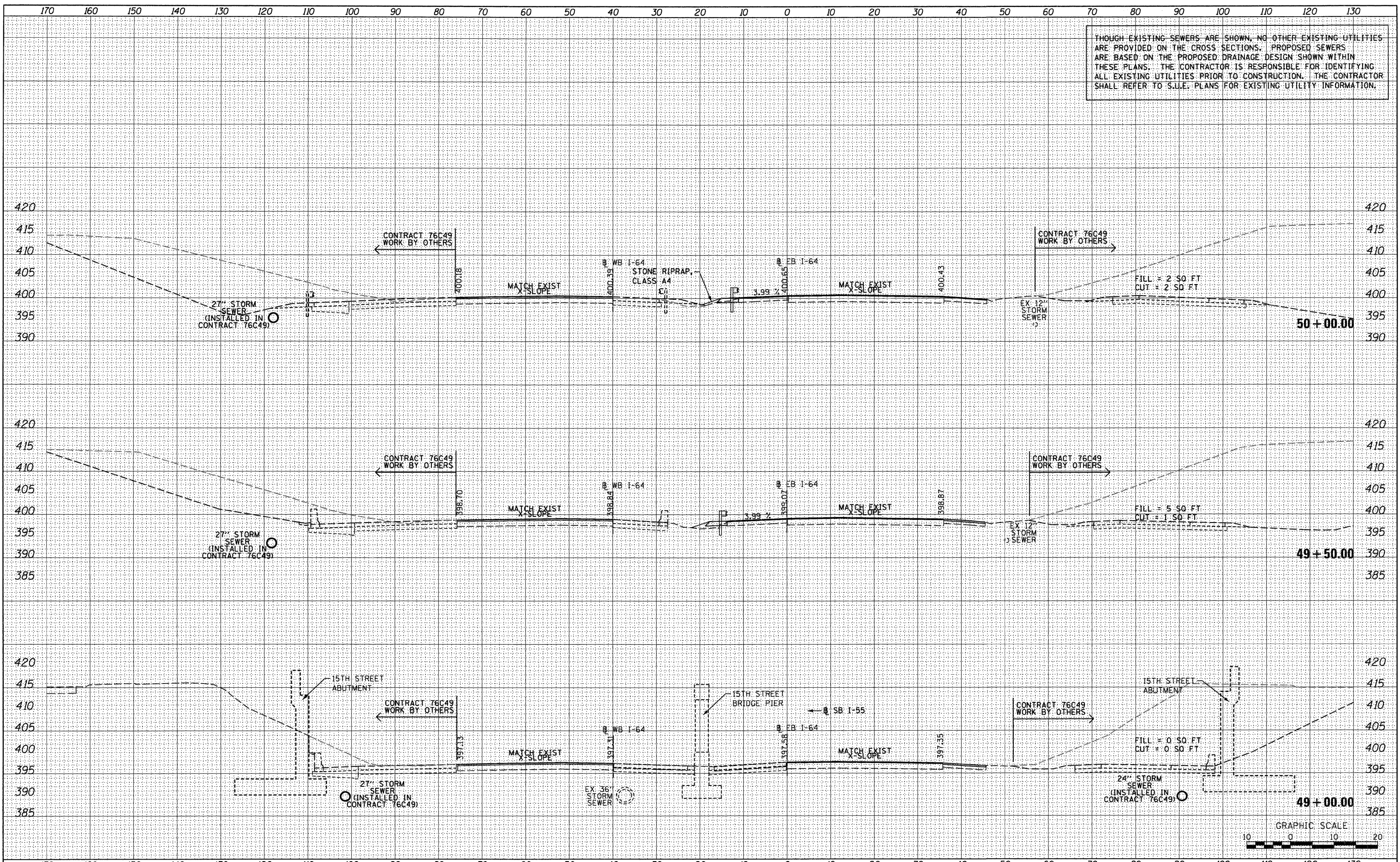

FILE NAME =  
#FILEL\*

USER NAME = searob	DESIGNED - SDH	REVISED -
PLOT SCALE = 20.0000' / in.	DRAWN - SDH	REVISED -
PLOT DATE = 1/24/2012	CHECKED - DBM	REVISED -
	DATE - 1-20-12	REVISED -

**STATE OF ILLINOIS  
DEPARTMENT OF TRANSPORTATION**

**CROSS SECTIONS - I-64**  
SCALE: 1" = 10'  
SHEET NO. 18 OF 25 SHEETS  
STA. 49+00.00 TO STA. 50+00.00

F.A. RTE. 64/998	SECTION 82-1-RIA)	COUNTY ST. CLAIR	TOTAL SHEETS 629	SHEET NO. 613
				CONTRACT NO. 76C52
ILLINOIS FED. AID PROJECT				