

EXISTING TYPICAL SECTION

STA. 929+00.00 TO STA. 931+20.68*
 STA. 933+08.53 TO STA. 935+50.00*

*BRIDGE APPROACH PAVEMENT
 STA. 931+00.68 TO STA. 931+20.68
 STA. 933+08.53 TO STA. 933+28.53

LEGEND

- ① EXISTING PAVEMENT (9-6-9)
- ② EXISTING HOT-MIX ASPHALT BINDER, 1 1/2"
- ③ EXISTING HOT-MIX ASPHALT SURFACE COURSE, 1 1/2"
- ④ EXISTING HOT-MIX ASPHALT BASE COURSE WIDENING, 8"
- ⑤ EXISTING STABILIZED SHOULDERS, 8"
- ⑥ EXISTING AGGREGATE SHOULDER, TY A
- ⑦ PROPOSED HOT-MIX ASPHALT WIDENING, 10"
- ⑧ PROPOSED BITUMINOUS MATERIAL (PRIME COAT)
- ⑨ PROPOSED AGGREGATE (PRIME COAT)
- ⑩ PROPOSED HOT-MIX ASPHALT SURFACE COURSE, 2"*

*OVER THE BRIDGE
 1 1/2" HOT-MIX ASPHALT
 1/2" WATERPROOFING

MILLING JOINT DETAIL
 DRAWING NOT TO SCALE

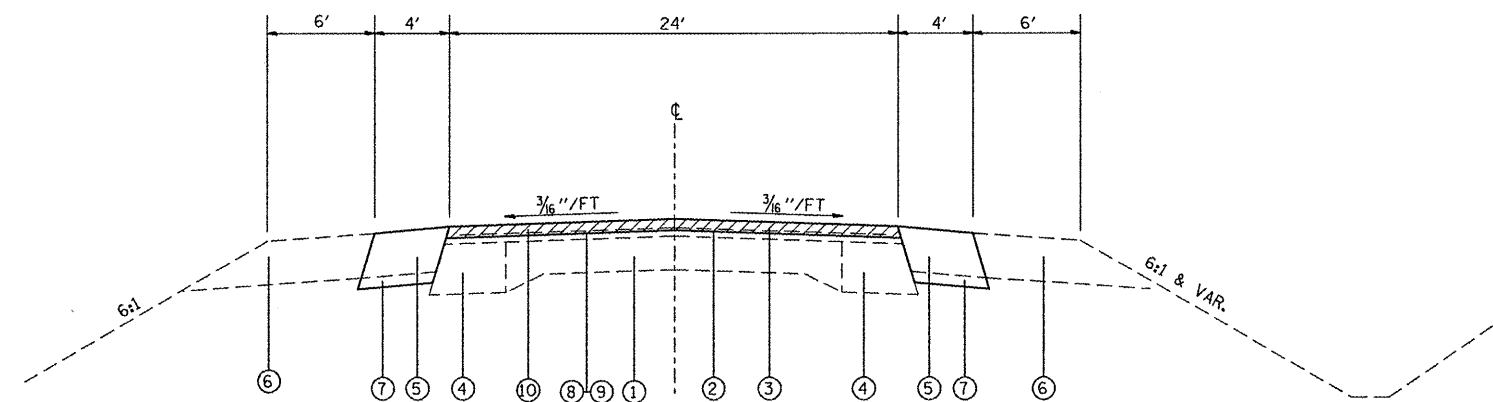

EXISTING TYPICAL SECTION

STA. 930+90.68 TO STA. 933+38.53

HMA SURFACE REMOVAL, 2"

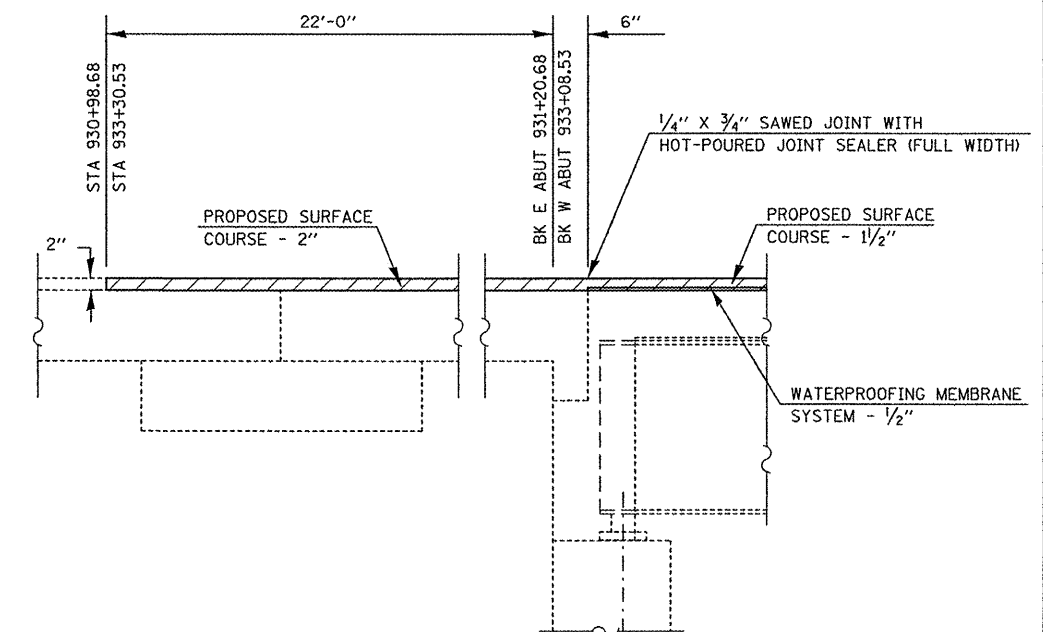

NOTE: SAW CUT IS INCLUDED IN THE MILLING

FILE NAME =	USER NAME = gelnh	DESIGNED -	REVISED -
c:\pwork\puidot\gelnh\d0266267\0876F7-st-plan.dgn		DRAWN -	REVISED -
PLOT SCALE = 100.0000' / in.		CHECKED -	REVISED -
PLOT DATE = 2/7/2012		DATE -	REVISED -

STATE OF ILLINOIS
DEPARTMENT OF TRANSPORTATION

TYPICAL SECTIONS
MILLING DETAILS

SCALE: _____ SHEET NO. ____ OF ____ SHEETS STA. _____ TO STA. _____

F.A.P. RTE.	SECTION	COUNTY	TOTAL SHEETS	SHEET NO.
861	110BR-1	RANDOLPH	14	5
FED. ROAD DIST. NO. - ILLINOIS FED. AID PROJECT			CONTRACT NO. 76F07	