

Existing Structure: Built 1927 with a truss center span, concrete T girder side spans, spill-thru abutments, and solid piers.

In 1977 the substructure was widened with a new plate girder center span, WF side spans. The abutments were made integral, with joints at the piers.

The pier joints, HMA overlay, & waterproofing shall be replaced.

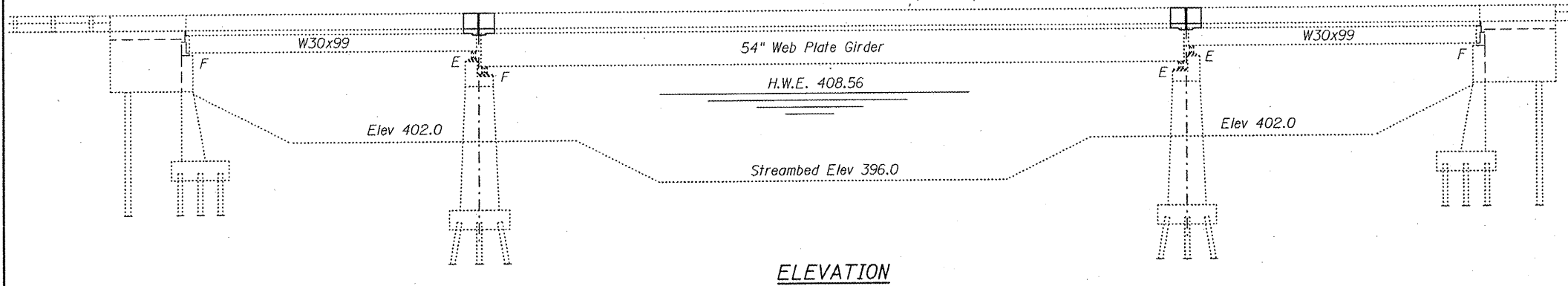

ELEVATION

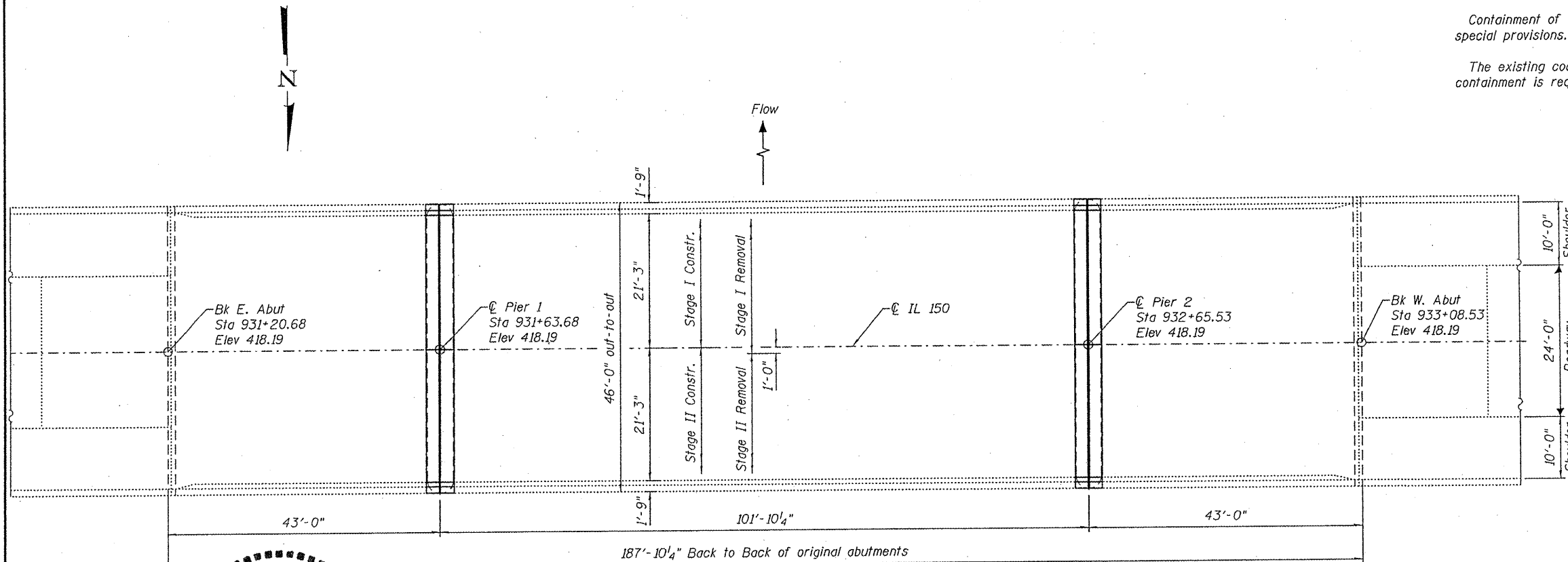

PLAN

GENERAL NOTES

Reinforcement bars designated (E) shall be epoxy coated.

Plan dimensions and details relative to existing plans are subject to nominal construction variations. The Contractor shall field verify existing dimensions and details affecting new construction and make necessary approved adjustments prior to construction or ordering of materials. Such variations shall not be cause for additional compensation for a change in scope of the work, however, the Contractor will be paid for the quantity actually furnished at the unit price bid for the work.

Existing reinforcement bars extending into the removal area shall be cleaned, straightened, and incorporated into the new construction. Any reinforcement bars that are damaged during concrete removal shall be replaced with an approved bar splicer or anchorage system. Cost included with Concrete Removal.

The deck surface shall have its final finish tined according to Article 420.09(e)(1) of the Standard Specifications. Cost included with "Concrete Superstructure".

Cleaning and Painting of the existing structural steel and bearings shall be as specified in the Special Provision for "Cleaning and Painting Existing Steel Surfaces". All beams, bearings, deck drains and other structural steel within 5 feet (measured along the beam) of either side of the deck joints shall be cleaned per Near White Blast Cleaning-SSPC-SP10.

The designated areas cleaned per near white blast cleaning SSPC-SP10 shall be painted according to the requirements of paint system 1- OZ/E/U. The color of the final finish coat for all cleaned surfaces shall match the existing steel.

Containment of cleaning residue is required to control nuisance dust. See special provisions.

The existing coating does not contain lead. By specification, a Class 2A containment is required to contain nuisance dust from escaping into the environment.

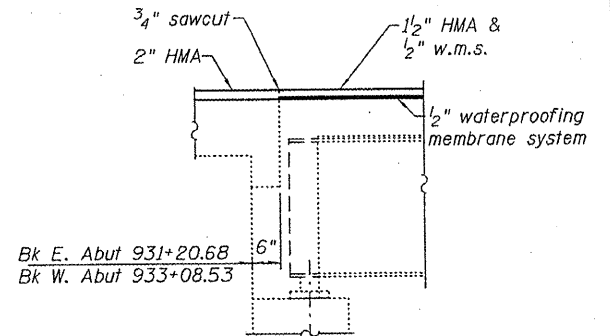

ABUTMENT SECTION

TOTAL BILL OF MATERIAL

ITEM	UNIT	TOTAL
HMA Surface Removal, 2"	Sq. Yd.	881
HMA Surface Course, Mix "D", N90	Ton	72
Concrete Removal	Cu. Yd.	14.0
Concrete Superstructure	Cu. Yd.	15.5
Protective Coat	Sq. Yd.	191
Reinforcement Bars, Epoxy Coated	Pound	2400
Bar Splicers	Each	32
Preformed Joint Strip Seal	Foot	89.0
Waterproofing Membrane System	Sq. Yd.	852
Containment and Disposal of Non-Lead Paint Cleaning Residues No. 1	L. Sum	1
Cleaning and Painting Steel Bridge No. 1	L. Sum	1

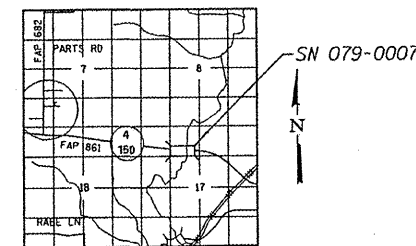

LOCATION SKETCH

DAVID CARL PUZEY
 LICENSED STRUCTURAL ENGINEER
 081-005470
 SPRINGFIELD ILLINOIS
 State of Illinois
 Expires 11/30/12

DESIGNED - J. Uehle	EXAMINED - <i>John F. [Signature]</i>	DATE - 3/15/12
CHECKED - B. Williams	PASSED - <i>John F. [Signature]</i>	REVISOR
DRAWN - J. Uehle	ENGINEER OF BRIDGES AND STRUCTURES	REVISOR
CHECKED - B. Williams		

STATE OF ILLINOIS
 DEPARTMENT OF TRANSPORTATION
 GENERAL PLAN AND ELEVATION
 SN 079-0007
 SHEET NO. 1 OF 8 SHEETS

F.A.P. RTE. 861	SECTION 110BR-1	COUNTY Randolph	TOTAL SHEETS 14	SHEET NO. 7
CONTRACT NO. 76F07			ILLINOIS FED. AID PROJECT	