







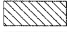
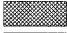

F.A.U. R.T.E.	SECTION	COUNTY	TOTAL SHEETS	SHEET NO.
6160	10-00090-00-WR	LASALLE	61	13
STA. 0+11.71		TO STA. 52+77.14		
FED. ROAD DIST. NO. 3		ILLINOIS	FED. AID PROJECT	

LEGEND

-  = PAVEMENT REMOVAL
-  = DRIVEWAY PAVEMENT REMOVAL
-  = BIT. SURFACE REMOVAL 1-1/2"
-  = SIDEWALK REMOVAL
-  = EARTH EXCAVATION (WIDENING)
-  = CURB REMOVAL
-  = TREE REMOVAL
-  = PLUG EXISTING PIPE
-  = REMOVE EXISTING INLET / MANHOLE

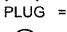

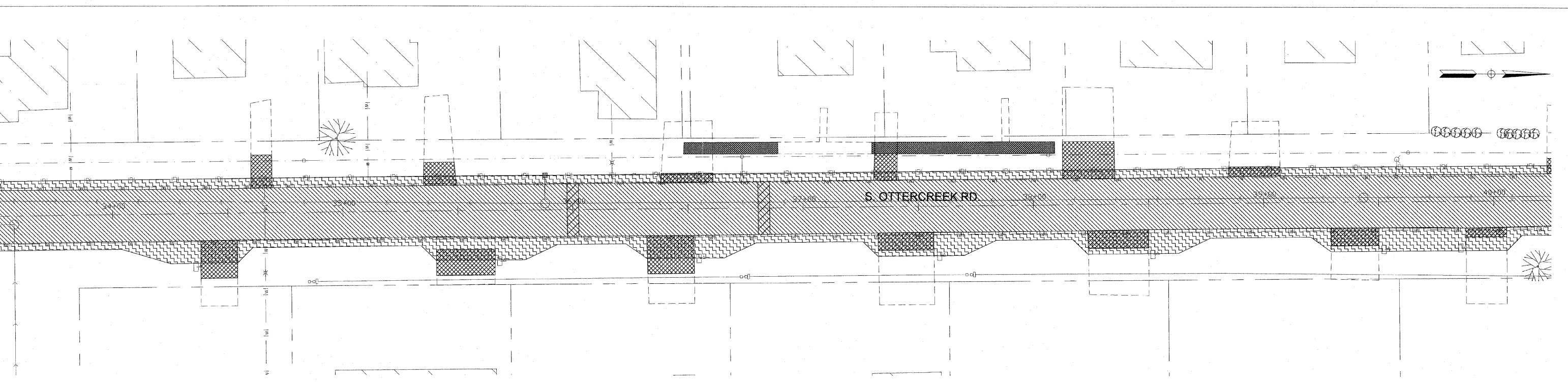
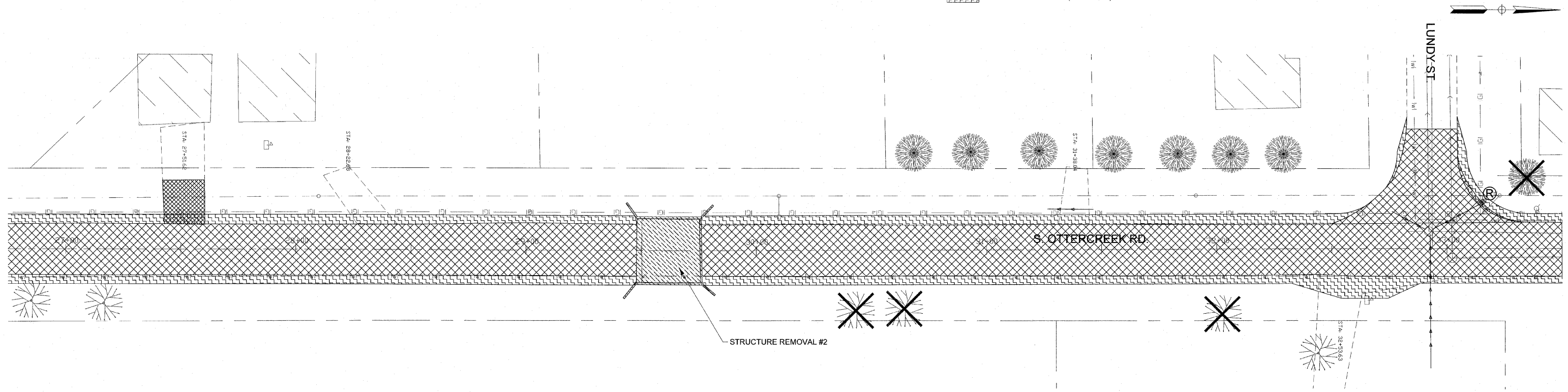
FINAL

SCALE: 1" = 20'

DESIGNED - JEP	REVISED - 11/29/2011
DRAWN - JCL	REVISED -
CHECKED - JEP	REVISED -
DATE - 12/01/2008	REVISED -

STATE OF ILLINOIS
DEPARTMENT OF TRANSPORTATION

Removal Plan - (Sta: 26+75 to Sta: 40+25)