

STATE OF ILLINOIS  
DEPARTMENT OF TRANSPORTATION  
DIVISION OF HIGHWAYS

**PROPOSED  
LOCAL AGENCY IMPROVEMENT**

SAFE ROUTES TO SCHOOLS PROGRAM  
CITY OF PLANO  
VARIOUS LOCATIONS  
SECTION 10-00038-00-SW  
PROJECT NO.: SRTS-4009(103)  
JOB NO.: C40-061-09  
INSTALL SIDEWALKS AND  
SCHOOL ZONE FLASHING BEACONS

P. A. U. NO.	SECTION	COUNTY	TOTAL SHEETS	SHEET NO.
VAR	10-00038-00-SW	KENDALL	12	1
STA.	TO STA.			
FED. ROAD DIST. NO. 3	ILLINOIS	FED. AID PROJECT	SRTS-4009(103)	

CONTRACT #87456

**INDEX OF SHEETS**

1. COVER SHEET
2. SUMMARY OF QUANTITIES
- 3-4. SCHEDULE OF QUANTITIES
5. GENERAL NOTES AND DETAILS
6. CENTER STREET PLANS
7. SWEETBRIAR PLACE PLANS
8. NORTH STREET PLANS
- 9-10. SOUTH STREET PLANS
11. ROCK STREET PLANS
12. SCHOOL STREET & MITCHELL DRIVE PLANS

**HIGHWAY STANDARDS**

- |           |   |
|-----------|---|
| 000001-06 | STANDARD SYMBOLS, ABBREVIATIONS, AND PATTERNS                 |
| 001001-02 | AREAS OF REINFORCEMENT BARS                                   |
| 424001-06 | PERPENDICULAR CURB RAMPS FOR SIDEWALKS                        |
| 424006    | DIAGONAL CURB RAMPS FOR SIDEWALKS                             |
| 424011    | CORNER PARALLEL CURB RAMPS FOR SIDEWALKS                      |
| 424016    | MID-BLOCK CURB RAMPS FOR SIDEWALKS                            |
| 424021    | DEPRESSED CORNER FOR SIDEWALKS                                |
| 424026    | ENTRANCE / ALLEY PEDESTRIAN CROSSING                          |
| 424031    | MEDIAN PEDESTRIAN CROSSING                                    |
| 606001-04 | CONC. CURB TYPE B AND COMBINATION CONC. CURB AND GUTTER       |
| 701006-03 | OFF-ROAD OPERATIONS, 2L, 2W, 15' TO 24" FROM PAVEMENT EDGE    |
| 701301-04 | LANE CLOSURE, 2L, 2W, SHORT TIME OPERATIONS                   |
| 701501-06 | URBAN LANE CLOSURE, 2L, 2W, UNDIVIDED                         |
| 701801-05 | LANE CLOSURE MULTILANE 1W OR 2W CROSSWALK OR SIDEWALK CLOSURE |
| 701901-02 | TRAFFIC CONTROL DEVICES                                       |

**DESIGN GUIDELINES**

BUREAU OF LOCAL ROADS AND STREETS MANUAL

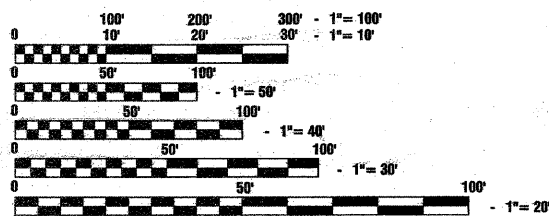

FULL SIZE PLANS HAVE BEEN PREPARED USING STANDARD ENGINEERING SCALES, REDUCED SIZED PLANS WILL NOT CONFORM TO STANDARD SCALES, IN MAKING MEASUREMENTS ON REDUCED PLANS, THE ABOVE SCALES MAY BE USED.

J.U.L.I.E.  
JOINT UTILITY LOCATION INFORMATION FOR EXCAVATION  
1-800-892-0123 or 811

SWEETBRIAR PL.  
SHEET 7  
BEGIN STA 18+09  
END STA 30+33

CENTER STREET  
SHEET 6  
BEGIN STA 6+09  
END STA 13+86  
W/ 2 FLASHING BEACONS  
AT STA 8+63 & 8+80

NORTH STREET  
SHEET 8  
BEGIN STA 34+88  
END STA 43+77

SOUTH STREET  
SHEET 9 & 10  
BEGIN STA 56+79  
END STA 78+03

ROCK STREET  
SHEET 11  
BEGIN STA 107+55  
END STA 116+84

SHEET 12  
SCHOOL STREET at  
BEN ST. INTERSECTION  
W/ 2 FLASHING BEACONS  
STA 83+68 & 84+12

SHEET 12  
SCHOOL STREET at  
WEST ST. INTERSECTION  
W/ 3 FLASHING BEACONS  
STA 92+55, 92+77, 93+13

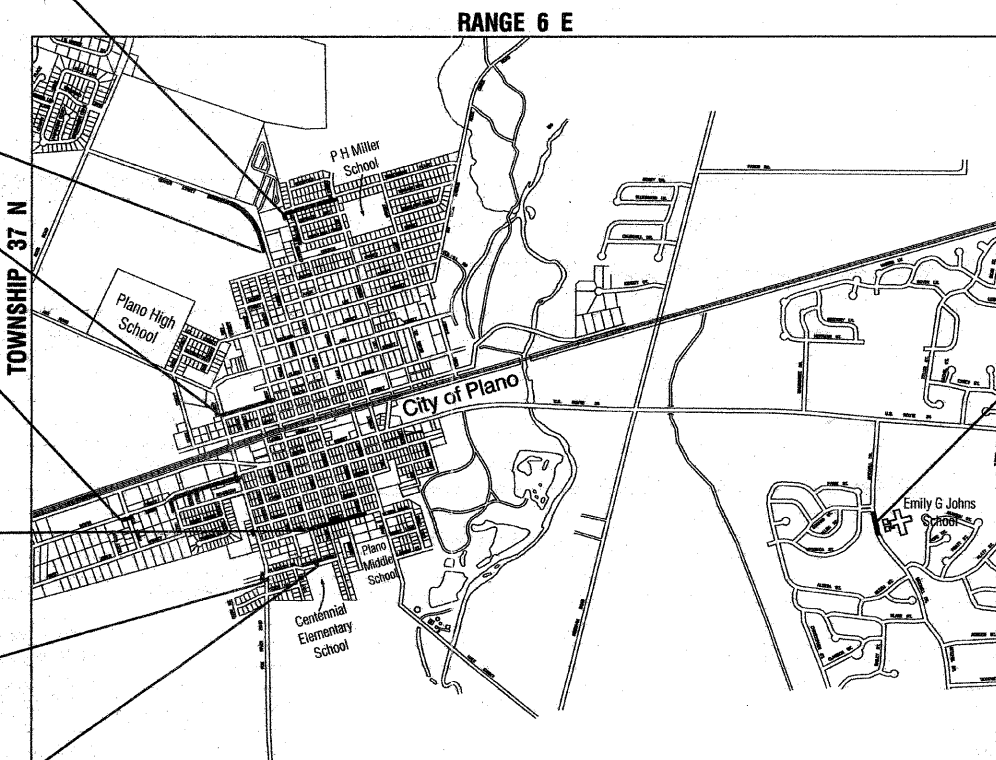

**LOCATION MAP**

- INDICATES PROPOSED IMPROVEMENT  
GROSS LENGTH=6,058 FEET=1.147 MILES  
NET LENGTH=6,058 FEET=1.147 MILES



MITCHELL DRIVE  
SHEET 12  
BY EMILY G. JOHNS SCHOOL  
W/ 2 FLASHING BEACONS  
STA 102+25 & STA 102+50

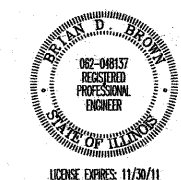

PREPARED BY OR UNDER THE DIRECT SUPERVISION OF:

*Bryan D. Brown*  
DATED THIS 17th DAY OF AUGUST, 2011

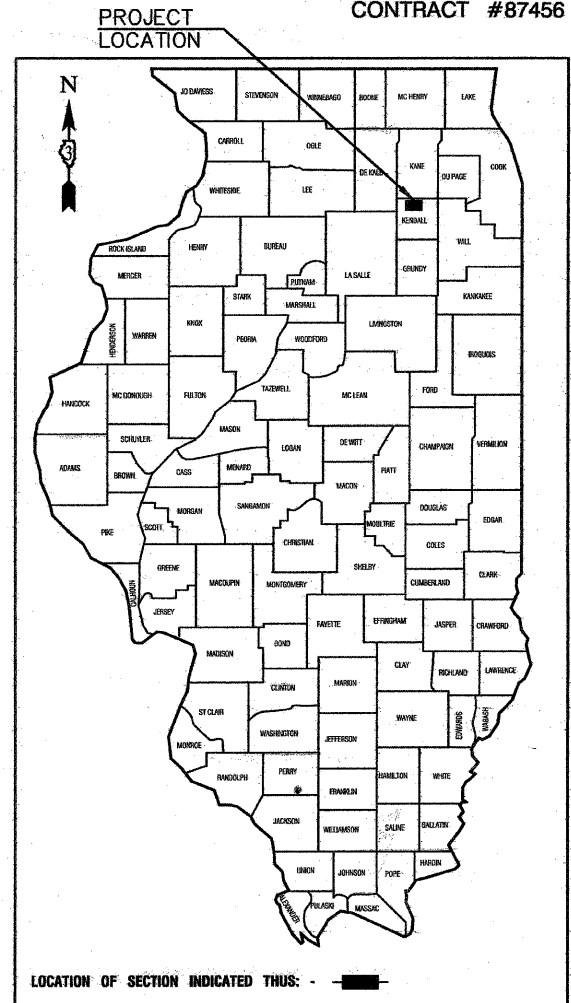

STATE OF ILLINOIS  
DEPARTMENT OF TRANSPORTATION  
DIVISION OF HIGHWAYS

SUBMITTED February 22, 2012

*John P. MacDevine*  
CITY ENGINEER

PASSED 02-27-2012

*Jim J...*  
DISTRICT 3 IMPLEMENTATION ENGINEER

RELEASING FOR BID BASED ON LIMITED REVIEW 02-27-2012

*...*  
DEPUTY DIRECTOR OF HIGHWAYS, REGION 2 ENGINEER

**PRINTED BY THE AUTHORITY  
OF THE STATE OF ILLINOIS**

I.D.O.T. FEDERAL AID DESIGN ENGINEER:  
CONSULTANTS: ROBINSON ENGINEERING, LTD. 708-331-6700 10286-COV-R01-COVER

**CONTRACT NO. 87456**

SUMMARY OF QUANTITIES					CONSTRUCTION TYPE CODE	
S.I.	S.P.	CODE NO.	PAY ITEM	UNIT	QUAN	0021
		20100110	TREE REMOVAL (6 TO 15 UNITS DIAMETER)	UNIT	20	20
		20800150	TRENCH BACKFILL	CU YD	2	2
		42400100	PORTLAND CEMENT CONCRETE SIDEWALK 4 INCH	SQ FT	24781	24781
		42400300	PORTLAND CEMENT CONCRETE SIDEWALK 6 INCH	SQ FT	1599	1599
		42400800	DETECTABLE WARNINGS	SQ FT	488	488
		44000200	DRIVEWAY PAVEMENT REMOVAL	SQ YD	419	419
		44000300	CURB REMOVAL	FOOT	646	646
		44000600	SIDEWALK REMOVAL	SQ FT	8145	7958
		54213657	PRECAST REINFORCED CONCRETE FLARED END SECTIONS 12"	EACH	2	2
		542A0217	PIPE CULVERTS, CLASS A, TYPE 1 12"	FOOT	14	14
		60603800	COMBINATION CONCRETE CURB AND GUTTER, TYPE B-6.12	FOOT	653	653
		67100100	MOBILIZATION	L SUM	1	1
		72000100	SIGN PANEL - TYPE 1	SQ FT	99	99
△		78001130	PAINT PAVEMENT MARKING - LINE 6"	FOOT	1917	1466
△		78001150	PAINT PAVEMENT MARKING - LINE 12"	FOOT	388	388
△		78001180	PAINT PAVEMENT MARKING - LINE 24"	FOOT	226	226
△	*	X0326899	SOLAR-POWERED FLASHING BEACON ASSEMBLY (COMPLETE)	EACH	9	9
	*	X2020410	EARTH EXCAVATION (SPECIAL)	CU YD	532	529
	*	X7010216	TRAFFIC CONTROL AND PROTECTION (SPECIAL)	L SUM	1	1
	*	XX006425	RESTORATION	SQ YD	1718	1713
	*	Z0004510	HOT-MIX ASPHALT DRIVEWAY PAVEMENT, 3"	SQ YD	210	210
	*	Z0077700	WOOD FENCE TO BE REMOVED AND RE-ERECTED	FOOT	60	60

\* INDICATES SPECIAL PROVISION

△ INDICATES SPECIALTY ITEM

FILE NAME = 10220-QUAN-01 - SUM-1	USER NAME =	DESIGNED -- BDB	REVISED --	STATE OF ILLINOIS DEPARTMENT OF TRANSPORTATION	SAFE ROUTES TO SCHOOLS CITY OF PLANO SUMMARY OF QUANTITIES	F.A.U. RTE.	SECTION	COUNTY	TOTAL SHEETS	SHEET NO.
	CHECKED -- JRA	REVISED --	VAR			10-00038-00-SW	KENDALL	12	2	
	PLOT SCALE =	DRAWN -- JJB	REVISED --			CONTRACT NO. 87456				
	PLOT DATE = 8/17/2011	CHECKED -- BDB	REVISED --			SCALE:	SHEET NO. 2 OF 12 SHEETS	STA. TO STA.	FED. ROAD DIST. NO. 3 ILLINOIS FED. AID PROJECT. SRTS-4009(103)	

SCHEDULE OF QUANTITIES

LOCATION	EARTH EXCAVATION (CU. YD.)	PC CONC SIDEWALK 4" (SQ. FT.)	PC CONC SIDEWALK 6" (SQ. FT.)	SIDEWALK REMOVAL	CURB REMOVAL (FOOT)	COMB. CONC. C&G, TB-6.12 (FOOT)	DETECTABLE WARNINGS (SQ. FT.)	DRIVE PVMNT REM (SQ. YD.)	HMA DRIVE PVMNT. 3" (SQ. YD.)	WOOD FENCE REM & RE-E (FOOT)	PIPE CULVERT, CL. A, TY 1, 12" (FOOT)	PRG FLAR END SEC, 12" (EACH)	TRENCH BACKFILL (CU. YD.)	PAINT PVMT MARK - LINE 6" (FOOT)	PAINT PVMT MARK - LINE 12" (FOOT)	PAINT PVMT MARK - LINE 24" (FOOT)	TREE REMOVAL, 6 TO 15 UNITS (UNIT)	RESTORATION (SQ. YD.)	SIGN PANEL - TYPE 1 (SQ. FT.)	SOLAR-POWER FB AS CMP (EACH)
<b>CENTER STREET</b>																				
STA. 5+78 to STA. 5+88 (LT.)			68	68			8													
STA. 6+09 to STA. 11+00 (LT.)	74.3	2498					8											163.7		
STA. 6+11 (LT.)							8													
STA. 8+53 (RT.)							8												11	1
STA. 8+71 (LT.)							8				14	2	2							
STA. 8+71 (RT.)	2.5	82			8	15	8							73	72			5.5		
STA. 8+80 (LT.)							8												11	1
STA. 11+00 to STA. 13+10 (LT.)	31.8	1068					8											70.0		
STA. 13+08 (LT.)							8													
STA. 13+48 to STA. 13+86 (LT.)	5.7	189					8											12.7		
STA. 13+50 (LT.)							8													
<b>CLIFFORD CT/SWEETBRIAR PL.</b>																				
STA. 18+06 to STA. 18+82 (LT.)	4.8	159		164	41	41	24													
STA. 18+06 to STA. 18+07 (RT.)																				
STA. 18+09 to STA. 20+74 (RT.)	40.1	1192			8	8	8													
STA. 20+74 to STA. 20+76 (RT.)					8	8	8													
20+76 to STA. 21+07 (RT.)					8	8	8													
STA. 21+07 to STA. 22+37 (RT.)	19.7	649																		
STA. 22+51 to STA. 23+08 (RT.)	8.6	298																		
STA. 23+22 to STA. 23+43 (RT.)	3.2	104																		
STA. 23+58 to STA. 24+10 (RT.)	7.9	262																		
STA. 24+28 to STA. 25+18 (RT.)	13.6	456																		
STA. 25+42 to STA. 25+58 (RT.)	2.1	77																		
STA. 25+65 to STA. 26+58 (RT.)	14.1	457																		
STA. 26+58 to STA. 26+69 (RT.)			57					11	5											
STA. 26+69 to STA. 27+00 (RT.)	4.7	141																		
STA. 27+00 to STA. 27+75 (RT.)	11.3	389																		
STA. 27+35 (RT.)																				
STA. 27+70 (RT.)				50																
				37	10	10	8													
<b>LEW STREET</b>																				
STA. 27+90 (RT.)																				
STA. 27+93 (RT.)	4.7	157		132	16	16	16							66					13	
STA. 28+07 (RT.)					8	8	8							57					13	
STA. 28+07 to STA. 28+08 (RT.)	15.3	501																		
STA. 28+43 to STA. 28+43 (RT.)				18																
STA. 28+45 to STA. 29+05 (RT.)										60										
STA. 29+08 to STA. 29+30 (RT.)			116					23	10											
STA. 29+30 to STA. 30+30 (RT.)	15.1	469																		33.3
<b>NORTH STREET</b>																				
STA. 34+50 (LT.)		27		23	16	16	8							74	77					
STA. 34+88 to STA. 36+21 (LT.)	8.6	658																		44.3
STA. 34+88 to STA. 34+50 (LT.)				2416			8													
STA. 34+50 to STA. 34+90 (LT.)																				
STA. 36+21 to STA. 36+36 (LT.)	14.7		79					45	37											6.5
STA. 36+36 to STA. 37+48 (LT.)	7.3	548																		37.3
STA. 37+48 to STA. 37+59 (LT.)	23.7		56					58	52											22.7
STA. 37+59 to STA. 39+08 (LT.)	9.7	747																		49.7
STA. 39+08 to STA. 39+21 (LT.)			63					4	6											24.0
STA. 39+21 to STA. 39+93 (LT.)	4.7	367																		
STA. 39+93 to STA. 40+03 (LT.)			51					2	2											
STA. 40+03 to STA. 40+40 (LT.)	2.4	190																		12.3
STA. 40+40 to STA. 40+51 (LT.)			48					3	5											
STA. 40+51 to STA. 41+25 (LT.)	4.8	377																		24.7
STA. 41+25 to STA. 41+39 (LT.)			70					4	6											
STA. 41+39 to STA. 41+50 (LT.)	0.7	49																		3.7
STA. 41+50 to STA. 43+25 (LT.)				645																
STA. 41+50 to STA. 41+93 (LT.)	2.8	219																		14.3
STA. 41+93 to STA. 42+10 (LT.)			85					4	8											
STA. 42+10 to STA. 43+25 (LT.)	7.5	614																		38.3
STA. 43+06 to STA. 43+25 (RT.)	1.2	48		48																6.3
STA. 43+06 to STA. 43+13 (LT.)					25	25	16													
STA. 43+13 to STA. 43+23 (LT.)					25	25	8													
STA. 43+23 to STA. 43+57 (LT.)							8													
STA. 43+57 to STA. 43+60 (RT.)					25	25	8													
STA. 43+60 to STA. 43+77 (LT.)	1.4	151		134			16													7.2
STA. 43+60 to STA. 43+77 (RT.)	1.1	49		49																5.5
STA. 43+77 to STA. 43+68 (LT.)							8													
<b>BEN STREET / SCHOOL STREET</b>																				
STA. 83+59 to STA. 83+81 (RT.)														65						
STA. 83+81 to STA. 83+88 (RT.)																			11	1
STA. 83+71 to STA. 84+11 (RT.)														80	85					
STA. 83+91 to STA. 84+30 (LT.)														76	76					
STA. 84+12 to STA. 84+12 (RT.)																				
STA. 84+24 to STA. 84+40 (LT.)														73						11
<b>SCHOOL STREET / WEST STREET</b>																				
STA. 92+52 to STA. 92+87 (RT.)																				
STA. 92+55 to STA. 92+77 (RT.)														90						
STA. 92+77 to STA. 93+07 (RT.)																			11	1
STA. 93+07 to STA. 93+55 (LT.)														93						
STA. 93+13 to STA. 93+13 (LT.)																			11	1
<b>MITCHELL DRIVE @ EMILY JOHN SCHOOL</b>																				
STA. 102+25 (RT.)																			11	1
STA. 102+50 (LT.)																			11	1

FILE NAME = 10228-MISC-01 - 3CH+1

USER NAME =

DESIGNED -- BDB

REVISED --

CHECKED -- JRA

REVISED --

PLOT SCALE =

DRAWN -- JJB

REVISED --

PLOT DATE = 8/17/2011

CHECKED -- BDB

REVISED --

STATE OF ILLINOIS  
DEPARTMENT OF TRANSPORTATION

SAFE ROUTES TO SCHOOLS  
CITY OF PLANO  
SCHEDULE OF QUANTITIES

SCALE:

SHEET NO. 3 OF 12 SHEETS STA. TO STA.

F.A.U. RTE.

VAR

**SCHEDULE OF QUANTITIES (CONTINUED)**

LOCATION	EARTH EXCAVATION (CU. YD.)	PC CONC SIDEWALK 4" (SQ. FT.)	PC CONC SIDEWALK 6" (SQ. FT.)	SIDEWALK REMOVAL	CURB REMOVAL (FOOT)	COMB. CONC. C&G, TB-6.12 (FOOT)	DETECTABLE WARNINGS (SQ. FT.)	DRIVE PVMNT REM (SQ. YD.)	HMA DRIVE PVMNT, 3" (SQ. YD.)	WOOD FENCE REM & RE-E (FOOT)	PIPE CULVERT, CL. A, TY 1, 12" (FOOT)	PRG FLAR END SEC, 12" (EACH)	TRENCH BACKFILL (CU. YD.)	PAINT PVMT MARK - LINE 6" (FOOT)	PAINT PVMT MARK - LINE 12" (FOOT)	PAINT PVMT MARK - LINE 24" (FOOT)	TREE REMOVAL, 6 TO 15 UNITS (UNIT)	RESTORATION (SQ. YD.)	SIGN PANEL - TYPE 1 (SQ. FT.)	SOLAR-POWER FB AS CMP (EACH)
WEST SOUTH STREET																				
STA. 56+79 to STA. 57+94 (RT.)	7.5	62						24	11									38.3		
STA. 57+94 to STA. 57+17 (RT.)			117																	
STA. 57+17 to STA. 57+70 (RT.)	3.4	258						15	7									17.7		
STA. 57+70 to STA. 57+85 (RT.)			75															10.7		
STA. 57+85 to STA. 58+17 (RT.)	2.1	212																5.0		
STA. 58+17 to STA. 58+47 (RT.)							8							46		10				
STA. 58+47 to STA. 58+52 (RT.)	1.0	61						50												
STA. 58+52 to STA. 58+52 (RT.)							8	43												
STA. 60+05 to STA. 60+15 (RT.)	0.6	66		54														3.3		
STA. 60+15 to STA. 63+22 (RT.)	16.7	1185																86.0		
STA. 63+22 to STA. 66+13 (RT.)	1.1	99		99														5.7		
STA. 66+13 to STA. 66+43 (RT.)							8							64		15				
STA. 66+43 to STA. 66+15 (RT.)							8													
STA. 66+15 to STA. 68+03 (RT.)	10.4	733																53.3		
STA. 68+03 to STA. 68+13 (RT.)			44					8	3											
STA. 68+13 to STA. 68+77 (RT.)	4.1	621																21.3		
STA. 68+77 to STA. 69+80 (RT.)	5.8	449																30.0		
STA. 69+80 to STA. 69+78 (RT.)							8													
STA. 69+78 to STA. 70+06 (RT.)							8							56						
STA. 70+06 to STA. 70+08 (RT.)																				
STA. 70+08 to STA. 70+93 (RT.)	5.6	434						17	12									29.0		
STA. 70+93 to STA. 71+03 (RT.)			50														8			
STA. 71+03 to STA. 71+47 (RT.)	2.9	216		122														14.7		
STA. 71+47 to STA. 71+50 (RT.)			16																	
STA. 71+50 to STA. 71+57 (RT.)			35					10	4											
STA. 71+57 to STA. 71+65 (RT.)	0.5	36						9	3									2.7		
STA. 71+65 to STA. 71+74 (RT.)			47																	
STA. 71+74 to STA. 72+23 (RT.)	3.2	245																16.3		
STA. 72+23 to STA. 72+08 (RT.)																	12			
STA. 72+08 to STA. 72-34 (RT.)				57				10	4											
STA. 72-34 to STA. 72-80 (RT.)	3.0	231						9	3									15.3		
STA. 72-80 to STA. 72-90 (RT.)			50																	
STA. 72-90 to STA. 73-13 (RT.)	1.5	116																7.7		
STA. 73-13 to STA. 74+18 (RT.)	5.3	399																27.0		
STA. 74+18 to STA. 74-35 (RT.)			86					17	8											
STA. 74-35 to STA. 75+48 (RT.)	7.3	269																37.7		
STA. 75+48 to STA. 75+83 (RT.)			77					30	11											
STA. 75+83 to STA. 76+52 (RT.)	4.5	353																23.0		
STA. 76+52 to STA. 76+70 (RT.)			89					16	6									44.3		
STA. 76+70 to STA. 78+03 (RT.)	8.6	689			16	16														
STA. 78+03 to STA. 78+01 (RT.)				45			16													
STA. 78+01 to STA. 77+94 (LT.)	1.5	48		25	25		8											3.2		
STA. 77+94 to STA. 78+41 (LT.)	1.4	47		61	25	25	8											3.1		
STA. 78+41 to STA. 78+41 (RT.)				25	25									247	78	33				
STA. 77+90 TO STA. 78-58 (RT.)																				
ROCK STREET																				
STA. 107+58 (LT.)					25	25														
STA. 107+58 (RT.)					25	25														
STA. 107+55 to STA. 107-73 (LT.)	1.2	132		117			16											6.0		
STA. 107-73 to STA. 107+73 (RT.)	1.2	125		106			16											6.0		
STA. 108+08 to STA. 110+75 (LT.)				1124																
STA. 108+08 to STA. 109+25 (LT.)	7.6	664																39.0		
STA. 109+25 to STA. 108+05 (LT.)					25	25														
STA. 108+05 to STA. 108+05 (RT.)					25	25														
STA. 108+05 to STA. 108+10 (LT.)							8													
STA. 108+10 to STA. 108+15 (LT.)							8													
STA. 108+15 to STA. 108+10 (RT.)							8													
STA. 108+10 to STA. 108+15 (RT.)	1.0	32		25			8											2.1		
STA. 109+25 to STA. 109+35 (LT.)			50																	
STA. 109+35 to STA. 110+75 (LT.)	9.1	705																46.7		
STA. 110+75 to STA. 110+57 (LT.)					25	25														
STA. 110+57 to STA. 110+62 (RT.)					25	25														
STA. 110+62 to STA. 110+68 (RT.)				90			8													
STA. 110+68 to STA. 110+73 (RT.)		121					8											8.1		
STA. 110+73 to STA. 110+68 (LT.)							8													
STA. 110+68 to STA. 110+73 (LT.)							8													
STA. 110+73 to STA. 111+06 (LT.)					25	25														
STA. 111+06 to STA. 111+06 (RT.)					25	25														
STA. 110+75 to STA. 111+08 (LT.)														258		14				
STA. 111+08 to STA. 113+67 (LT.)				1075																
STA. 113+67 to STA. 111+10 (LT.)							8													
STA. 111+10 to STA. 111+18 (LT.)							8													
STA. 111+18 to STA. 111+10 (RT.)				126			8													
STA. 111+10 to STA. 111+18 (RT.)	4.7	154					8													
STA. 111+18 to STA. 112+48 (LT.)	11.2	735																10.3		
STA. 112+48 to STA. 112+60 (LT.)			60					7	7									57.7		
STA. 112+60 to STA. 113+67 (LT.)	6.9	539																35.7		
STA. 113+67 to STA. 113+80 (RT.)	1.0	93					16											5.0		
STA. 113+80 to STA. 113+65 (LT.)					25	25														
STA. 113+65 to STA. 113+65 (RT.)					25	25														
STA. 113+80 to STA. 114+13 (LT.)														258		13				
STA. 114+13 to STA. 114+14 (LT.)																				
STA. 114+14 to STA. 114+14 (RT.)					25	25														
STA. 114+14 to STA. 114+50 (LT.)	2.4	200		168														12.3		
STA. 114+50 to STA. 114+15 (LT.)							8													
STA. 114+15 to STA. 114+22 (LT.)							8													
STA. 114+22 to STA. 114+15 (RT.)							8													
STA. 114+15 to STA. 114+22 (RT.)	3.2	107		89			8											7.1		
STA. 114+22 to STA. 116+84 (LT.)				958																
STA. 114+84 to STA. 115+52 (LT.)	6.0	515																30.7		
STA. 115+52 to STA. 115+63 (LT.)			53																	
STA. 115+63 to STA. 116+84 (LT.)	7.8	596																40.3		
STA. 116+84 to STA. 116+82 (LT.)					8	8	8													
STA. 116+82 to STA. 117+12 (LT.)														61		12				
STA. 117+12 to STA. 117+14 (LT.)					8	8														
STA. 117+14 to STA. 117+26 (LT.)	0.6	42		34			8											3.0		
STA. 117+26 to STA. 117+26 (RT.)																				
TOTALS	532	24781	1599	8145	646	653	488	419	210	60	14	2	2	1917	388	226	20	1718	99	9

FILE NAME = 10228-MSC-01 - SCH-2  
 USER NAME =  
 PLOT SCALE =  
 PLOT DATE = 8/17/2011

DESIGNED -- BDB	REVISOR --
CHECKED -- JRA	REVISOR --
DRAWN -- JJB	REVISOR --

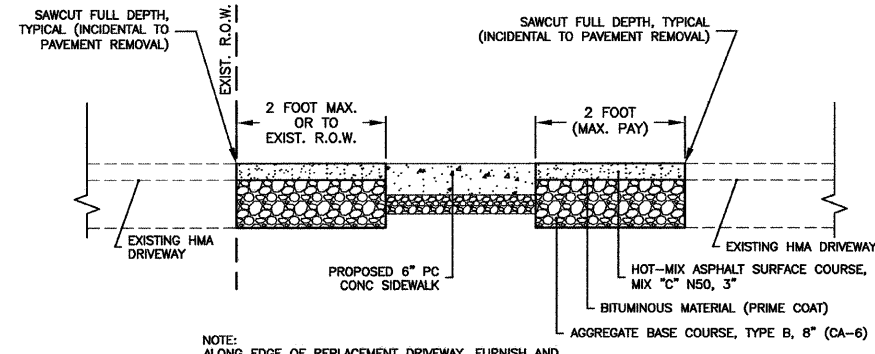

NOTE:  
ALONG EDGE OF REPLACEMENT DRIVEWAY, FURNISH AND PLACE, 4" TOPSOIL W/ SEEDING, CLASS 1

**HMA DRIVEWAY REPLACEMENT DETAIL**  
NOT TO SCALE

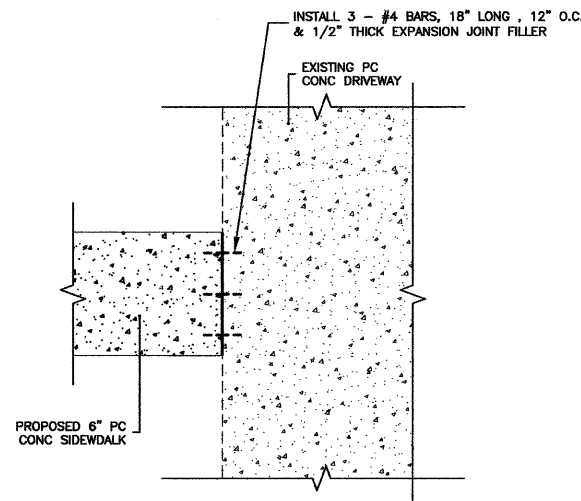

**PLAN**

**MIXTURE TABLE**

	HMA DRIVEWAY PAVEMENT
PG GRADE	PG 64-22
MAX % RAP ALLOWABLE	10
DESIGN AIR Voids	4.0% @ N50
MIXTURE COMPOSITION	IL 9.5
FRICTION AGGREGATE	MIXTURE C
DENSITY TEST METHOD	SATISFACTION OF ENGINEER

\* MATERIAL SHALL BE COMPACTED TO 93.0-97.4 PERCENT OF THE MAXIMUM THEORETICAL DENSITY, EXCEPT THAT WHEN PLACED AS FIRST LIFT ON AN UNIMPROVED SUBGRADE, THE MINIMUM PERCENT COMPACTION SHALL BE 92.0 PERCENT. THE MAXIMUM THEORETICAL DENSITY SHALL BE DETERMINED FROM THE MOVING AVERAGE AS SPECIFIED IN THE QC/QA SPECIFICATION.

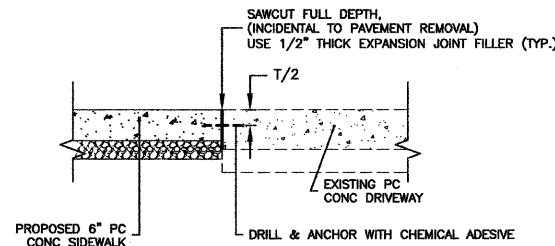

**PROFILE**

NOTE:  
ALONG EDGE OF REPLACEMENT DRIVEWAY, FURNISH AND PLACE 4" TOPSOIL W/ SEEDING, CLASS 1

**PROPOSED PC CONC. SIDEWALK ABUTTING EXISTING P.C.C. DRIVEWAY DETAIL**  
NOT TO SCALE

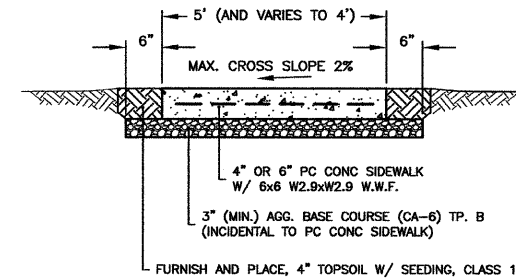

**PC CONCRETE SIDEWALK DETAIL**  
NOT TO SCALE

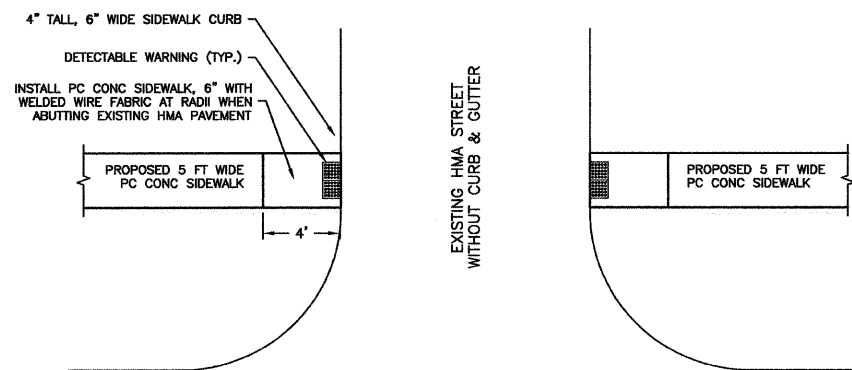

**PC CONC. SIDEWALK DETAIL ABUTTING EXISTING HMA PAVEMENT**  
NOT TO SCALE

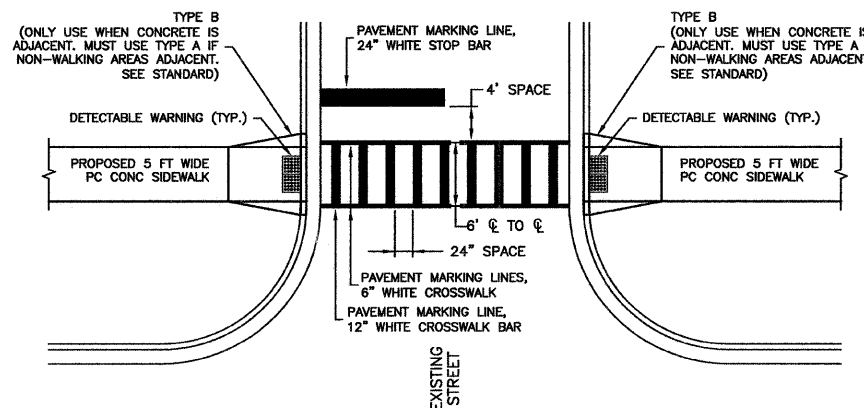

**HIGH VOLUME CROSSWALK DETAIL**  
NOT TO SCALE

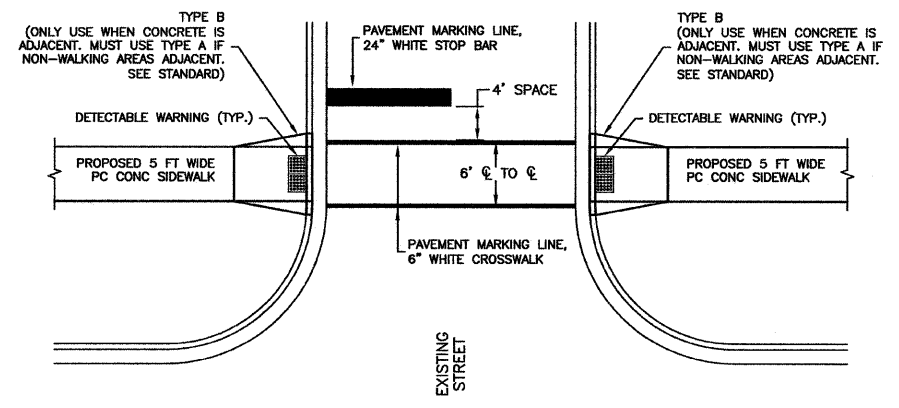

**LOW VOLUME CROSSWALK DETAIL**  
NOT TO SCALE

**GENERAL NOTES:**

- BEFORE STARTING ANY EXCAVATION, THE CONTRACTOR SHALL CALL J.U.L.I.E. AT (800) 892-0123 FOR FIELD LOCATIONS OF BURIED ELECTRIC, TELEPHONE AND GAS UTILITIES. (48 HOUR NOTIFICATION IS REQUIRED).
- BOTH ROBINSON ENGINEERING, LTD. (815-464-2240) AND THE CITY OF PLANO PUBLIC WORKS DEPARTMENT (630-552-7000) SHALL BE NOTIFIED TWO (2) WORKING DAYS BEFORE CONSTRUCTION BEGINS.
- WHEN IN THE CONSTRUCTION OPERATION, IF ANY LOOSE MATERIAL IS DEPOSITED IN THE FLOW LINE OF DITCHES, GUTTERS, OR OTHER DRAINAGE STRUCTURES SO THAT THE NATURAL FLOW OF WATER IS OBSTRUCTED, IT SHALL BE REMOVED AT THE CLOSE OF EACH DAY BY THE CONTRACTOR AT HIS EXPENSE.
- AREAS DISTURBED BY CONSTRUCTION SHALL BE KEPT TO A MINIMUM. ALL AREAS DISTURBED UNNECESSARILY SHALL BE RESTORED AS REQUIRED IN THE SPECIAL PROVISIONS AT THE CONTRACTOR'S EXPENSE.
- ALL PAVEMENT, CURB AND SIDEWALK REMOVALS SHALL BE MADE BY MEANS OF A STRAIGHT SAW CUT JOINT. THIS WORK SHALL NOT BE PAID FOR SEPARATELY, BUT SHALL BE INCLUDED IN THE UNIT PRICE BID FOR THE VARIOUS ITEMS.
- TEMPORARY ACCESS TO PROPERTIES AFFECTED BY THE CONSTRUCTION SHALL BE MAINTAINED AT ALL TIMES BY PLACEMENT OF TEMPORARY AGGREGATE. THE CONTRACTOR SHALL PERIODICALLY MONITOR ALL AFFECTED AREAS DURING THE PROJECT, AND SHALL PLACE ADDITIONAL AGGREGATE WHEN NECESSARY. THIS WORK WILL NOT BE PAID FOR DIRECTLY, BUT WILL BE CONSIDERED INCIDENTAL TO THE CONTRACT.
- IT SHALL BE THE CONTRACTOR'S RESPONSIBILITY TO VERIFY ALL DIMENSIONS AND CONDITIONS EXISTING IN THE FIELD PRIOR TO CONSTRUCTION AND ORDERING OF MATERIALS.
- WHERE CURB IS NOT PRESENT, THE LAST 5' OF NEW WALK SHALL BE THICKENED TO A MINIMUM OF 7". THIS WORK SHALL BE CONSIDERED INCIDENTAL TO PORTLAND CEMENT CONCRETE SIDEWALK, 4 INCH.

FILE NAME = 10228-NOTE-01 - P01

USER NAME =	DESIGNED -- BDB	REVISION --
CHECKED -- JRA	REVISION --	
PLOT SCALE =	DRAWN -- JJB	REVISION --
PLOT DATE = 8/17/2011	CHECKED -- BDB	REVISION --

STATE OF ILLINOIS  
DEPARTMENT OF TRANSPORTATION

SAFE ROUTES TO SCHOOLS  
CITY OF PLANO  
GENERAL NOTES AND DETAILS

SCALE: SHEET NO. 5 OF 12 SHEETS STA. TO STA.

F.A.U. RATE	SECTION	COUNTY	TOTAL SHEETS	SHEET NO.
VAR	10-00038-00-SW	KENDALL	12	5
CONTRACT NO. 87456				
FED. ROAD DIST. NO. 3 ILLINOIS FED. AID PROJECT SRTS-4009(103)				



SECTION 22, TOWNSHIP 37, RANGE 6E

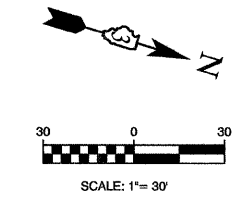
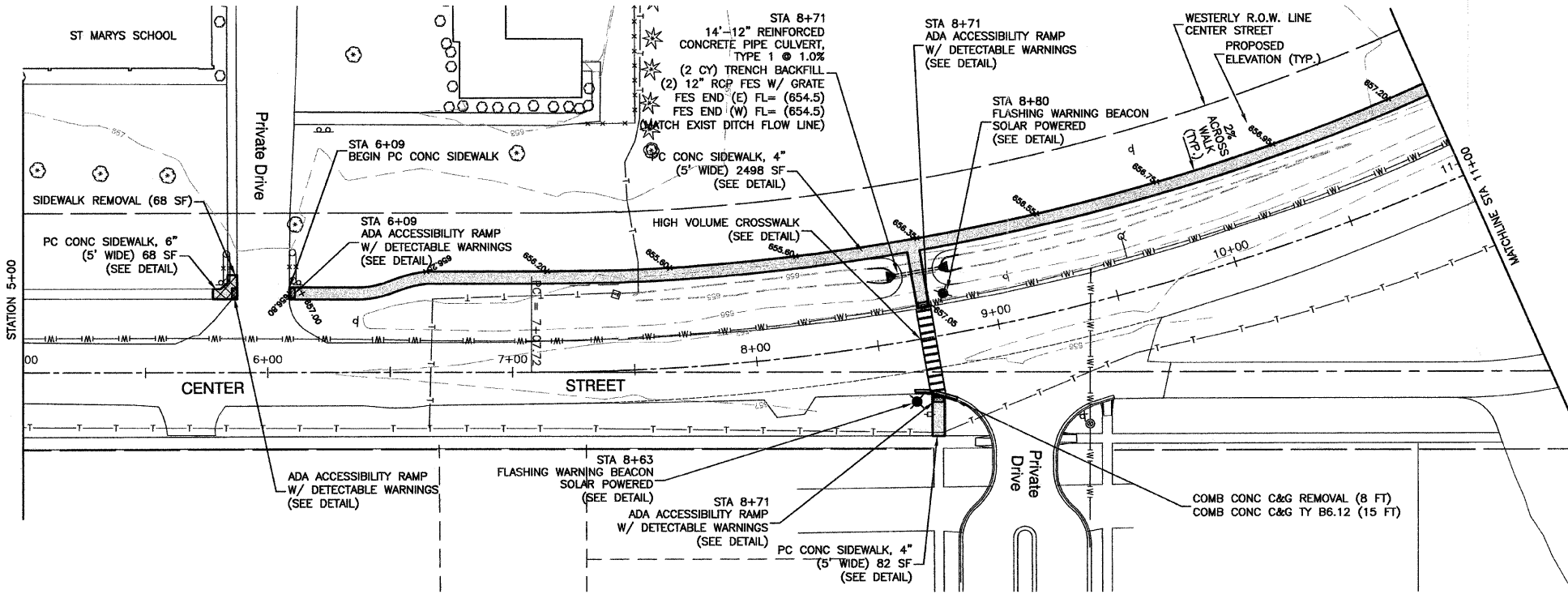

- LEGEND -**
- TREE TO BE REMOVED
  - CONCRETE DRIVEWAY REMOVAL
  - BITUMINOUS DRIVEWAY REMOVAL
  - SIDEWALK REMOVAL
  - PROPOSED CURB AT SIDEWALK
  - PROPOSED PC CONC SIDEWALK
  - PROPOSED DETECTABLE WARNING

- SIGN LEGEND**
- S1-1  
36"x36"
  - W16-7pL  
24"x12"
  - SCHOOL CROSSING SIGN W/  
FLASHING WARNING BEACON

PLAN	SURVEYED	DATE
	PLOTTED	BY
	CHECKED	
	DATE	
	NO. OF W/ CHECKED	
	CADD FILE NAME	

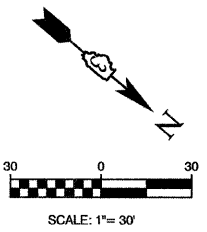
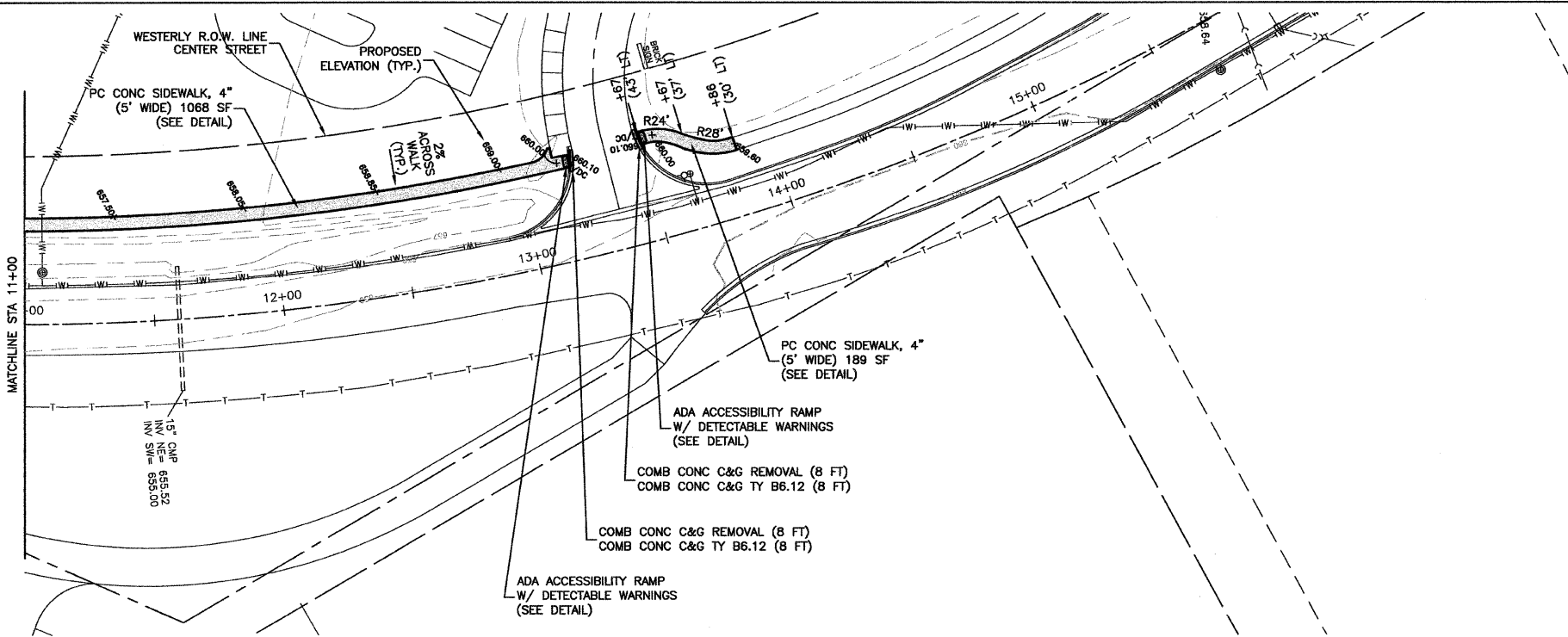

- BENCH MARKS:**
- BENCHMARK #1**  
KENDALL COUNTY BM # 108  
BRASS MARKER ON TOP OF THE SOUTHWEST WING WALL  
OF THE MILLER ROAD BRIDGE JUST EAST OF CREEK ROAD  
ELEV = 667.85
- BENCHMARK #2**  
SOUTHWEST TAG BOLT ON THE HYDRANT LOCATED AT THE  
SOUTHWEST CORNER OF THE CHURCH STREET AND  
CENTER STREET  
ELEV = 656.03

PROFILE	SURVEYED	DATE
	PLOTTED	BY
	CHECKED	
	DATE	
	NO. OF W/ CHECKED	
	B.M. NOTED	

FILE NAME = 10228-PLAN-01 - CENTER	USER NAME =	DESIGNED -- BDB	REVISIONS	<b>STATE OF ILLINOIS DEPARTMENT OF TRANSPORTATION</b>	<b>SAFE ROUTES TO SCHOOLS CITY OF PLANO CENTER STREET PLANS</b>	F.A.U. RTE.	SECTION	COUNTY	TOTAL SHEETS	SHEET NO.	
	CHECKED -- JRA	REVISIONS	VAR			10-00038-00-SW	KENDALL	12	6		
	PLOT SCALE =	DRAWN -- JJB	REVISIONS			CONTRACT NO. 87456					
	PLOT DATE = 8/17/2011	CHECKED -- BDB	REVISIONS			SCALE: SHEET NO. 6 OF 12 SHEETS STA. TO STA.					
						FED. ROAD DIST. NO. 3 ILLINOIS FED. AID PROJECT SRTS-4009(103)					

AST REVISED BY: JAL/MAR/01/06/01  
PLOTTER BY: JOSSE ALVAREZ ON 8/20/11

SECTION 22, TOWNSHIP 37, RANGE 6E

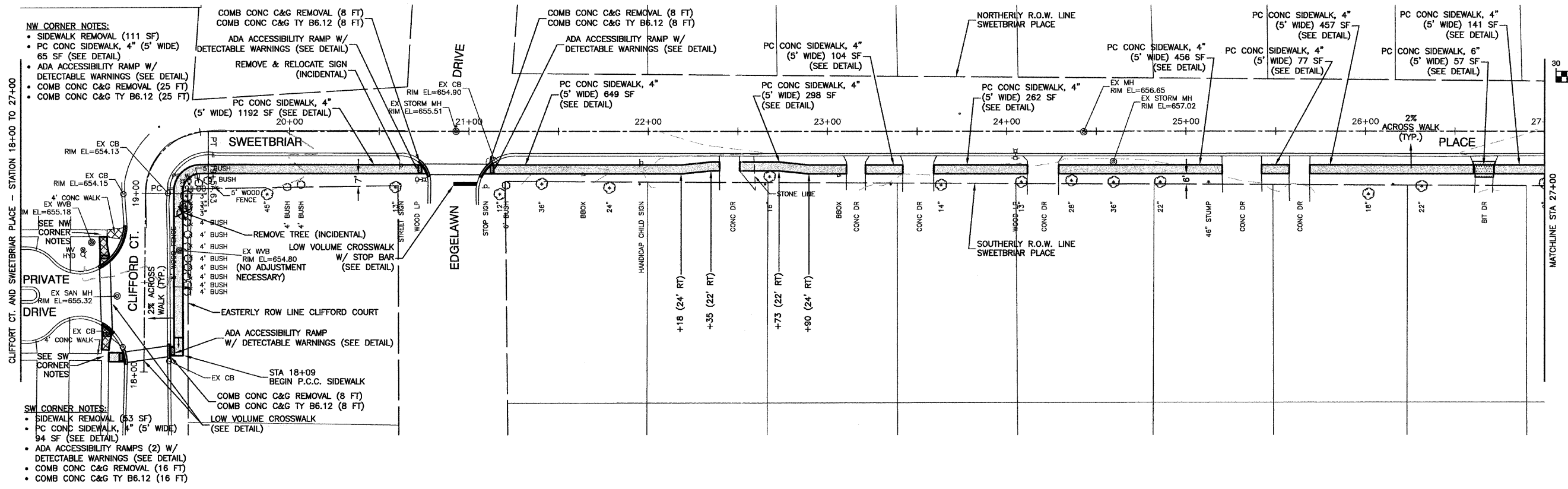

DATE	BY
PLANNED	
CHECKED	
NO. OF WAY CHECKED	
NOTE BOOK	
NO.	

DATE	BY
PROFILE	
CHECKED	
NO. OF WAY CHECKED	
NOTE BOOK	
NO.	

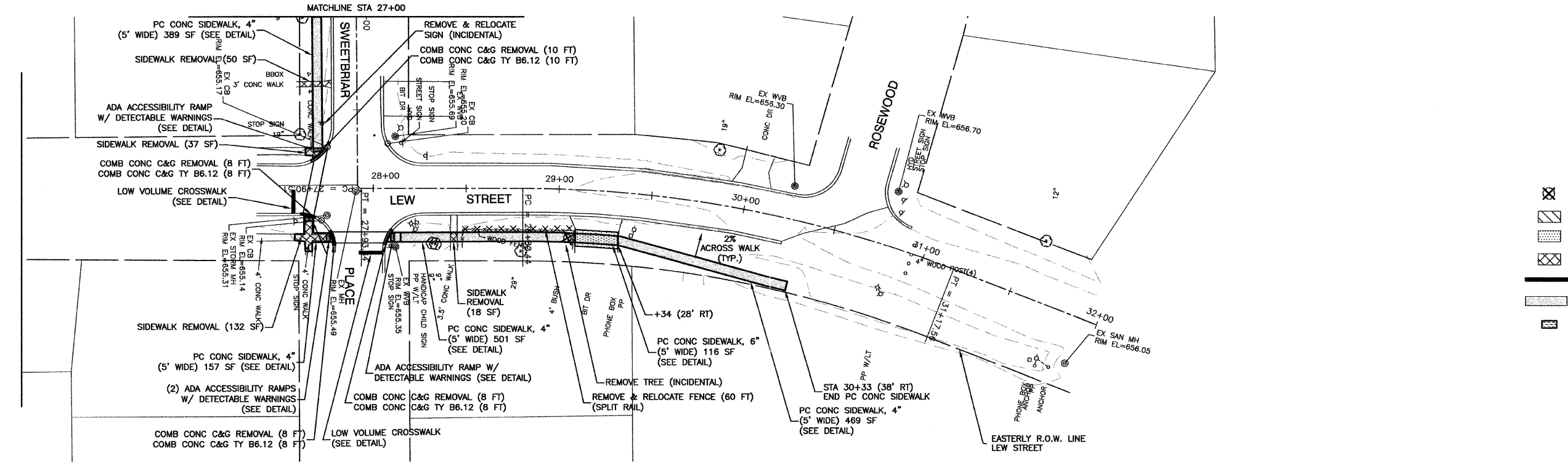
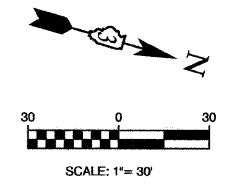

**- LEGEND -**

- TREE TO BE REMOVED
- CONCRETE DRIVEWAY REMOVAL
- BITUMINOUS DRIVEWAY REMOVAL
- SIDEWALK REMOVAL
- PROPOSED CURB AT SIDEWALK
- PROPOSED PC CONC SIDEWALK
- PROPOSED DETECTABLE WARNING

FILE NAME = 10229-PLAN-01 - SWEETBRIAR

USER NAME =	DESIGNED — BDB	REVISED —
	CHECKED — JRA	REVISED —
PLOT SCALE =	DRAWN — JJB	REVISED —
PLOT DATE = 8/17/2011	CHECKED — BDB	REVISED —

STATE OF ILLINOIS  
DEPARTMENT OF TRANSPORTATION

SAFE ROUTES TO SCHOOLS  
CITY OF PLANO  
SWEETBRIAR PLACE PLANS

F.A.U. RTE.	SECTION	COUNTY	TOTAL SHEETS	SHEET NO.
VAR	10-00038-00-SW	KENDALL	12	7
CONTRACT NO. 87456				
SCALE: SHEET NO. 7 OF 12 SHEETS STA. TO STA.				
FED. ROAD DIST. NO. 3 ILLINOIS FED. AID PROJECT SRTS-4009(103)				

NOT SHOWN BY: JAVIER VAZQUEZ ON 8/17/11  
PLOT BY: JOSE ALVAREZ ON 8/17/11

SECTION 22, TOWNSHIP 37, RANGE 6E

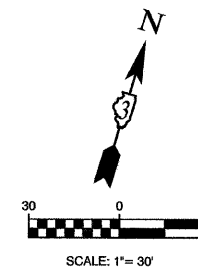

- LEGEND -**
- TREE TO BE REMOVED
  - CONCRETE DRIVEWAY REMOVAL
  - BITUMINOUS DRIVEWAY REMOVAL
  - SIDEWALK REMOVAL
  - PROPOSED CURB AT SIDEWALK
  - PROPOSED PC CONC SIDEWALK
  - PROPOSED DETECTABLE WARNING

PLAN	SURVEYED	DATE
	PLOTTED	
	CHECKED	
	BY	
	NO. OF W/ CHECKED	
	NO. OF W/ CHECKED	
	NO. OF W/ CHECKED	

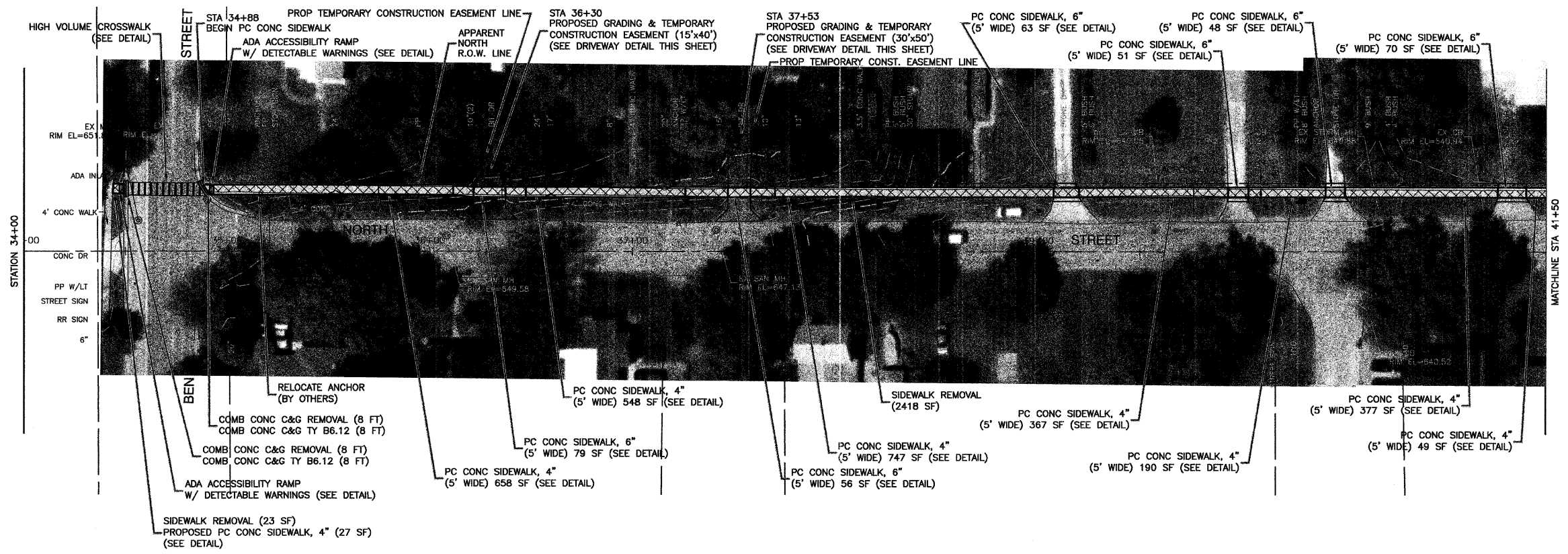

PROFILE	SURVEYED	DATE
	PLOTTED	
	CHECKED	
	BY	
	NO. OF W/ CHECKED	
	NO. OF W/ CHECKED	

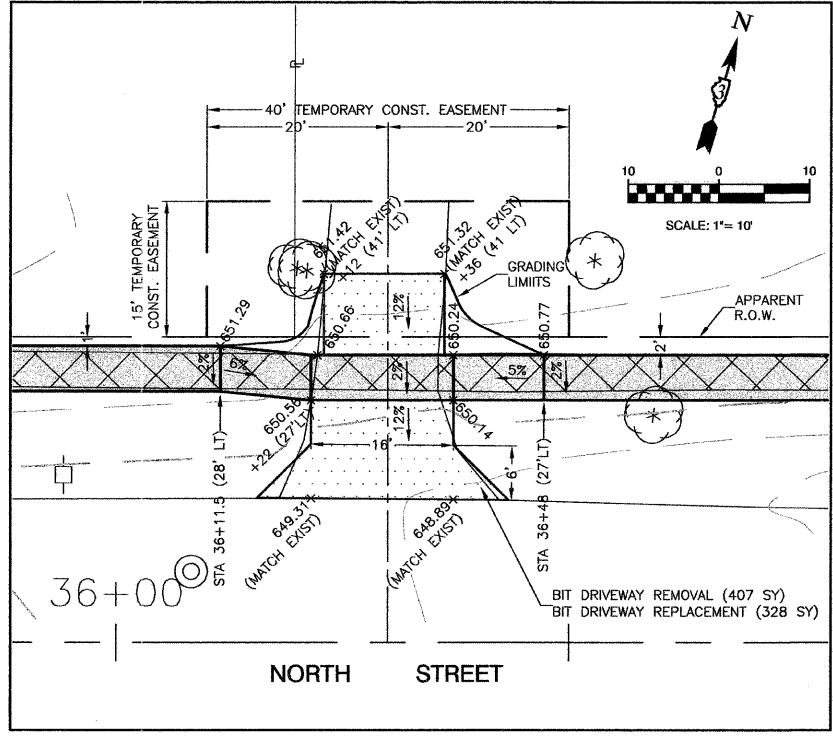
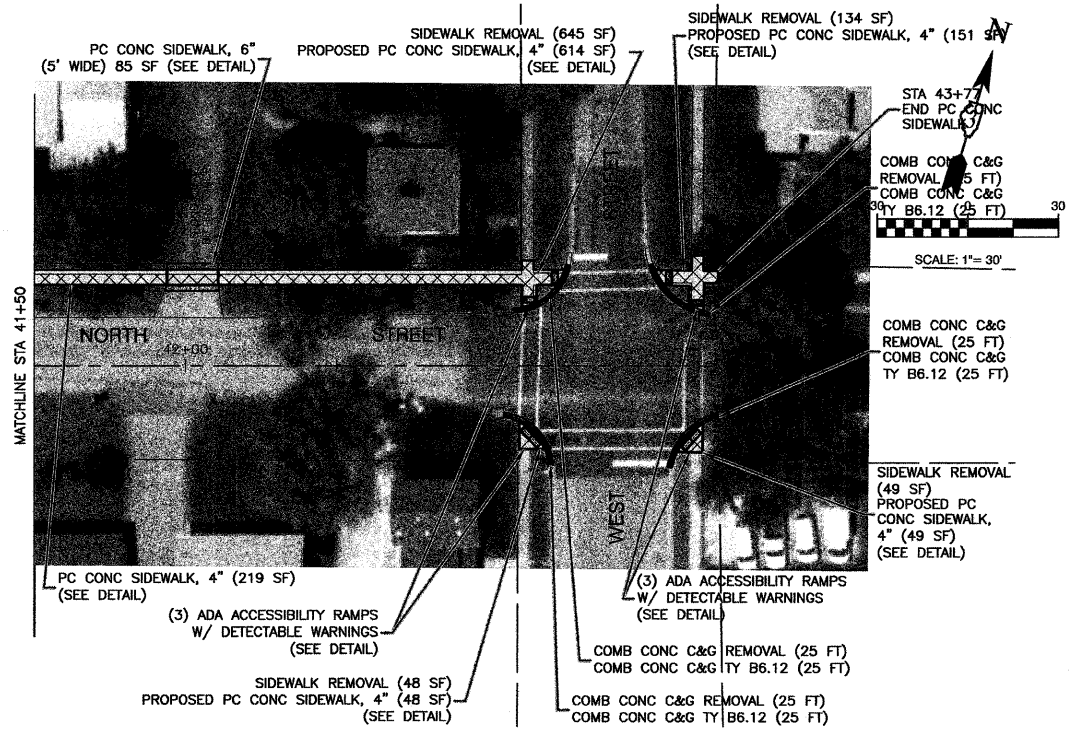

DRIVEWAY DETAIL STA 36+29  
SCALE: 1"=10'

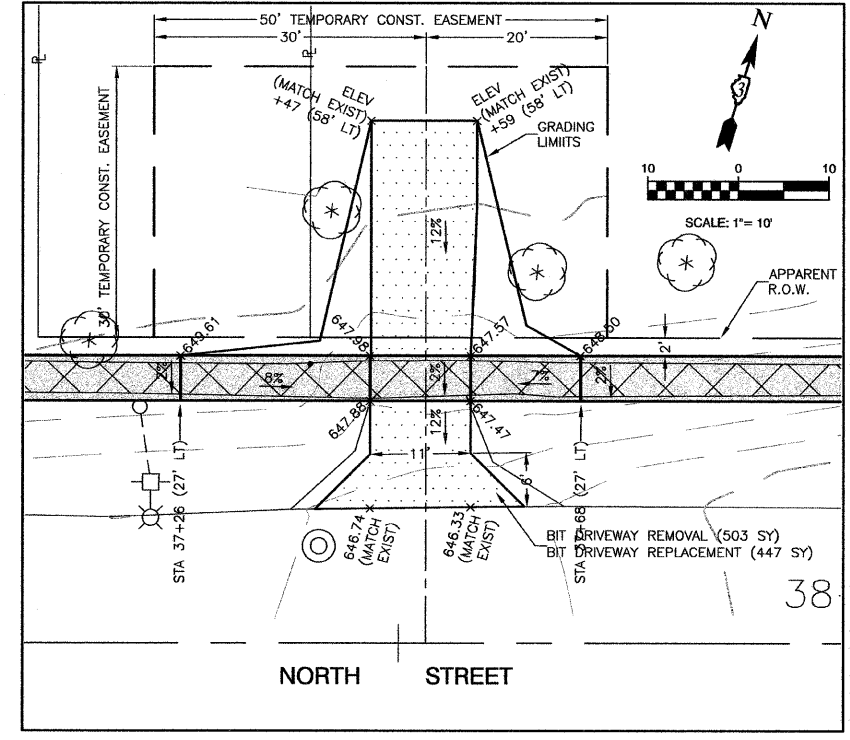

DRIVEWAY DETAIL STA 37+53  
SCALE: 1"=10'

FILE NAME = 10228-PLAN-01 - NORTH	USER NAME =	DESIGNED - BDB	REVISIONS -
		CHECKED - JRA	REVISIONS -
	PLOT SCALE =	DRAWN - JJB	REVISIONS -
	PLOT DATE = 8/17/2011	CHECKED - BDB	REVISIONS -

STATE OF ILLINOIS  
DEPARTMENT OF TRANSPORTATION

SAFE ROUTES TO SCHOOLS  
CITY OF PLANO  
NORTH STREET PLANS

F.A.U. RTE.	SECTION	COUNTY	TOTAL SHEETS	SHEET NO.
VAR	10-00038-00-SW	KENDALL	12	8
CONTRACT NO. 87456				
FED. ROAD DIST. NO. 3 ILLINOIS FED. AID PROJECT SRTS-4009(103)				

SCALE: SHEET NO. 8 OF 12 SHEETS STA. TO STA.

ALL RIGHTS BY THE USER ON THIS DRAWING ARE RESERVED.





SECTION 28, TOWNSHIP 37, RANGE 6E

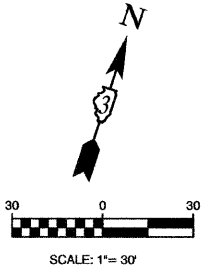

- LEGEND -**
- TREE TO BE REMOVED
  - CONCRETE DRIVEWAY REMOVAL
  - BITUMINOUS DRIVEWAY REMOVAL
  - SIDEWALK REMOVAL
  - PROPOSED CURB AT SIDEWALK
  - PROPOSED PC CONC SIDEWALK
  - PROPOSED DETECTABLE WARNING

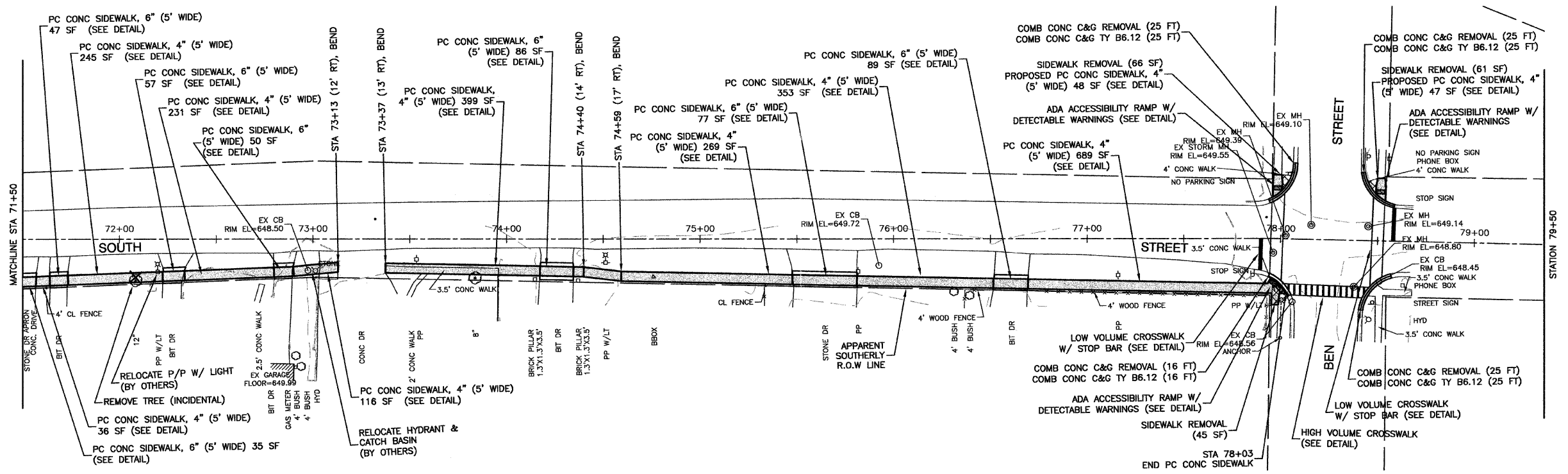

PLAN	SURVEYED	DATE
NOTE BOOK	PLOTTED	BY
NO.	CHECKED	
	RT. OF WAY CHECKED	
	ODD FILE NAME	

PROFILE	SURVEYED	DATE
NOTE BOOK	PLOTTED	BY
	CHECKED	
	S.M. NOTED	

FILE NAME = 10228-PLAN-01 - SOUTH-2	USER NAME =	DESIGNED — BDB	REVISED —	<b>STATE OF ILLINOIS</b> <b>DEPARTMENT OF TRANSPORTATION</b>	<b>SAFE ROUTES TO SCHOOLS</b> <b>CITY OF PLANO</b> <b>SOUTH STREET PLANS</b>	F.A.U. RTE.	SECTION	COUNTY	TOTAL SHEETS	SHEET NO.	
		CHECKED — JRA	REVISED —			VAR	10-00038-00-SW	KENDALL	12	10	
		PLOT SCALE =	DRAWN — JJB			REVISED —	CONTRACT NO. 87456				
		PLOT DATE = 8/17/2011	CHECKED — BDB			REVISED —	FED. ROAD DIST. NO. 3 ILLINOIS FED. AID PROJECT SRTS-4009(103)				
						SCALE:	SHEET NO. 10 OF 12 SHEETS	STA.	TO STA.		

LAST DRAWN BY: JLV/WRZ/01/08/11  
 PLOT: PLOT BY: SCHE AL/WRZ/01/08/11





SECTION 27, TOWNSHIP 37, RANGE 6E

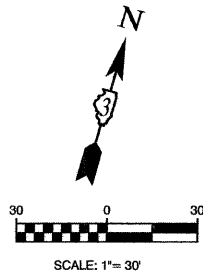
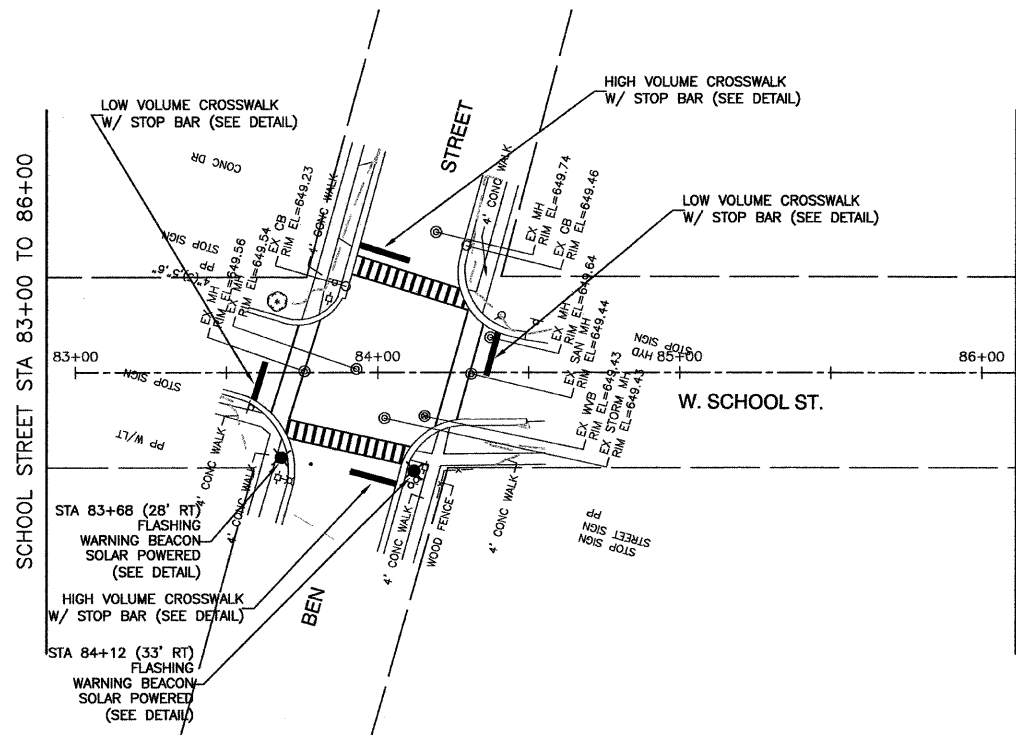

SCHOOL STREET STA 83+00 TO 86+00

SCHOOL STREET STA 92+00 TO 95+00

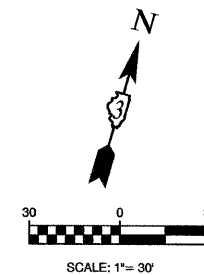
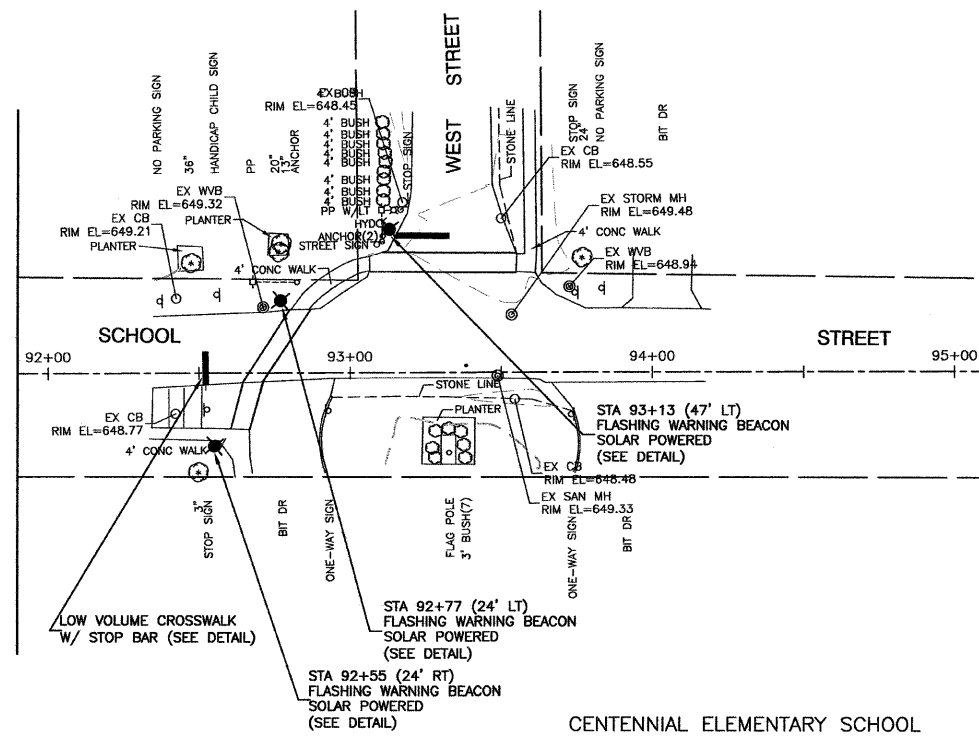

CENTENNIAL ELEMENTARY SCHOOL

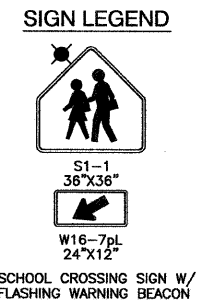

PLAN	SURVEYED	DATE
	PLOTTED	
	CHECKED	
	BY	
	DATE	
	NOTE BOOK	
	REF. OF WAY CHECKED	
	ADD. FILE NAME	

SECTION 25, TOWNSHIP 37, RANGE 6E

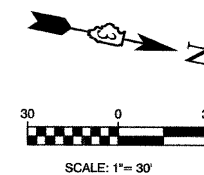
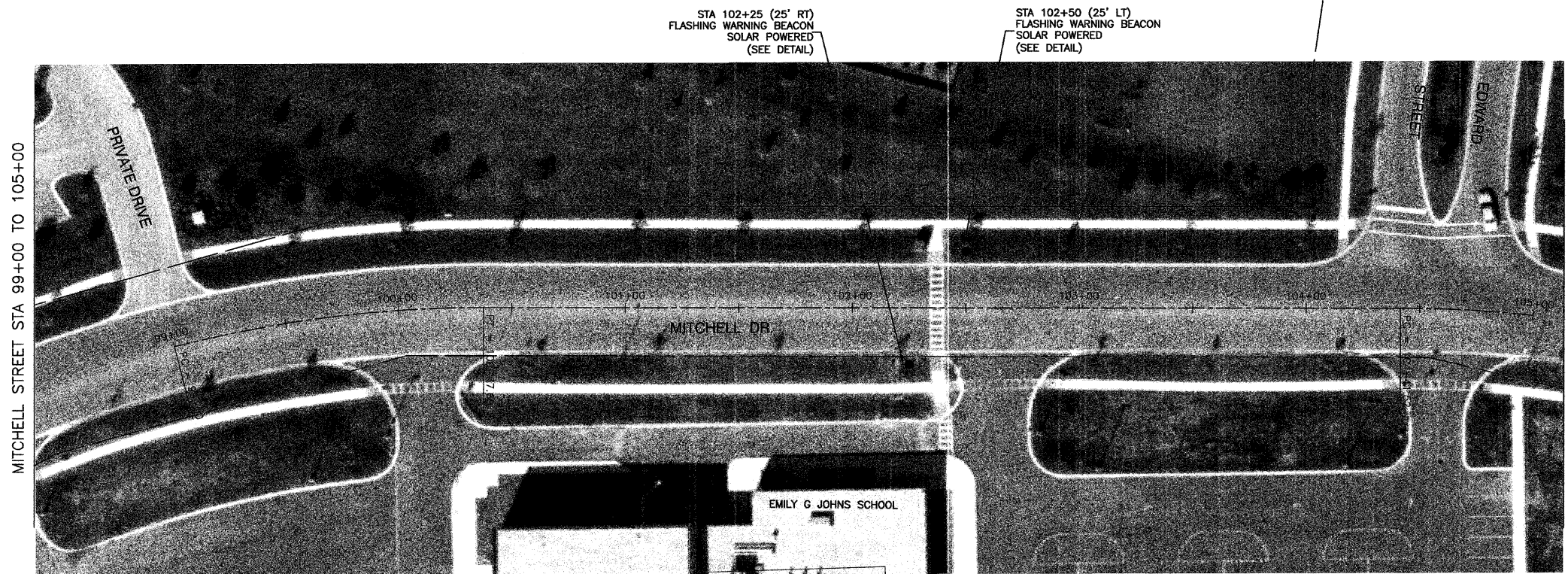

MITCHELL STREET STA 99+00 TO 105+00

STATION 105+00

PROFILE	SURVEYED	DATE
	PLOTTED	
	CHECKED	
	BY	
	DATE	
	NOTE BOOK	
	REF. OF WAY CHECKED	
	ADD. FILE NAME	

FILE NAME = 10228-PLAN-01 - SCHOOL - MITCHEL

USER NAME =	DESIGNED — BDB	REVISIONS
	CHECKED — JRA	REVISIONS
PLOT SCALE =	DRAWN — JJB	REVISIONS
PLOT DATE = 8/17/2011	CHECKED — BDB	REVISIONS

STATE OF ILLINOIS  
DEPARTMENT OF TRANSPORTATION

SAFE ROUTES TO SCHOOLS  
CITY OF PLANO  
SCHOOL ST & MITCHELL DR PLANS

SCALE: SHEET NO. 12 OF 12 SHEETS STA. TO STA.

F.A.U. RTE.	SECTION	COUNTY	TOTAL SHEETS	SHEET NO.
VAR	10-00038-00-SW	KENDALL	12	12
CONTRACT NO. 87456				
FED. ROAD DIST. NO. 3 ILLINOIS FED. AID PROJECT SRTS-4009(103)				