

F.A.U. RTE.	SECTION	COUNTY	TOTAL SHEETS	SHEET NO.
N/A	10-00010-00-SW	DEKALB	11	5

CONTRACT NO. 07457

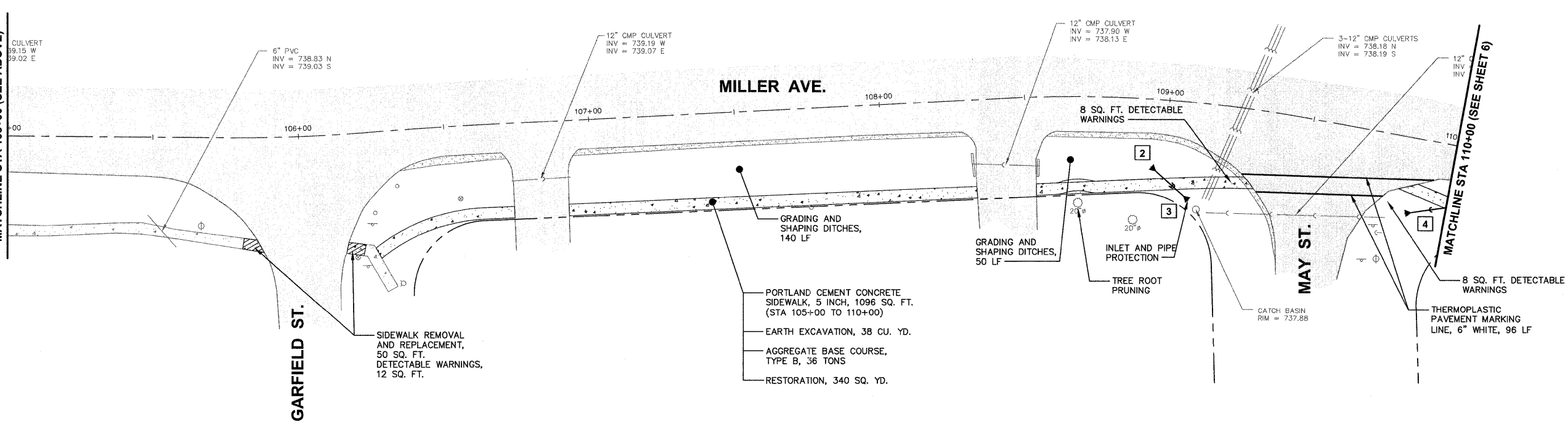
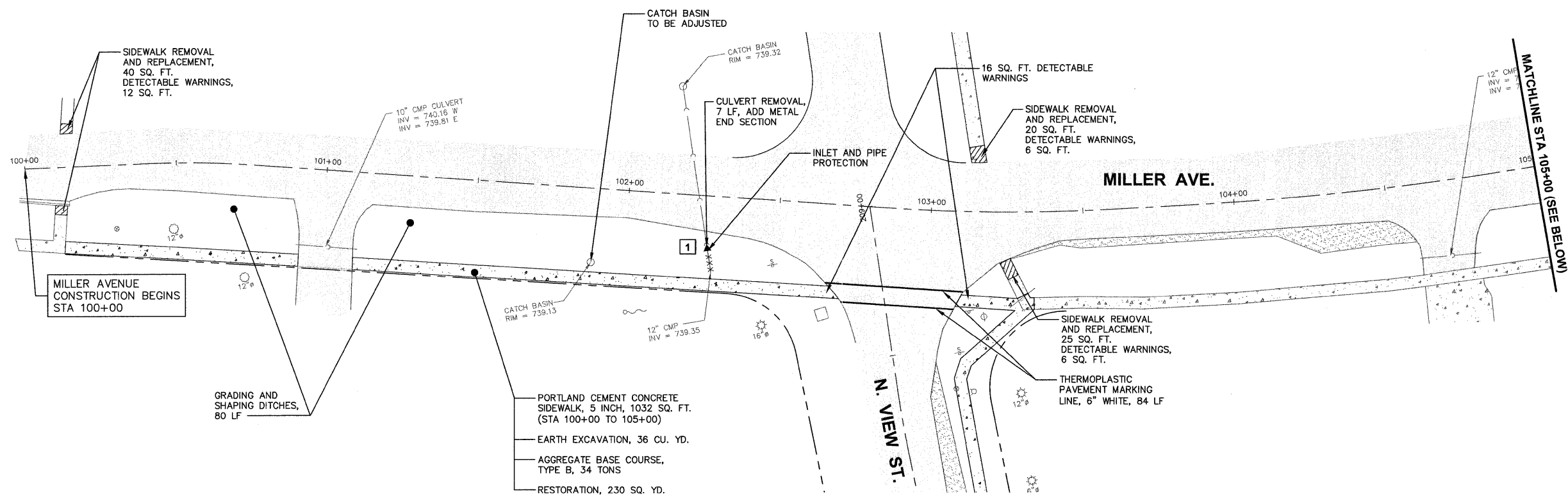

**STORM SEWER SCHEDULE**

- 1 METAL END SECTION 12" STA 102+27, 18.37' RT. INV = 739.35
- 2 METAL END SECTION 12" STA 108+95, 23.30' RT. INV = 738.20  
20 LF PIPE CULVERTS, CLASS C, 12" TYPE 1 @ 0.50% TRENCH BACKFILL, 3 CU. YD.
- 3 METAL END SECTION 12" STA 109+09, 33.66' RT. INV = 738.10
- 4 METAL END SECTION 12" STA 109+86.50, 26.10' RT. INV = 738.40  
25 LF PIPE CULVERTS, CLASS C, 12" TYPE 1 @ 0.40% TRENCH BACKFILL, 3 CU. YD.

Plotted: February 9, 2012 @ 3:28 PM By: Kris Pung - Tab: 05 Miller 22x34  
 COPYRIGHT © 2012 ENGINEERING ENTERPRISES, INC.

**Engineering Enterprises, Inc.**  
 CONSULTING ENGINEERS  
 52 Wheeler Road  
 Sugar Grove, Illinois 60554  
 630.466.6700 / www.eeiweb.com

**VILLAGE OF HINCKLEY**  
 DEKALB COUNTY, ILLINOIS

NO.	DATE	REVISIONS
1	2/1/12	REVISED PER IDOT COMMENTS FROM 12/14/11

**SAFE ROUTES TO SCHOOL**  
 VILLAGE OF HINCKLEY

**MILLER AVENUE**  
 STA 100+00 TO STA 110+00

DATE:	NOVEMBER 2011
PROJECT NO:	HI0804
FILE:	HI0804-PLAN
SHEET	<b>5</b> OF <b>11</b>

Path: H:\S0505\FRQA\HI0804\DWG\FINAL\_ENG\HI0804-PLAN