

DATE	
BY	
REVISIONS	
NO.	
DESCRIPTION	

DATE	
BY	
REVISIONS	
NO.	
DESCRIPTION	

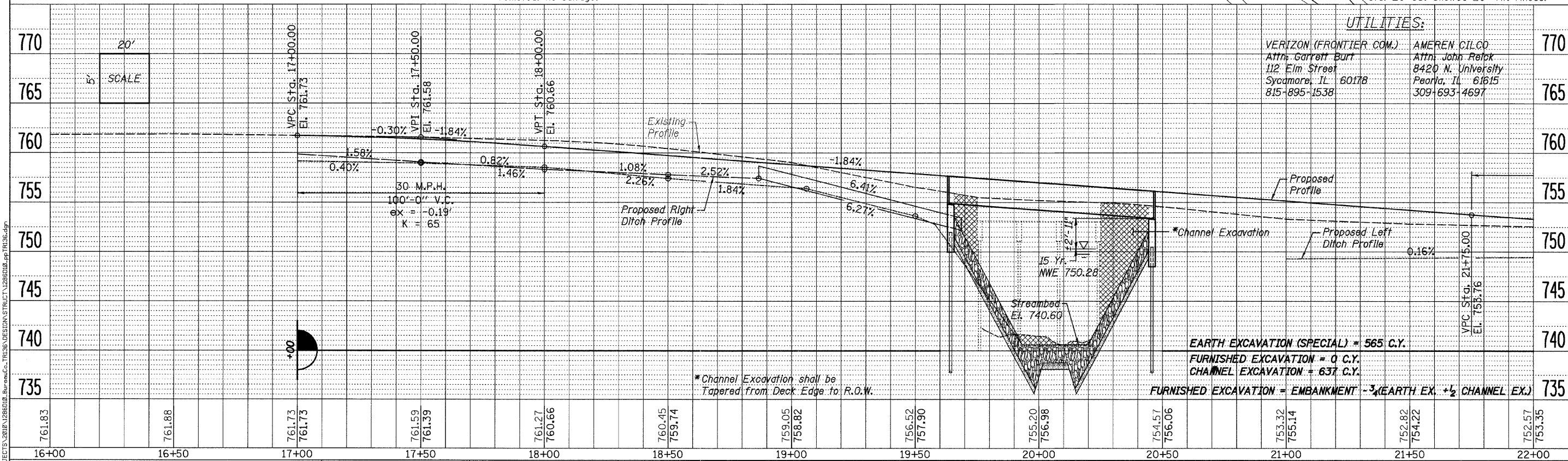

770	765	760	755	750	745	740	735	761.83	761.88	761.73	761.59	761.27	760.45	759.05	756.52	755.20	754.57	753.32	752.82	752.57				
16+00	16+50	17+00	17+50	18+00	18+50	19+00	19+50	20+00	20+50	21+00	21+50	22+00												

**WILLETT HOFMANN & ASSOCIATES INC.**  
 ENGINEERING ARCHITECTURE LAND SURVEYING  
 809 EAST 2ND STREET, DIXON, IL 61021-3367  
 T: 815-284-3381 DESIGN FIRM: #184-000918

DESIGNED - MICHAEL WAGNER	REVISED -
CHECKED - BRIAN CONVERSE	REVISED -
DRAWN - MICHAEL WAGNER	REVISED -
CHECKED - MEGAN CACKLEY	REVISED -

**BUREAU COUNTY**  
**T.R. 136 (1125 E. ST.) OVER FOX CREEK**  
**STATION 20+05**

<b>PLAN &amp; PROFILE</b>	
<b>STRUCTURE NO. 006-4235</b>	
SCALE: 1" = 20'-0"	SHEET NO. 1 OF 2 SHEETS
STA. 16+00.00 TO STA. 22+00.00	

TWP. 136	SECTION 10-16115-00-BR	COUNTY BUREAU	TOTAL SHEETS 21	SHEET NO. 5
WHA# 1286010		CONTRACT NO. 87498		ILLINOIS FED. AID PROJECT BR05-0011084