

DATE	
BY	
REVISIONS	
PLANNED	
NOTED	
NO.	

DATE	
BY	
REVISIONS	
PROFILING	
NOTED	
NO.	

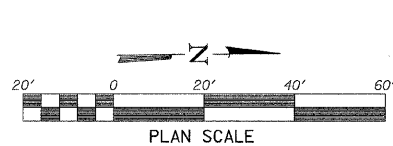

PT. #	STA.	N	E	EL.	DESCRIPTION
100	9.0' RT. 18+18.0	1657682.29	2441829.00	760.76	I.P.
101	10.6' LT. 22+25.7	1658090.01	2441813.40	751.93	I.P.

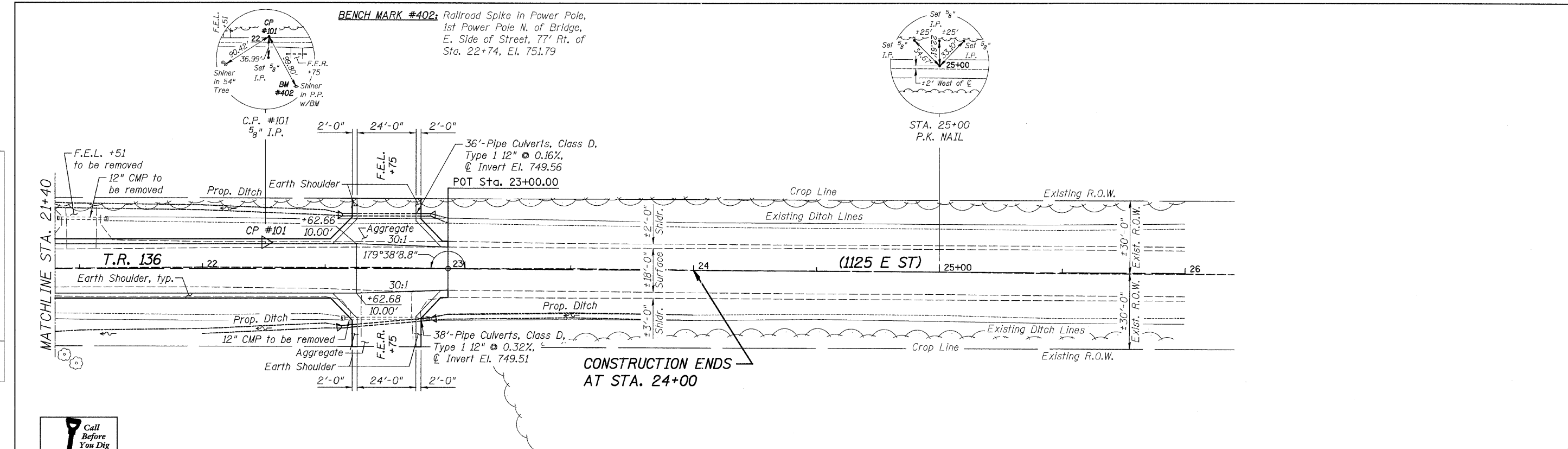
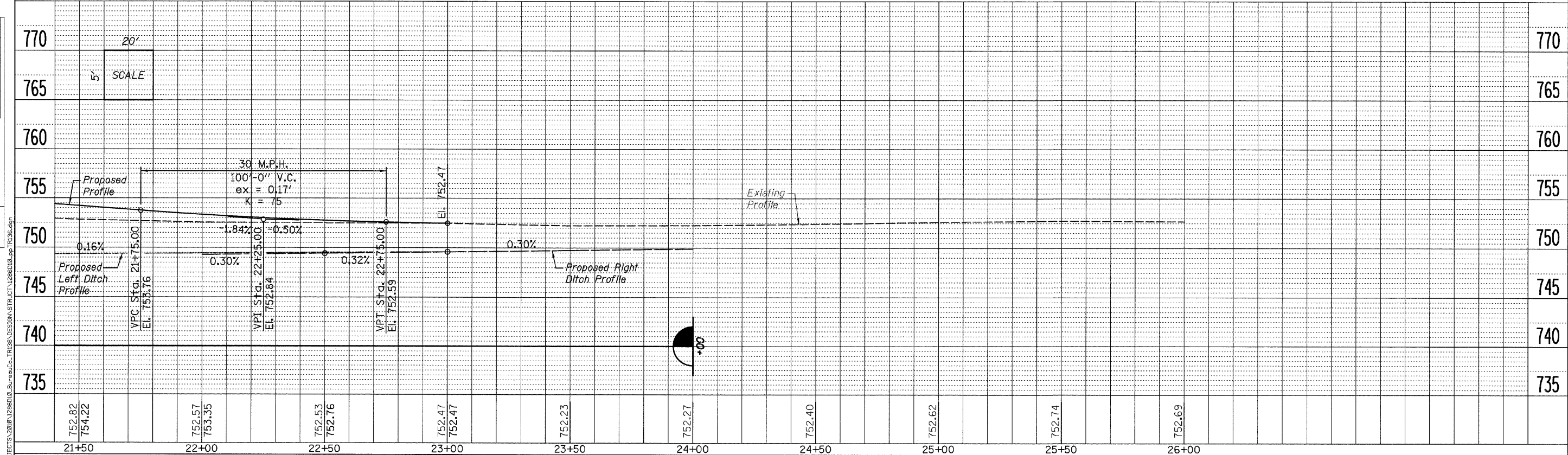

**WILLET HOFMANN & ASSOCIATES INC.**  
 ENGINEERING ARCHITECTURE LAND SURVEYING  
 839 EAST 120 STREET, DIXON, IL 61021 9367  
 T: 815-284-3381 DESIGN FIRM: #184-000918

DESIGNED - MICHAEL WAGNER	REVISED -
CHECKED - BRIAN CONVERSE	REVISED -
DRAWN - MICHAEL WAGNER	REVISED -
CHECKED - MEGAN CACKLEY	REVISED -

**BUREAU COUNTY**  
**T.R. 136 (1125 E. ST.) OVER FOX CREEK**  
**STATION 20+05**

**PLAN & PROFILE**  
**STRUCTURE NO. 006-4235**  
 SCALE: 1" = 20'-0" SHEET NO. 2 OF 2 SHEETS STA. 21+40.00 TO STA. 26+00.00

TWP. RTE.	SECTION	COUNTY	TOTAL SHEETS	SHEET NO.
136	10-16115-00-BR	BUREAU	21	6
WHA* 1286D10		CONTRACT NO. 87498		
ILLINOIS FED. AID PROJECT BROS-0011084				