

ROUTE NO.	SECTION	COUNTY	TOTAL SHEETS	SHEET NO.
FAS 316	12-00229-00-SP	IROQUOIS	5	1
JOB # C-93-047-12			PROJECT HS1P-0316(110)	

STATE OF ILLINOIS
DEPARTMENT OF TRANSPORTATION
DIVISION OF HIGHWAYS

RESURFACING PROJECT

IROQUOIS COUNTY
PLANS FOR PROPOSED FEDERAL AID PROJECT

SHEET NUMBER	DESCRIPTION
1	COVER SHEET -- LOCATION MAP
2	SUMMARY OF QUANTITIES, GENERAL NOTES MIXTURE TABLE
3	TYPICAL X-SECTIONS
4	PLAN VIEW
5	TYPICAL INTERSECTIONS & SUPER ELEVATION DATA

STANDARDS

- 000001-06 SYMBOLS AND ABBREVIATIONS
- 701901-02 TRAFFIC CONTROL DEVICES
- 780001-03 TYPICAL PAVEMENT MARKINGS
- BLR 21-9 TYPICAL APPLICATION OF TRAFFIC CONTROL DEVICES FOR CONSTRUCTION ON RURAL LOCAL HIGHWAYS

ROUTE: FAS 316, CH 23
SECTION: 12-00229-00-SP
PROJECT: HS1P-0316(110)
JOB No.: C-93-047-12

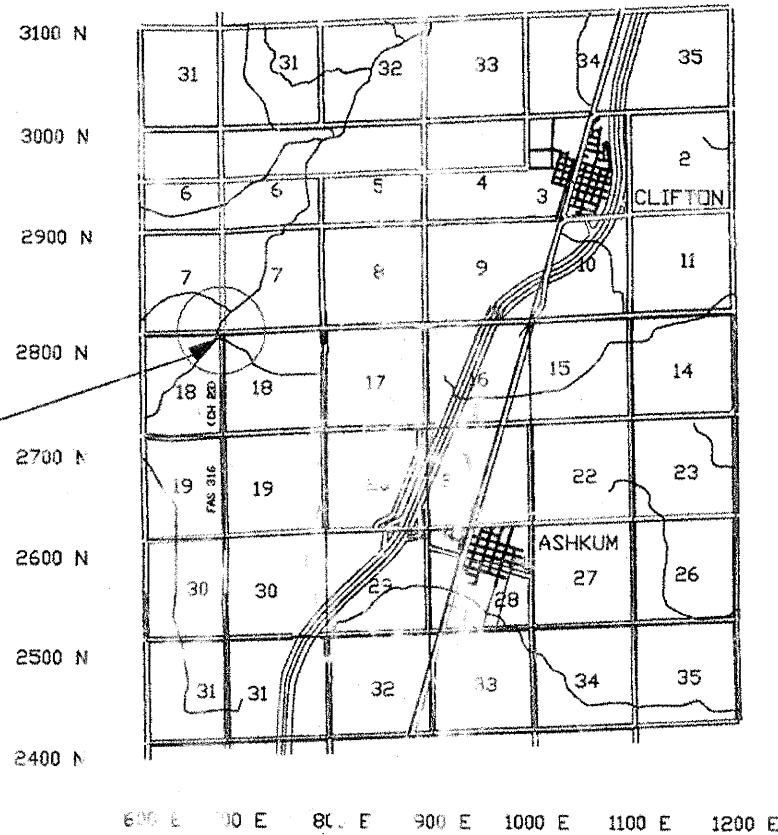
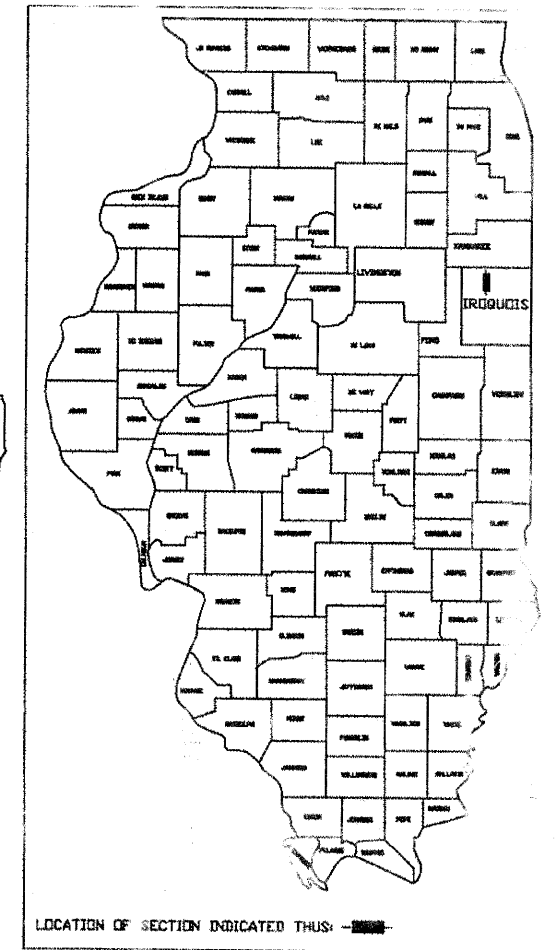

PROJECT LOCATION
IMPROVEMENT BEGINS STA. 7+00
IMPROVEMENT ENDS STA. 25+00
BRIDGE OMISSION STA. 12+97.88 TO 13+94.13
STRUCTURE # 038-3203

TRAFFIC DATA

FUNCTIONAL CLASSIFICATION: MINOR COLLECTOR
ADT = 350
SPEED LIMIT = 40 M. P. H.

JULIE
JOINT UTILITY LOCATION INFORMATION FOR EXCAVATION
1-800-892-0123

CONTRACT NO. 87517

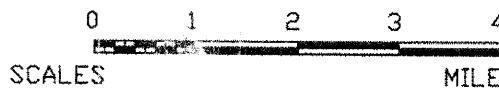

GROSS LENGTH OF IMPROVEMENT = 1,800.00 FT. = 0.341 MI.
NET LENGTH OF IMPROVEMENT = 1,703.75 FT. = 0.323 MI.
BRIDGE OMISSION LENGTH = 96.25 FT. = 0.018 MI.



THESE PLANS WERE PREPARED BY ME OR BY A FULL TIME MEMBER OF MY STAFF WORKING UNDER MY DIRECT SUPERVISION

Joel V. Moore
JOEL V. MOORE, COUNTY ENGINEER
ILL. REG. PROF. ENG. #62056831
DATE EXPIRES: 11/30/13

STATE OF ILLINOIS
DEPARTMENT OF TRANSPORTATION

Approved: Feb 14, 2012

Joel V. Moore
County Engineer

District: 02-21-12
Information: near

Special Bid: 02-21-12
Sealed: near

W. R. ...
Deputy Director of Highway

ROUTE NO.	SECTION	COUNTY	TOTAL SHEETS	SHEET NO.
FAS 316	12-00229-00-SP	IRROQUOIS	5	2
JOB # C-93-047-12			PROJECT HSIP-0316(110)	
CONTRACT 87517				

SUMMARY OF QUANTITIES				CONSTRUCTION CODE	0005
ITEM #	CODE #	ITEM	UNIT	QUANTITY	
1	40600100	BITUMINOUS MATERIALS (PRIME COAT)	GALLON	450	
* 2	40600625	LEVEL BINDER (MACHINE METHOD), N50	TON	500	
* 3	40600982	HOT-MIX ASPHALT SURFACE REMOVAL - BUTT JOINT	SQ YD	490	
* 4	40603310	HOT-MIX ASPHALT SURFACE COURSE MIX "C" N50	TON	375	
* 5	40800050	INCIDENTAL HOT-MIX ASPHALT SURFACING	TON	40	
* 6	48101200	AGGREGATE SHOULDERS, TYPE B	TON	1000	
7	67100100	MOBILIZATION	L SUM	1	
* 8	70101830	TRAFFIC CONTROL AND PROTECTION, STANDARD BLR 21	L SUM	1	
Δ 9	78001110	PAINT PAVEMENT MARKING - LINE 4"	FOOT	7,100	

* SEE SPECIAL PROVISIONS
Δ SPECIALTY ITEMS

GENERAL NOTES

THE THICKNESS OF HOT-MIX ASPHALT MIXTURES SHOWN ON THE TYPICAL X-SECTION IS THE NOMINAL THICKNESS. DEVIATIONS FROM THE NOMINAL THICKNESS WILL BE PERMITTED WHEN SUCH DEVIATIONS OCCUR DUE TO IRREGULARITIES IN THE EXISTING SURFACE.

THE ENGINEER SHALL BE THE SOLE JUDGE CONCERNING CURING TIME FOR THE VARIOUS HOT-MIX ASPHALT LIFTS.

FOR ALL PAVEMENT MARKINGS ON FINAL SURFACES (I.E., MAINLINE PAVEMENT), ONLY TEMPORARY PAVEMENT MARKING TAPE SHALL BE USED.

ANY REFERENCE TO A STANDARD IN THESE PLANS SHALL BE INTERPRETED TO MEAN THE EDITION AS INDICATED BY THE SUB-NUMBER LISTED IN THE INDEX OF SHEETS OR THE COPY OF THE STANDARD INCLUDED IN THESE PLANS.

SECTION NOTES

THE PROPOSED IMPROVEMENT CONSISTS OF A HOT MIX ASPHALT SURFACE COURSE INCLUDING LEVELING BINDER, SHOULDER STONE AND ALL WORK NECESSARY TO COMPLETE THE PROJECT ACCORDING TO THE PLANS AND SPECIFICATIONS.

STRUCTURE # 038-3203 AND APPROACHES ON COUNTY HIGHWAY 23 WERE CONSTRUCTED UNDER SECTION (229B-MFT IN 1973).

THE FOLLOWING RATES OF APPLICATION HAVE BEEN ASSUMED IN CALCULATING PLAN QUANTITIES:	
GRANULAR MATERIALS	2.05 TONS/CU YD
BITUMINOUS MATERIALS PRIME COAT	0.05 GAL/SQ YD
HOT MIX ASPHALT SURFACE COURSE	112 LBS/SQ YD/INCH
LEVELING BINDER (MACHINE METHOD)	112 LBS/SQ YD/INCH
PAINT PAVEMENT MARKING - LINE 4"	10FT/40 FT OF APPLICATION

STRUCTURAL OVERLAY

FLEXIBLE PAVEMENT OVERLAY DESIGN FOR CLASS IV ROAD
DESIGN PERIOD D. P. = 20 YEARS
DESIGN YEAR = 2021 PV=88% SU=7% MU=5%
STRUCTURAL DESIGN TRAFFIC = 350 TRAFFIC FACTOR = 0.13
IBV = 2.50 D_o = 3.00

MIXTURE TABLE

	HMA LEVEL BINDER	HMA SURFACE
PG GRADE	PG64-22	PG64-22
DESIGN AIR VOIDS	4.0% @ N50	4.0% @ N50
MIXTURE COMPOSITION	IL 9.5	IL 9.5
FRICTION AGGREGATE		MIXTURE C
DENSITY TEST METHOD	GROWTH CURVE	GROWTH CURVE

HOT-MIX ASPHALT SURFACE REMOVAL - BUTT JOINT

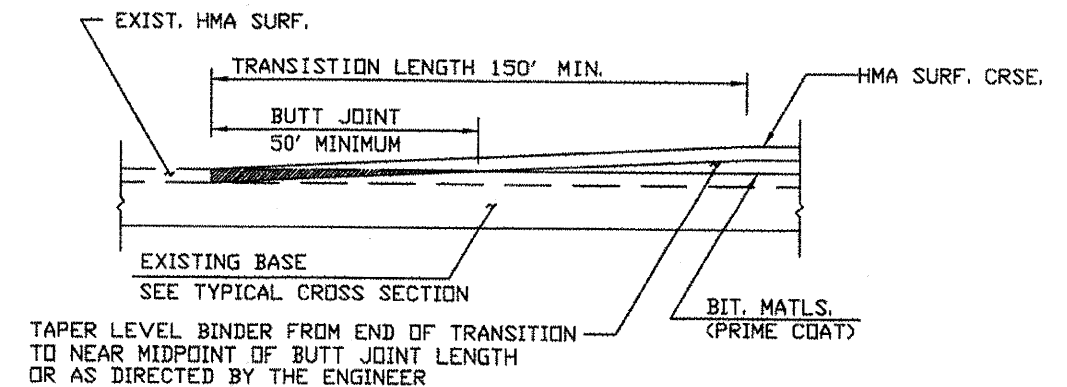

ROUTE NO.	SECTION	COUNTY	TOTAL SHEETS	SHEET NO.
FAS 316	12-00229-00-SP	IRROQUOIS	5	3
JOB # C-93-047-12		PROJECT HSIP-0316(110)		
CONTRACT 87517				

EXISTING TYPICAL SECTION

STATION 7+00 TO 12+98
STATION 13+94 TO 25+00

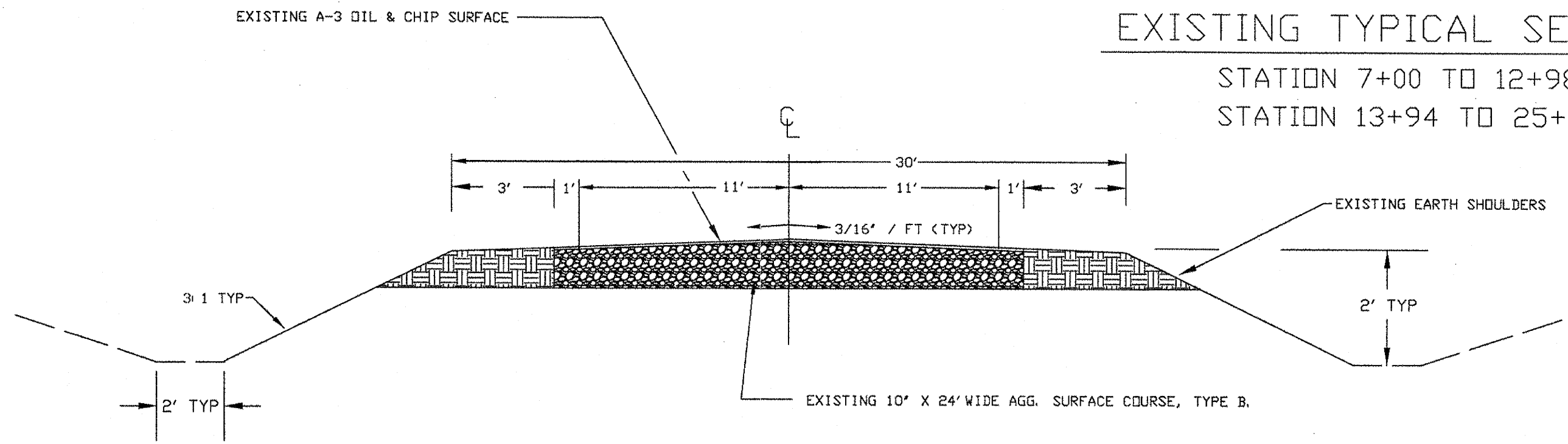

* SUPER-ELEVATION AT 0.08

STA 9+47 TO 10+49
STA 14+54 TO 17+59
STA 21+63.50 TO 22+60

PROPOSED TYPICAL SECTION

STATION 7+00 TO 12+98
STATION 13+94 TO 25+00

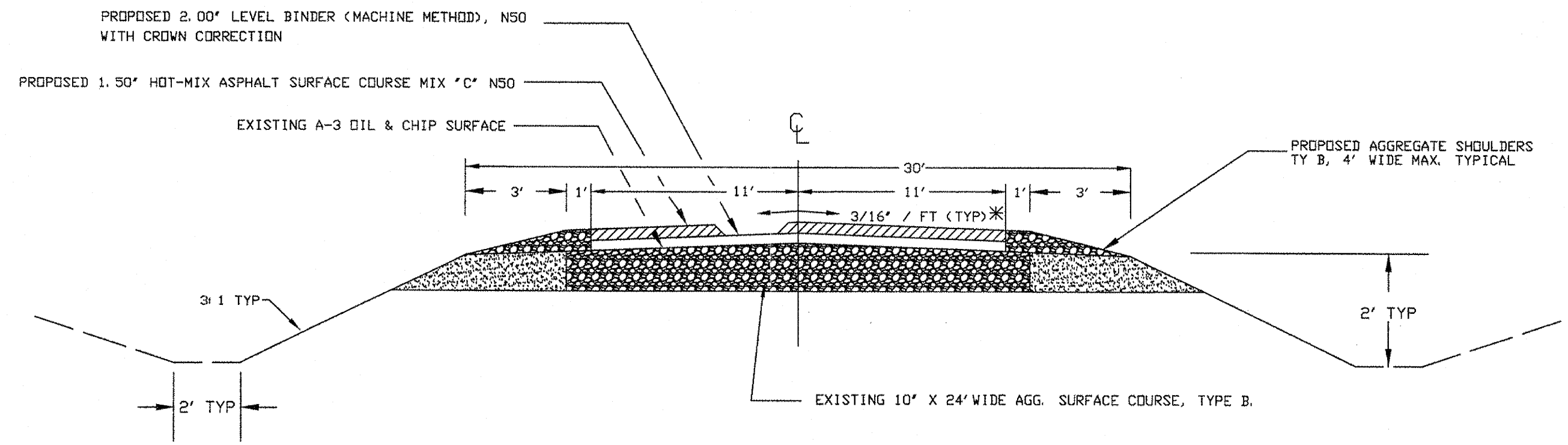

ROUTE NO.	SECTION	COUNTY	TOTAL SHEETS	SHEET NO.
FAS 316	12-00229-00-SP	IRROQUOIS	5	4
JOB # C-93-047-12			PROJECT HSIP-0316(110)	
CONTRACT 87517				

PLAN VIEW

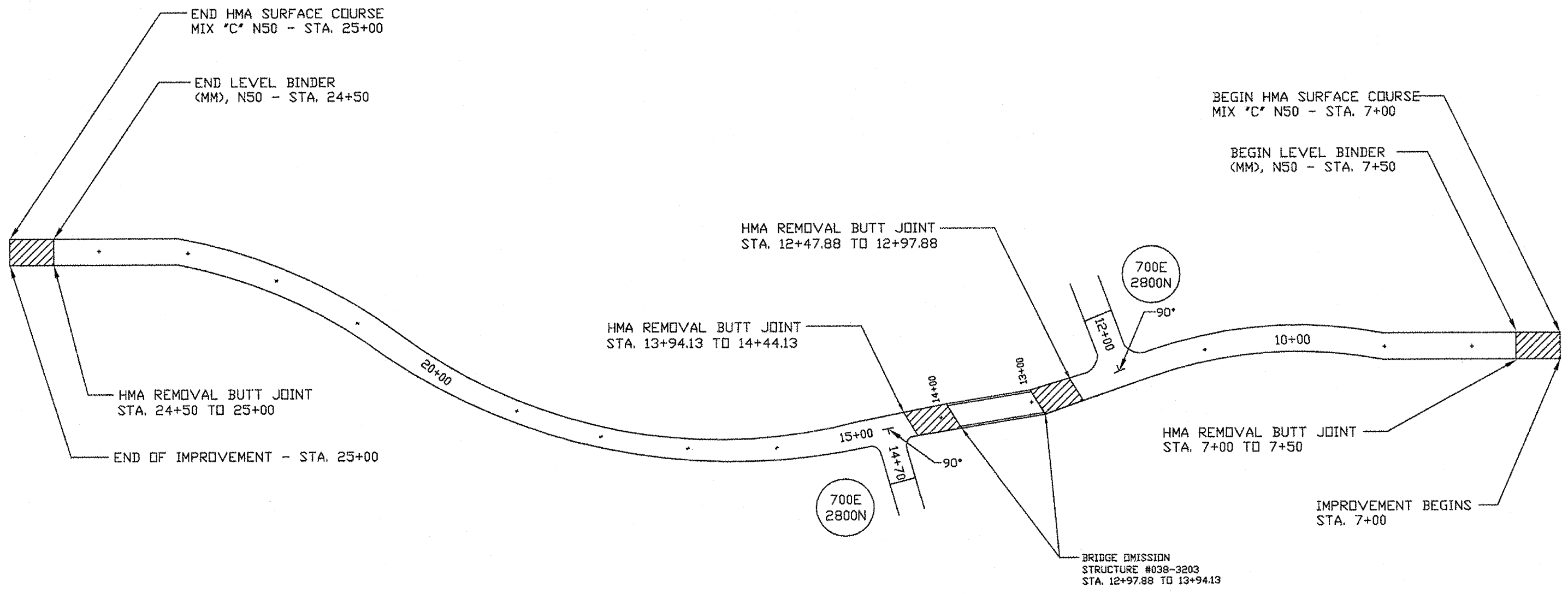
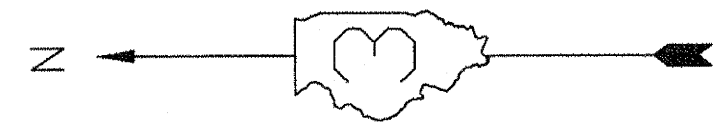

HMA REMOVAL BUTT JOINT 

NOTE: ALL SIDE ROAD INTERSECTIONS SHALL BE PAID FOR AS INCIDENTAL HOT-MIX ASPHALT SURFACING = TOTAL 40 TON

NOTE: AGGREGATE AROUND ALL SIDE ROAD INTERSECTIONS SHALL BE PAID FOR AS AGGREGATE SHOULDERS, TYPE B AND PLACED AS DIRECTED BY THE ENGINEER.

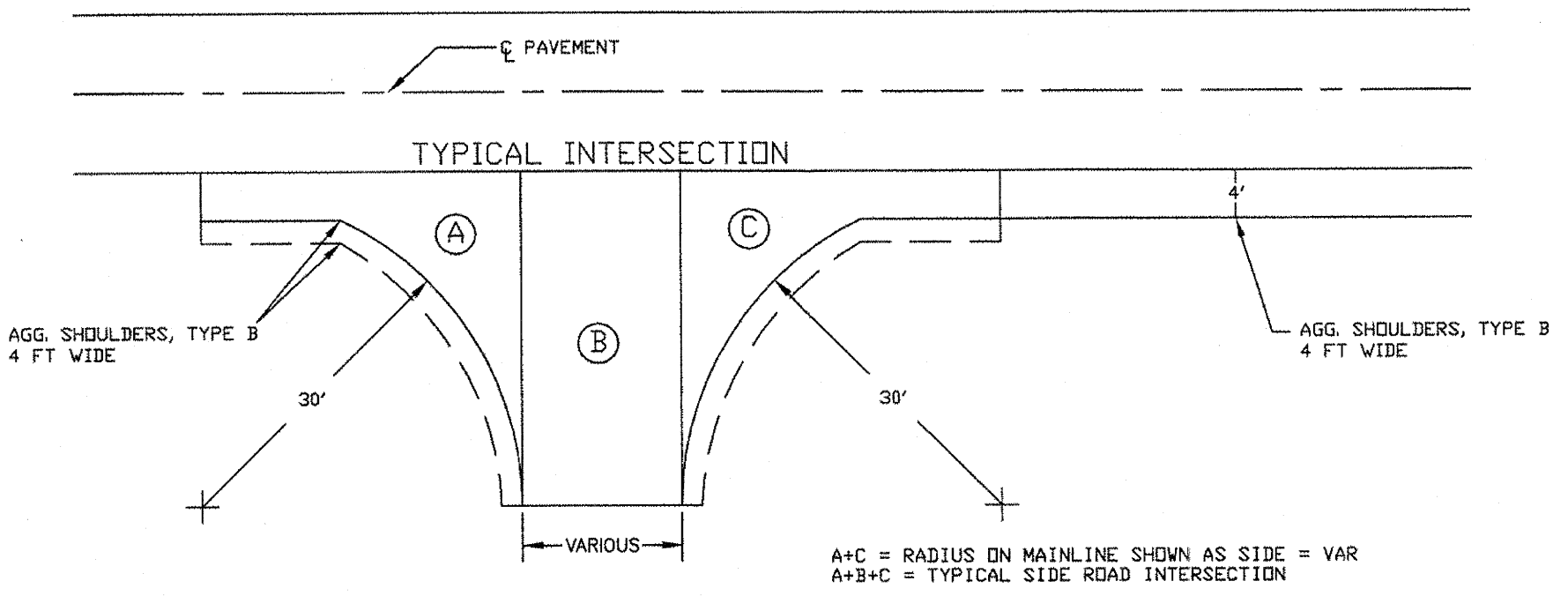

TYPICAL INTERSECTION - SIDE ROADS

STATION	SIDE	WIDTH	SQ. YD.	TON
12+00	2800N 700E RT	20'	240	20
14+75	2800N 700E LT	20'	240	20
TOTALS = 40 TONS				

CURVE #1 DATA

P.I.	10+00
D	12°- 00'
R	477.50'
T	109.00'
L	214.30'
E	12.28'
P.C.	8+91
P.T.	11+05.30

BEGIN S.E.	7+79
FULL S.E.	9+47
FULL S.E.	10+49
END S.E.	12+17
SUPER ELEVATION = 8%	

CURVE #2 DATA

P.I.	16+20.78
D	12°- 00'
R	477.50'
T	222.83'
L	416.94'
E	49.44'
P.C.	13+97.95
P.T.	18+14.89

BEGIN S.E.	12+86
FULL S.E.	14+54
FULL S.E.	17+59
END S.E.	19+27
SUPER ELEVATION = 8%	

CURVE #3 DATA

P.I.	22+13.38
D	12°- 00'
R	477.50'
T	105.86'
L	208.33'
E	11.59'
P.C.	21+07.52
P.T.	23+15.85

BEGIN S.E.	19+95.50
FULL S.E.	21+63.50
FULL S.E.	22+60
END S.E.	24+28
SUPER ELEVATION = 8%	