

ROUTE NO.	SECTION	COUNTY	TOTAL SHEETS	THIS SHEET
F.A.U. 6728	*	TAZEWELL	28	11

FED. RD. DIST. NO. 7 ILLINOIS PROJECT TE-004(110)
*10-00109-00-BT
CONTRACT NO. 89598

CURVE #11
 PI Sta = 136+58.97
 $\Delta = 22^{\circ}-59'-00''$
 T = 50.83
 R = 250.00
 L = 100.28
 E = 5.11

NOTE:
 ST. CLARE COURT INTERSECTION
 WILL NOT BE ALTERED EXCEPT
 FOR THERMOPLASTIC MARKINGS
 AND SAWCUTTING CURB & GUTTER.

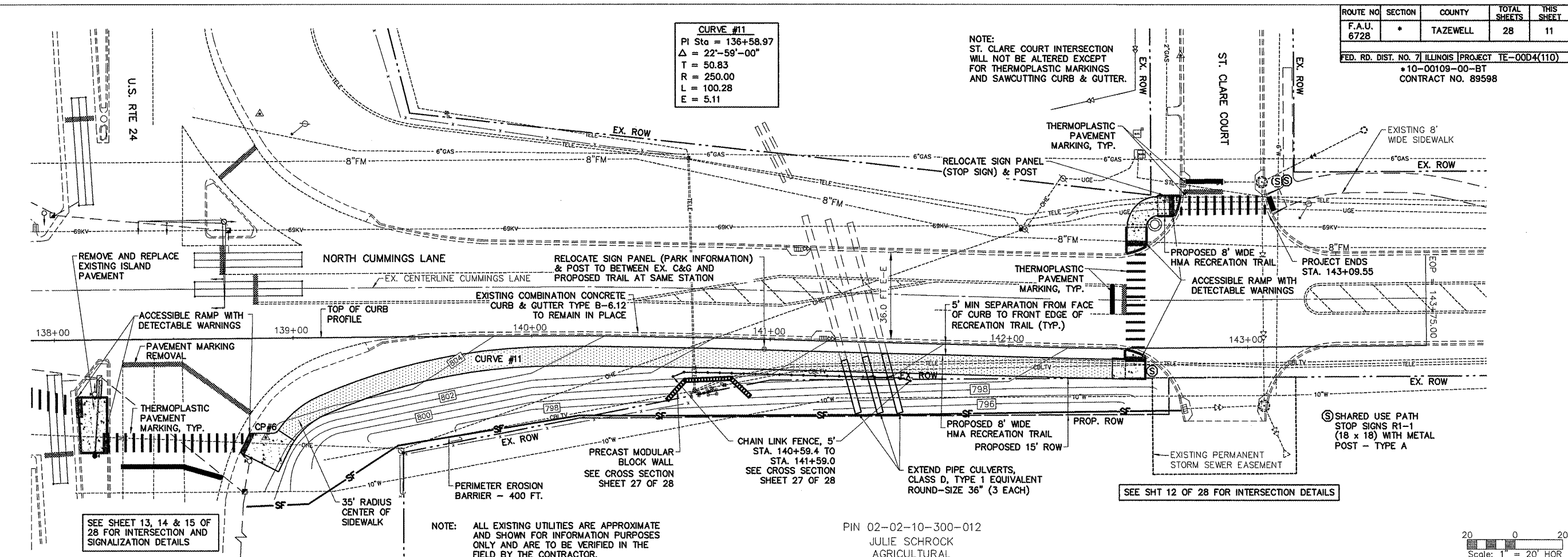

SEE SHEET 13, 14 & 15 OF 28 FOR INTERSECTION AND SIGNALIZATION DETAILS

NOTE: ALL EXISTING UTILITIES ARE APPROXIMATE AND SHOWN FOR INFORMATION PURPOSES ONLY AND ARE TO BE VERIFIED IN THE FIELD BY THE CONTRACTOR.

PIN 02-02-10-300-012
 JULIE SCHROCK
 AGRICULTURAL

SEE SHT 12 OF 28 FOR INTERSECTION DETAILS

CP#6 - SET NAIL
 RT. 41.05 STA. 138+88.09
 N = 5555.07
 E = 7991.41
 ELEV. = 804.12

