

T.P. RTE.	SECTION	COUNTY	TOTAL SHEETS	SHEET NO.
307A	08-04118-00-BR	CHRISTIAN	26	1
FED. ROAD DIST. NO.		ILLINOIS	CONTRACT NO. 93567	

# STATE OF ILLINOIS DEPARTMENT OF TRANSPORTATION DIVISION OF HIGHWAYS PLANS FOR PROPOSED LOCAL AGENCY IMPROVEMENTS HIGHWAY BRIDGE PROGRAM

SHEET NO.	DESCRIPTION
1	COVER SHEET
2	SUMMARY OF QUANTITIES, GENERAL NOTES AND CENTERLINE TIES
3	SCHEDULE OF QUANTITIES
4	TYPICAL SECTIONS
5	ROADWAY PLAN AND PROFILE
6	EROSION CONTROL PLAN
7 - 8	RIGHT OF WAY PLAN
9 - 18	BRIDGE PLANS
19 - 26	CROSS SECTIONS



LOCATION OF SECTION INDICATED THUS: - ■ -

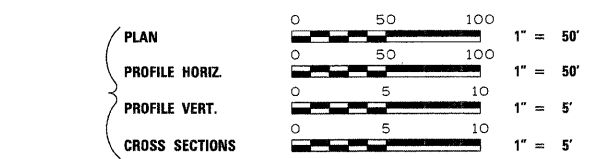

## TR ROUTE 307A SECTION 08-04118-00-BR CHRISTIAN COUNTY GREENWOOD ROAD DISTRICT PROJECT BROS-0021(178) JOB NUMBER C-96-225-10

STANDARDS	
000001-06	STANDARD SYMBOLS, ABBREVIATIONS AND PATTERNS
280001-06	TEMPORARY EROSION CONTROL SYSTEMS
515001-03	NAME PLATE FOR BRIDGE
630301-05	SHOULDER WIDENING FOR TYPE 1 (SPECIAL) GUARDRAIL TERMINALS
635006-03	REFLECTOR AND TERMINAL MARKER PLACEMENT
701901-02	TRAFFIC CONTROL DEVICES
BLR 21-9	TYPICAL APPLICATION OF TRAFFIC CONTROL DEVICES FOR CONSTRUCTION ON RURAL LOCAL HIGHWAYS
BLR 26-3	STEEL PLATE BEAM GUARDRAIL (27 1/2" HGT)
BLR 27-1	TRAFFIC BARRIER TERMINAL TYPE 5A

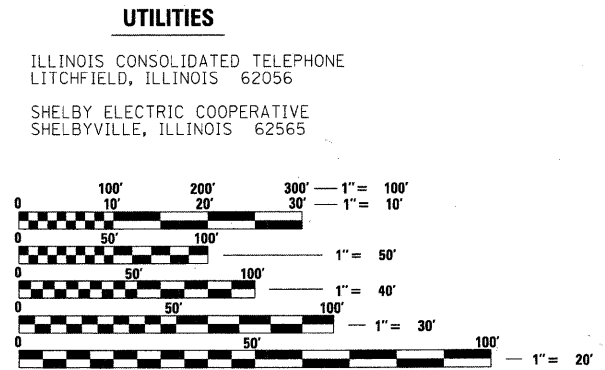

FULL SIZE PLANS HAVE BEEN PREPARED USING STANDARD ENGINEERING SCALES. REDUCED SIZED PLANS WILL NOT CONFORM TO STANDARD SCALES. IN MAKING MEASUREMENTS ON REDUCED PLANS, THE ABOVE SCALES MAY BE USED.

J.U.L.I.E.  
JOINT UTILITY LOCATION INFORMATION FOR EXCAVATION  
1-800-892-0123  
OR 811

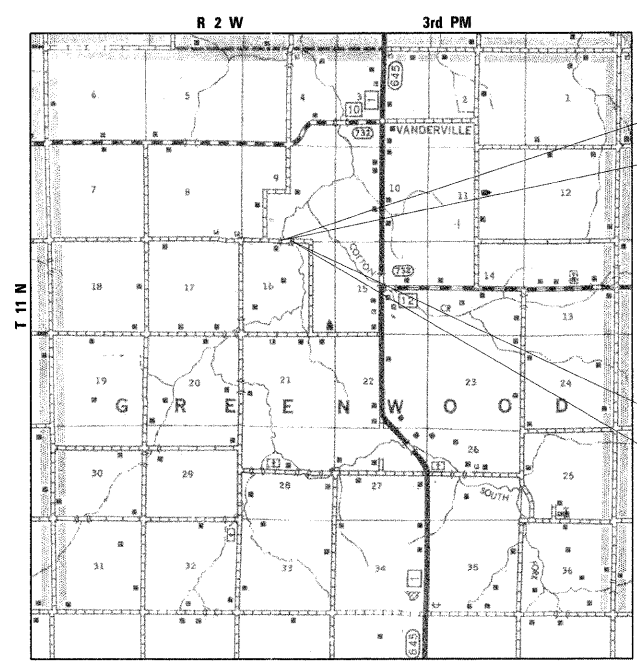

LOCATION MAP

NET LENGTH OF PROJECT = 1300.00 FEET = 0.246 MILES

### DESIGN DESIGNATION

LOCAL ROAD: ADT < 150  
DESIGN SPEED: 30 MPH

STA. 11+00.00  
BEGIN IMPROVEMENTS  
SECTION 08-04118-00-BR

EXISTING STRUCTURE NO. 011-3247  
EXISTING 61' X 14' SINGLE SPAN PONY TRUSS BRIDGE

PROPOSED STRUCTURE NO. 011-3417  
THREE SPAN PPC DECK BEAM BRIDGE ON REINFORCED CONCRETE  
SPILL THRU ABUTMENTS AND CONCRETE ENCASED PILE BENT PIERS.  
105'-0" BACK TO BACK ABUTMENTS, 24'-0" OUT TO OUT DECK

STA. 24+00.00  
END IMPROVEMENTS  
SECTION 08-04118-00-BR

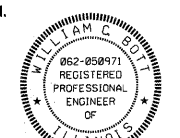
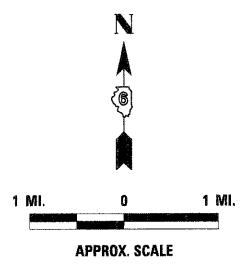

Willie C. Burt 12/15/2011  
EXPIRES: 11/30/13

APPROVED	<i>Chris D. Fung</i>	12/16	20 11
	COUNTY ENGINEER		
APPROVED	<i>John Ligister</i>	12/16	20 11
	ROAD COMMISSIONER		
PASSED	<i>Tenence H. Fountain</i>	February 17	20 12
	DISTRICT SIX ENGINEER OF LOCAL ROADS & STREETS		
PASSED	<i>Ron Dehanbean</i>	February 17	20 12
	DISTRICT SIX ENGINEER OF CONSTRUCTION		
Releasing For Bid Based on Limited Review	<i>Roger L. Driskell</i>	February 17	20 12
	DEPUTY DIRECTOR OF HIGHWAYS, REGION FOUR ENGINEER		
	STATE OF ILLINOIS DEPARTMENT OF TRANSPORTATION		

**PRINTED BY THE AUTHORITY OF THE STATE OF ILLINOIS**

PROJECT ENGINEER  
PROJECT MANAGER

CONTRACT NO. 93567

