

FAS RTE.	SECTION	COUNTY	TOTAL SHEETS	SHEET NO.
656	09-00271-00-RS	SHELBY	62	1

CONTRACT NO. 95670
NEOGA ROAD PROJECT

STATE OF ILLINOIS DIVISION OF HIGHWAYS PLANS FOR PROPOSED SURFACE TRANSPORTATION PROGRAM RURAL

SECTION 09-00271-00-RS
SHELBY COUNTY
FAS ROUTE 656
PROJECT NO. RS-0656(112)
JOB NO. C-97-031-12
NEOGA ROAD PROJECT

INDEX OF SHEETS

FOR INDEX OF
PLAN SHEETS SEE
SHEET NUMBER 2 OF
62 SHEETS

HIGHWAY STANDARDS

FOR LIST OF
HIGHWAY STANDARDS
SEE SHEET NUMBER 2
OF 62 SHEETS

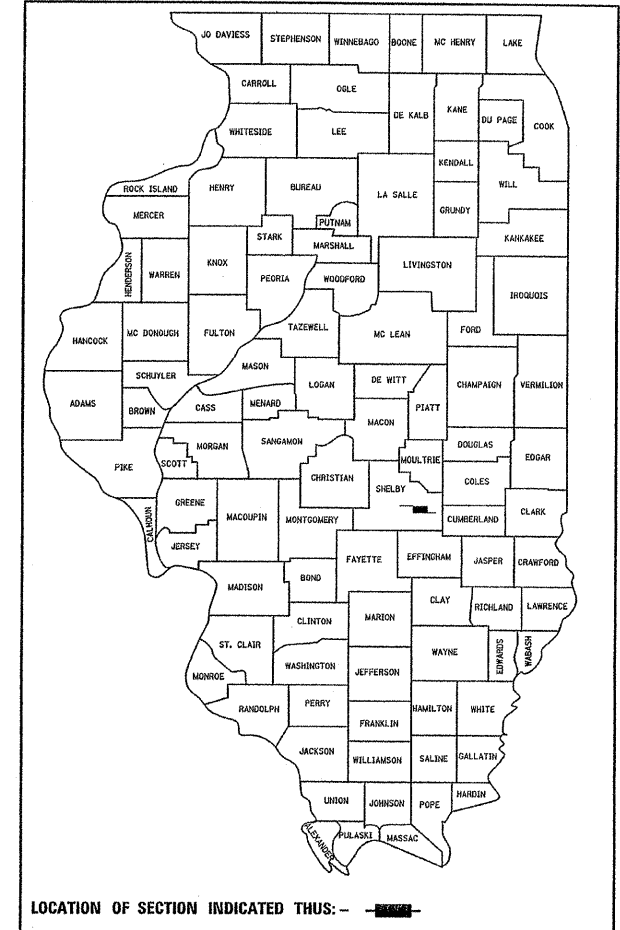

BEGIN PROJECT
STA 8 + 75.50

STA EQUATION
STA 90 + 00 BK =
STA 75 + 05.45AH

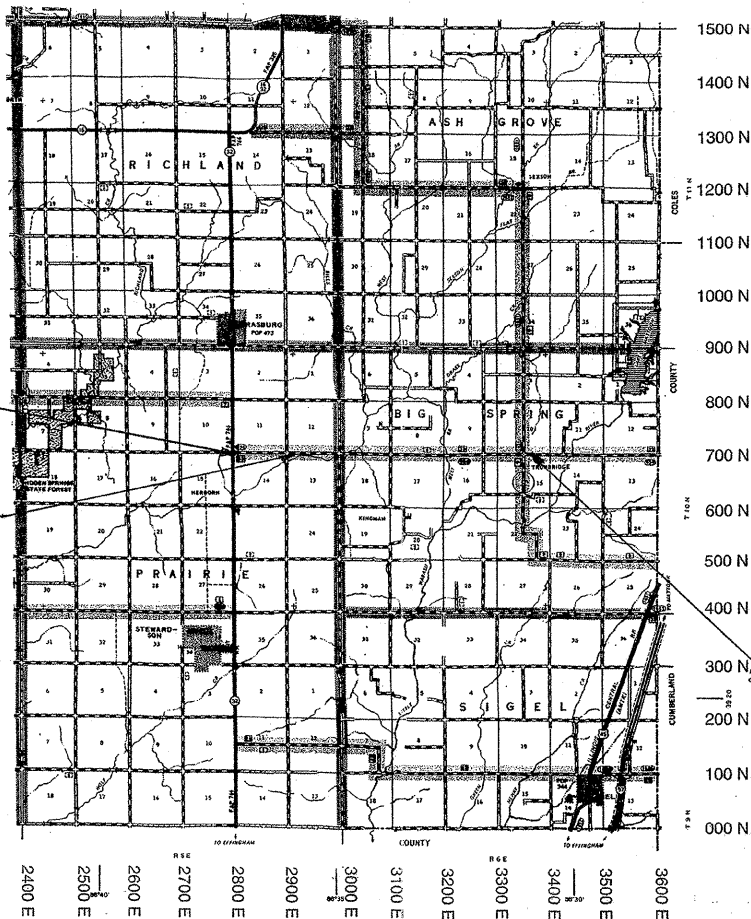

END PROJECT
STA 290 + 00

DESIGN INFORMATION

DESIGN CLASSIFICATION: COLLECTOR
CURRENT ADT: 900
DESIGN YEAR ADT: 1150
DESIGN YEAR: 2030
DESIGN SPEED 50 M.P.H.

PROJECT LOCATION MAP
29619.05 FEET = 5.61 MILES = NET LENGTH OF SECTION

PLANS PREPARED BY:

J.U.L.I.E.
JOINT UTILITY LOCATION INFORMATION FOR EXCAVATION
1-800-892-0123 (TOLL FREE)

PLANS PREPARED BY:
SHELBY CO HWY DEPT
R. R. 3 BOX 38A
SHELBYVILLE IL 62565
217-774-2721



S. Alan Spesard
S. ALAN SPESARD, COUNTY ENGINEER, PE
ILLINOIS PROFESSIONAL ENGINEER 062-052965
EXPIRES 11-30-2013

DATE
1-11-2012

APPROVED *S. Alan Spesard* 1-11-2012
COUNTY ENGINEER, SHELBY COUNTY

PASSED *Manuel Castell* 3-6-2012
District Seven Engineer of
Local Roads and Streets

RELEASING FOR
BID BASED ON
LIMITED REVIEW *Roger L. Dinschell* 3-6-2012
DEPUTY DIRECTOR OF HIGHWAYS, REGION 4 ENGINEER

STATE OF ILLINOIS
DEPARTMENT OF TRANSPORTATION

CONTRACT NO. 95670