

STATE OF ILLINOIS
 DEPARTMENT OF TRANSPORTATION
 DIVISION OF HIGHWAYS
 PLANS FOR PROPOSED
 STU AND EDP PROJECT
 SECTION 10-00054-00-PV CITY OF FLORA
 JOB NO. C-97-072-12
 PROJECT NO. M-5023(011)
 WORTHY STREET - F.A.U. 8526

ROUTE	SECTION	CITY	TOTAL SHEETS	SHEET NO.
F.A.U. 8526	10-00054-00-PV	FLORA	34	1
CONTRACT NO. 95672		ILLINOIS	PROJECT M-5023(011)	

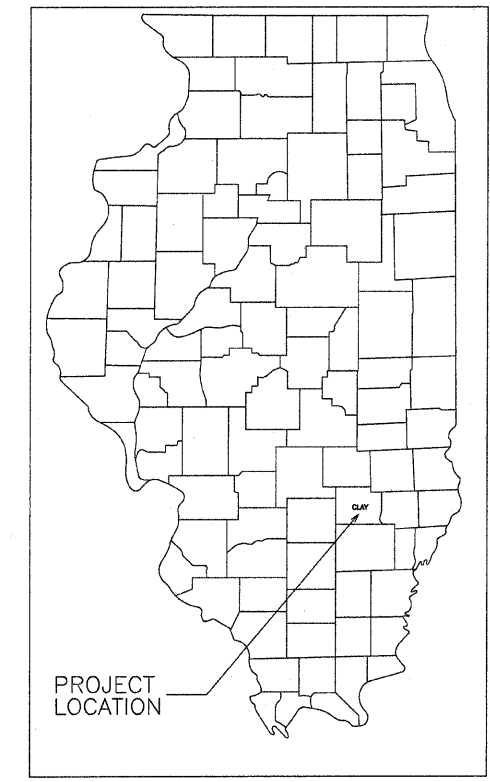

INDEX OF SHEETS

SHEET	ITEM
1	COVER SHEET
2	TYPICAL SECTIONS
3	SUMMARY OF QUANTITIES
4-6	DRAINAGE STRUCTURES / STORM SEWER
7-11	PLAN & PROFILE
12-14	INTERSECTION DETAILS
15-16	EROSION CONTROL
17, 17A, 17B	PUMP STATION DETAIL
18-34	CROSS SECTIONS
	STANDARD 000001-06
	STANDARD 280001-06
	STANDARD 420001-07
	STANDARD 424001-06
	STANDARD 424011
	STANDARD 424021
	STANDARD 424026
	STANDARD 602301-03
	STANDARD 602306-03
	STANDARD 602401-03
	STANDARD 602406-05
	STANDARD 602601-02
	STANDARD 602701-02
	STANDARD 604001-03
	STANDARD 604006-04
	STANDARD 604011-04
	STANDARD 604036-02
	STANDARD 604086-02
	STANDARD 606001-04
	STANDARD 701006-03
	STANDARD 701301-04
	STANDARD 701311-03
	STANDARD 701501-06
	STANDARD 701801-05
	STANDARD 701901-02
	STANDARD 780001-03
	STANDARD BLR 10-6
	STANDARD BLR 21-9
	STANDARD BLR 22-7

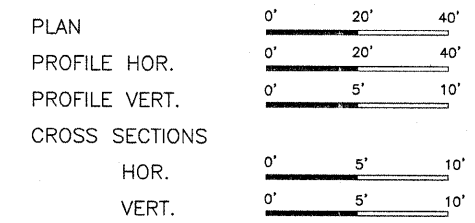

Joint Utility Locating Information for Excavators
 JULIE 1-800-892-0123

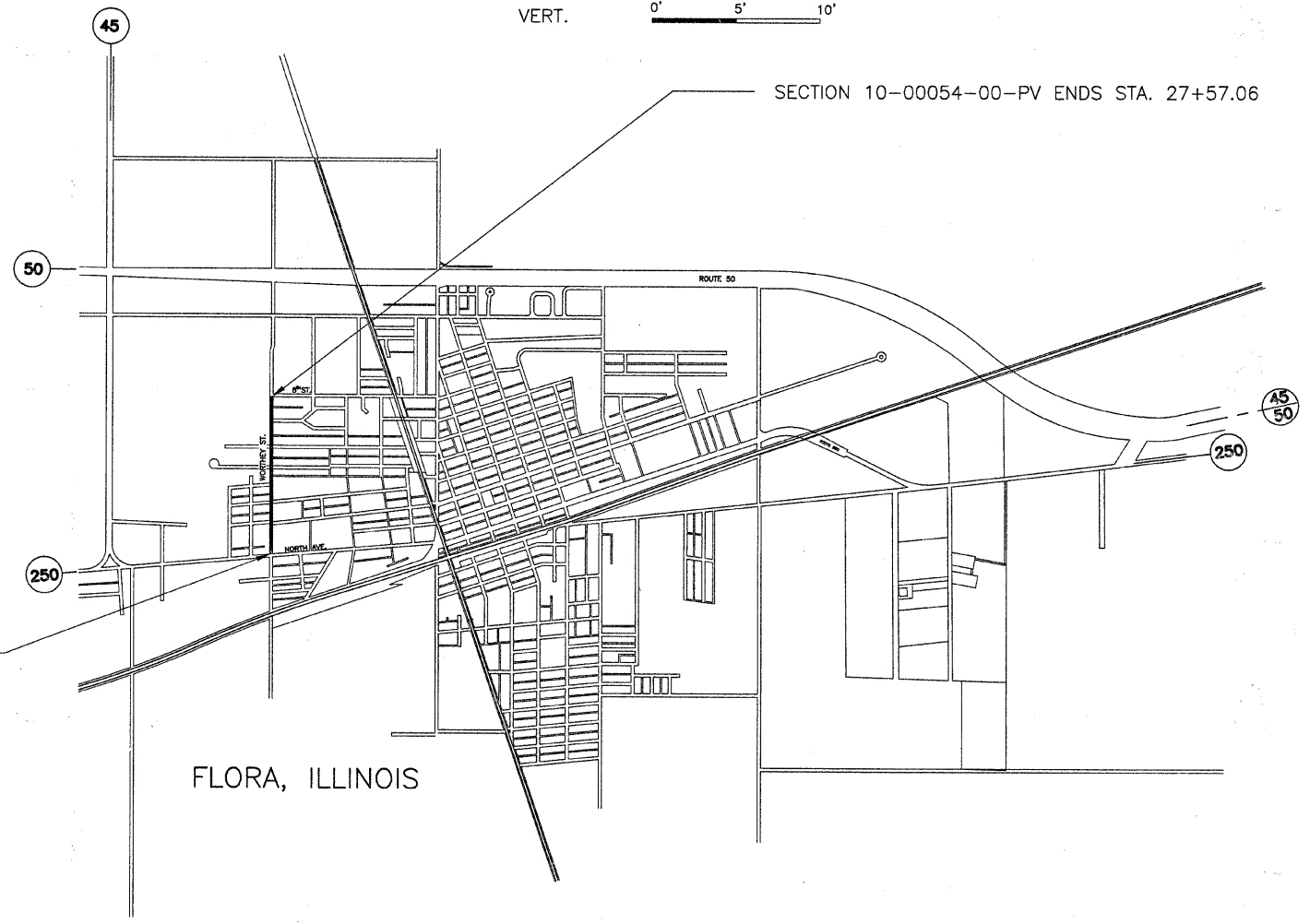

REVISED 4-18-12
 SECTION 10-00054-00-PV BEGINS STA. 1+08.73

CONTRACT NO. 95672
 URBAN COLLECTOR
 ADT = 2075
 DESIGN SPEED = 30 M.P.H.

NET LENGTH SECTION 10-00054-00-PV = 2648.33 FEET = 0.502 MILE

Tom A. Charleston
 Ill. Reg. Prof. Eng. # 29178
 Lic. Expires 11/30/13



CHARLESTON ENGINEERING, INC.
 CONSULTING ENGINEERS
 105 NORTH KITCHELL
 P.O. BOX 397
 OLNEY, ILLINOIS 62450
 (618) 392-0736
 ILLINOIS DEPARTMENT OF PROFESSIONAL REGULATION REGISTRATION #184.003513

APPROVED 1-9 2012
Bob Dickel
 MAYOR - CITY OF FLORA

STATE OF ILLINOIS
 DEPARTMENT OF TRANSPORTATION
 PASSED 1-19 2012
Maureen Kavel
 DISTRICT SEVEN ENGINEER OF
 LOCAL ROADS AND STREETS

Releasing For
 Bid Based on
 Limited Review
1-19 2012
Tom A. Charleston
 DEPUTY DIRECTOR OF HIGHWAYS
 REGION FOUR ENGINEER