

FINAL SURVEY	DATE
SURVEYED	BY
PLOTTED	
TEMPLATE	
NOTE BOOK	
NO.	
AREAS CHECKED	

ORIGINAL SURVEY	DATE
SURVEYED	BY
PLOTTED	
TEMPLATE	
NOTE BOOK	
NO.	
AREAS CHECKED	

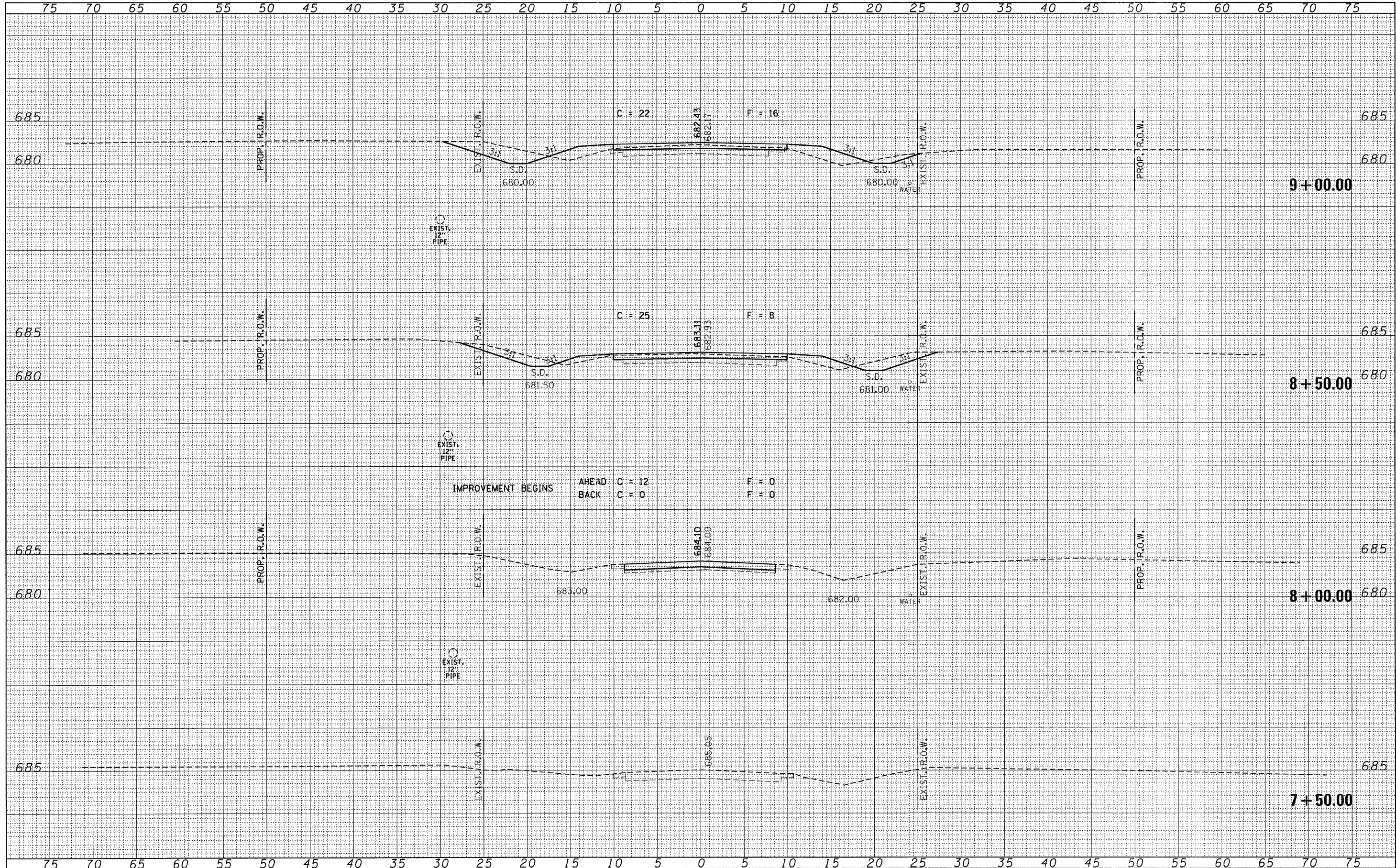

IMPROVEMENT BEGINS
 AHEAD C = 12 F = 0
 BACK C = 0 F = 0

FILE NAME = 078342-sht-xs.dgn	USER NAME =	DESIGNED - J.W.F.	REVISED -	STATE OF ILLINOIS MOULTRIE COUNTY HIGHWAY DEPARTMENT	STATION CROSS SECTIONS C.H. 9			F.A.S.	SECTION	COUNTY	TOTAL SHEETS	SHEET NO.
HAMPTON, LENZINI AND RENWICK, INC. 3000 STEVENSON DRIVE, SUITE 201 SPRINGFIELD, ILLINOIS 62761		DRAWN - D.T.M.	REVISED -		554	07-00066-00-BR	MOULTRIE	14	6			
HLR ILLINOIS PROFESSIONAL DESIGN FIRM LS / PE / SE CORP. 184-003959	PLOT SCALE =	CHECKED - S.W.M.	REVISED -		SCALE: H5:V5			SHEET NO. OF SHEETS STA. 7+50.00 TO STA. 9+00.00			CONTRACT NO. 95681	
	PLOT DATE = 2/9/2012	DATE - 02/09/12	REVISED -		ILLINOIS FED. AID PROJECT BR5-05543251							