

MATCHLINE - SEE PREVIOUS SHEET

JO020

NOTES

1. SEE AIRFIELD LIGHTING NOTES SHEET 12.

LEGEND

- EXISTING PAVEMENT
- PROPOSED PAVEMENT
- EXISTING BUILDING
- EXISTING ELECTRICAL DUCT
- PROPOSED ELECTRICAL DUCT
- EXISTING ELECTRICAL CABLES
- EXISTING ELECTRIC
- EXISTING ELECTRIC UTILITY PRIMARY
- PROPOSED 1/C #8 AWG, FAA L-824, 5000 VOLT TYPE C UG CABLE IN UNIT DUCT
- PROPOSED 4-1/C #6 AWG, XLP-USE 600 VOLT UG CABLE IN UNIT DUCT
- PROPOSED STAKE MOUNTED TAXIWAY LIGHT
- PROPOSED BASE MOUNTED TAXIWAY LIGHT
- PROPOSED STAKE MOUNTED RUNWAY LIGHT
- PROPOSED BASE MOUNTED RUNWAY LIGHT
- PROPOSED STAKE MOUNTED THRESHOLD LIGHT
- PROPOSED BASE MOUNTED THRESHOLD LIGHT
- PROPOSED TAXI GUIDANCE SIGN
- EXISTING ELECTRICAL STRUCTURE (HANDHOLE, SPLICE CAN)
- PROPOSED ELECTRICAL STRUCTURE (MANHOLE, HANDHOLE, SPLICE CAN)
- EXISTING ELECTRICAL MARKER (DUCT MARKER, CABLE MARKER)
- PROPOSED WIND CONE
- EXISTING STORM INLET/MANHOLE
- EXISTING STORM SEWER
- EXISTING GAS
- EXISTING FENCE
- COORDINATE LOCATION
- BENCHMARK LOCATION

MATCHLINE - SEE NEXT SHEET

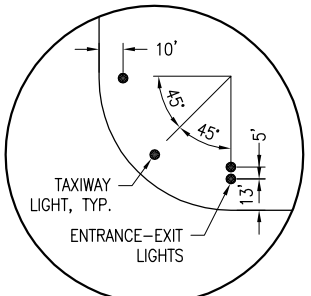
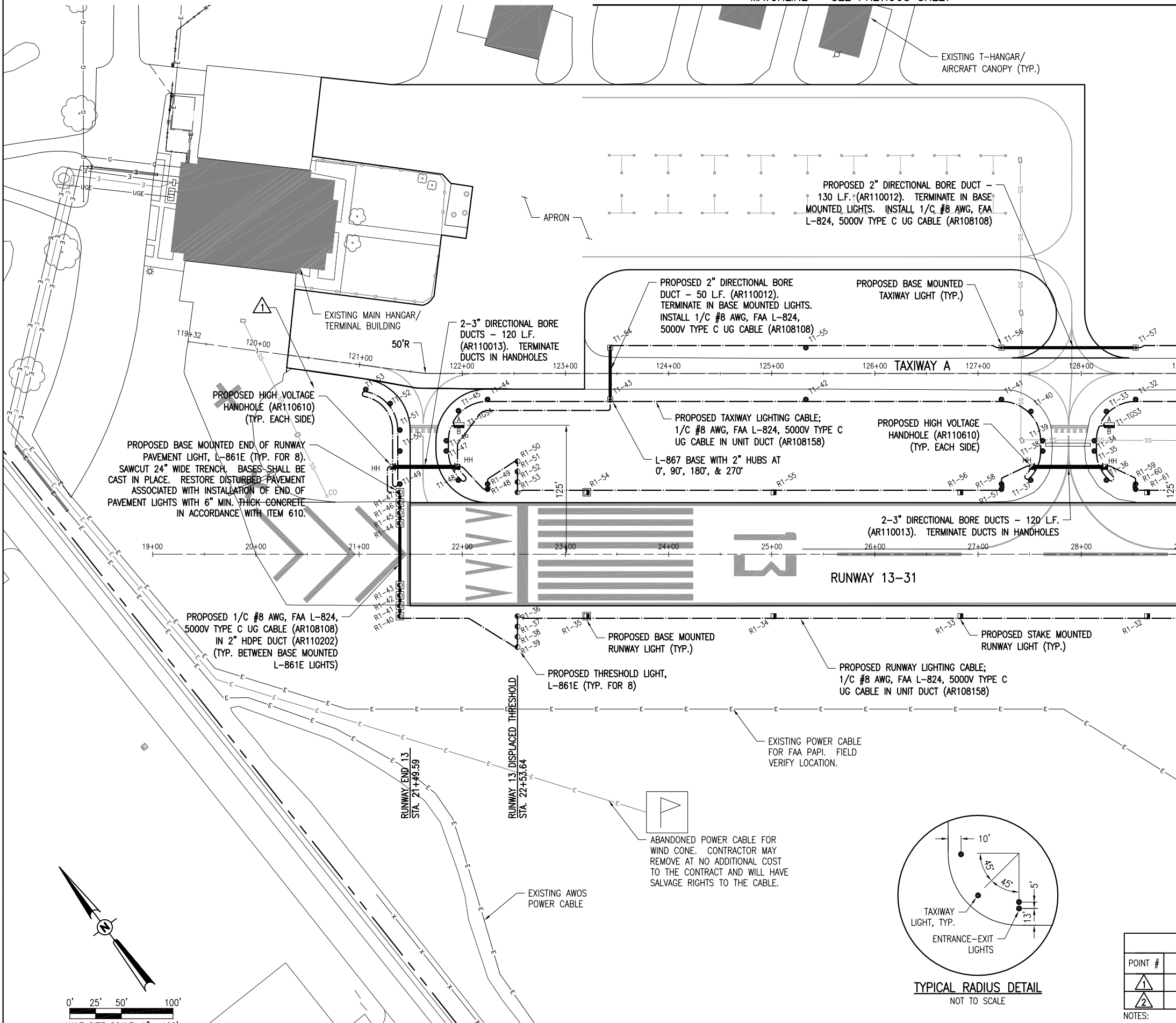

ALIGNMENT COORDINATE DATA TABLE					
POINT #	STATION	OFFSET	LINE	NORTHING	EASTING
①	19+00.00	0.00'	RWY 13-31	1767779.0586	1026220.1919
②	29+00.00	0.00'	13-31	1767183.8007	1027023.7266
③	119+32.33	0.00'	TXY A	1767924.0303	1026370.3820
④	121+61.22	0.00'	TXY A	1767764.5320	1026534.5380
⑤	121+67.89	0.00'	TXY A	1767760.2157	1026539.6180
⑥	129+00.00	0.00'	TXY A	1767324.4222	1027127.8927
⑦	39+75.00	0.00'	13-31	1766543.8984	1027887.5264
⑧	139+75.00	0.00'	TXY A	1766684.5199	1027991.6925
⑨	148+95.93	0.00'	TXY A	1766136.3261	1028731.6957
⑩	149+90.18	0.00'	TXY A	1766052.3985	1028744.1923
⑪	151+05.18	0.00'	TXY A	1765959.9920	1028675.7377
	49+55.93	0.00'	13-31		

BENCHMARK DATA				
POINT #	DESCRIPTION	ELEVATION	NORTHING	EASTING
①	NGS MONUMENT 'JOLIPOINT'	579.87	1767814.875	1026441.630
②	NGS MONUMENT 'JOLIPOINT AZ MK'	---	1766728.003	1027868.334

NOTES:
1. COORDINATES FOR CONTROL POINTS ARE ILLINOIS STATE PLANE COORDINATE EAST ZONE (NAD83)

MAR 12, 2012 11:46 AM K:\NCAD00394... Projects\Documents\09jobs\0940177\0940177D\CAD\Airport\Sheet\C-142-ELE

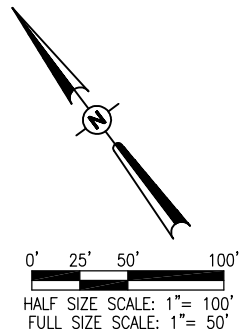

<p>JOLIET REGIONAL AIRPORT JOLIET PARK DISTRICT JOLIET, ILLINOIS</p>	<p>A.I.P. PROJ.: 3-17-0066-B8</p>				
<p>Revision Table</p> <table border="1"> <thead> <tr> <th>REVISION</th> <th>DATE</th> </tr> </thead> <tbody> <tr> <td> </td> <td> </td> </tr> </tbody> </table>	REVISION	DATE			<p>IL PROJ.: JOT-4166</p>
REVISION	DATE				
<p>Hanson Project No. 0940177D-0001 File Name: C-142-ELE.dwg Scale: AS SHOWN Date: 02/13/12</p>					
<p>LAYOUT: MLH 01/16/12 DRAWN: MLH 01/16/12 REVIEWED: KNL/CAH 02/13/12</p>					
<p>HANSON Copyright Hanson Professional Services Inc. 2012 Hanson Professional Services Inc. 1525 S. State Street Springfield, Illinois 62703-2886</p>					
<p>PROPOSED ELECTRICAL PLAN - STA. 20+00 TO STA. 29+00</p>					
<p>CONSTRUCT A STAND ALONE ELECTRICAL VAULT, REPLACE RUNWAY LIGHTS AND INSTALL TAXIWAY LIGHTS</p>					
<p>9 9 of 38 sheets</p>					