

PROFILE
 SURVEYED _____
 PLOTTED _____
 NOTE BOOK _____
 STRUCTURE NOTATIONS CHFD
 NO. _____
 BY _____
 DATE _____

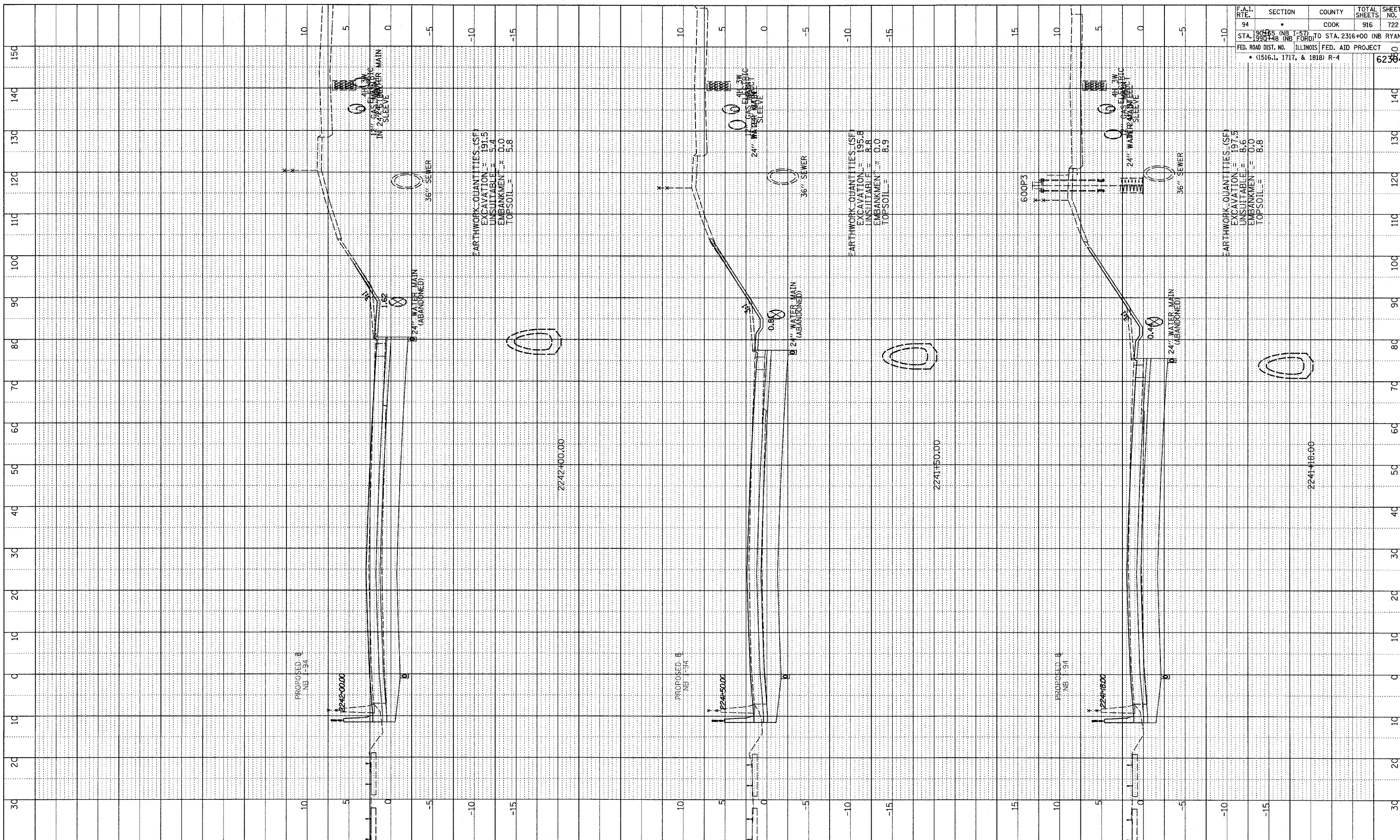

F.A.I. RTE.	SECTION	COUNTY	TOTAL SHEETS	SHEET NO.
94	•	COOK	916	722

STA. 1904+05 (NB I-57) TO STA. 2316+00 (NB RYAN)
 STA. 1901+48 (NB FORD) TO STA. 2316+00 (NB RYAN)
 FED. ROAD DIST. NO. ILLINOIS FED. AID PROJECT
 • (1516.1, 1717, & 1818) R-4

03/03/2006 04:40:05 PM
 P:\0231\3\9000\c20\pk20\ss1817c.dgn

TYLIN INTERNATIONAL

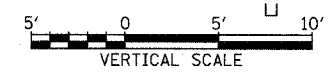

NORTHBOUND I-94 (DAN RYAN EXPWY)
 STA. 2241+18 TO STA. 2242+00