

PROFILE SURVEYED _____ BY _____ DATE _____
 GRADES CHECKED _____
 NOTE BOOK _____
 NO. _____
 STRUCTURE NOTATION CHKD _____

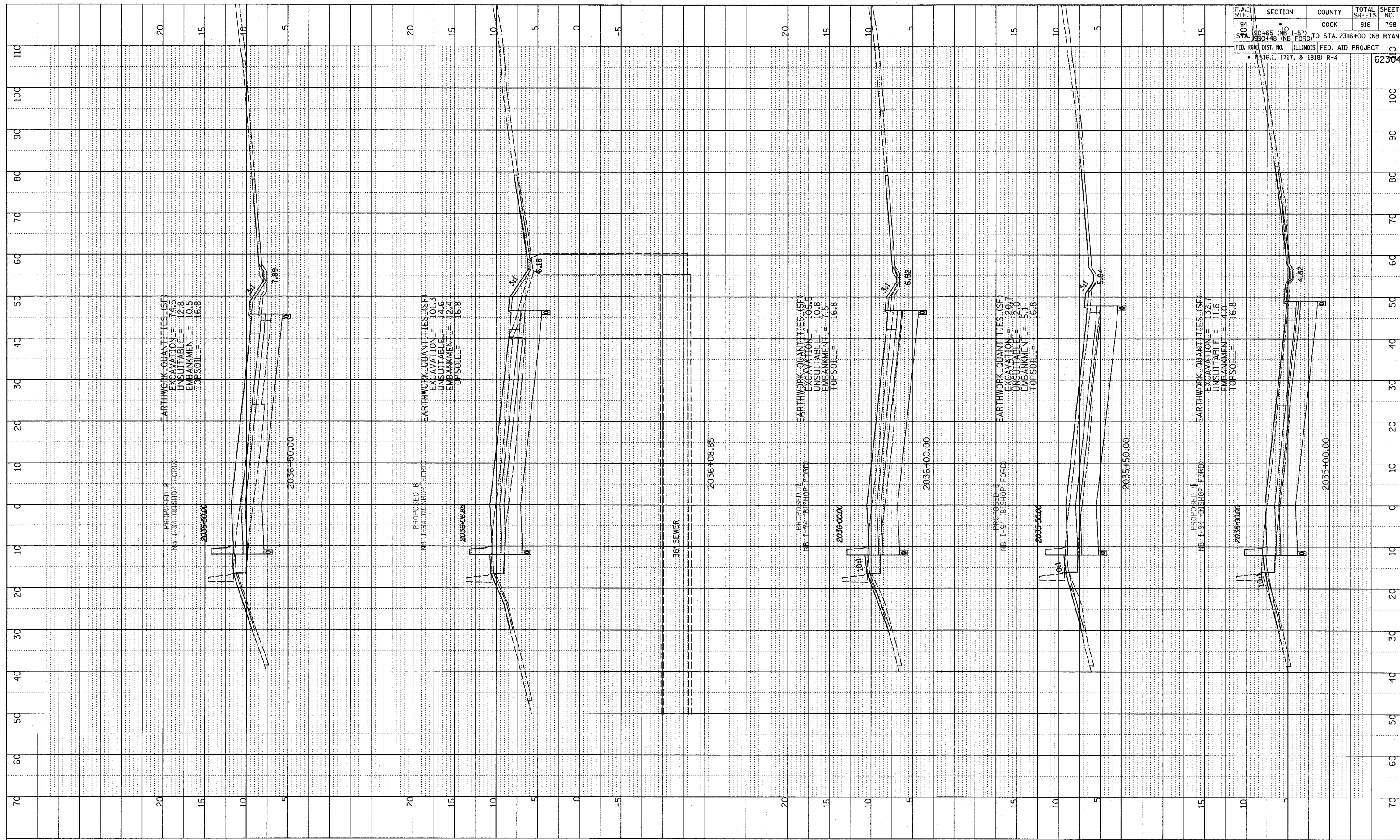

F.A.T. RTE.	SECTION	COUNTY	TOTAL SHEETS	SHEET NO.
94	190+65 (NB I-57) TO STA. 2316+00 (NB RYAN)	COOK	916	798
0	190+48 (NB FORD)			
FED. ROAD DIST. NO. ILLINOIS FED. AID PROJECT				62304
1516.1, 1717, & 1818) R-4				

TYLIN INTERNATIONAL

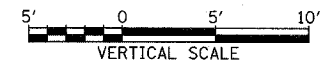
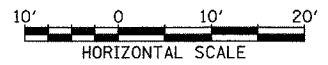

NORTHBOUND I-94 (BISHOP FORD EXPWY)
 STA. 2035+00 TO STA. 2036+50

03/03/2006 04:49:16 PM