

EXISTING CONDITIONS  
PROPOSED IMPROVEMENTS

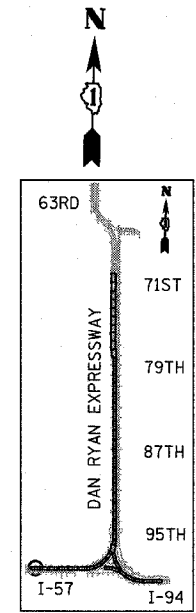
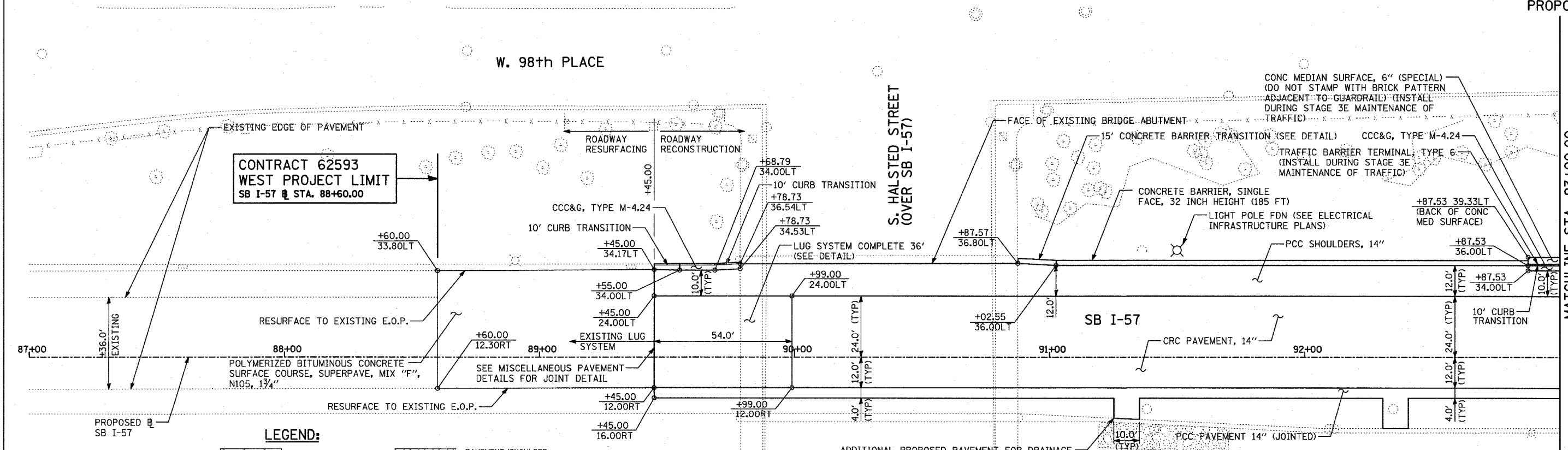

LOCATION MAP

**LEGEND:**

- |  |                                       |  |   |   |   |
|--|---------------------------------------|--|---|---|---|
|  | PAVEMENT REMOVAL                      |  | PAVEMENT/SHOULDER REMOVAL (SPECIAL) (OVER EXISTING UTILITIES)             |   | TREE REMOVAL (UNITS) (NO UNIT SHOWN = <6) |
|  | PAVED SHOULDER REMOVAL                |  | COMB CONC CURB & GUTTER REMOVAL   |   | MAINLINE #                                |
|  | BITUMINOUS SURFACE REMOVAL, 4\"/>     |  | CHAIN LINK FENCE REMOVAL  |   | STATION/OFFSET                            |
|  | BITUMINOUS SURFACE REMOVAL, 1 1/2\"/> |  | CONCRETE BARRIER/GUARDRAIL REMOVAL  | <b>PLAN NOTES:</b>  |   |
|  | BITUMINOUS SURFACE REMOVAL, 1 3/4\"/> |  | SOIL BORING LOCATIONS   | - ALL STATION/OFFSET/RADIUS CALLOUTS MEASURED TO EDGE OF PAVEMENT UNLESS OTHERWISE NOTED. |   |
|  |                                       |  | LIGHT POLE FOUNDATION REMOVAL (SEE ROADWAY LIGHTING & SURVEILLANCE PLANS) | - EXACT LOCATIONS OF EXISTING PIERS/ABUTMENTS TO BE FIELD VERIFIED                        |   |

ADDITIONAL PROPOSED PAVEMENT FOR DRAINAGE INSTALLATION - SEE DRAINAGE PLANS AND SCHEDULES FOR EXACT LOCATIONS. (2 THIS SHEET)

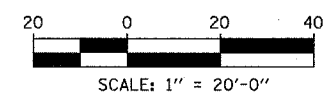

REVISIONS	
NAME	DATE

ILLINOIS DEPARTMENT OF TRANSPORTATION  
F.A.I. 94 (DAN RYAN EXPRESSWAY)  
EXISTING AND PROPOSED PLAN  
SB I-57  
SB I-57 STA. 88+60.00 TO 93+00.00

SCALE: 1"=20'  
DATE: MARCH 1, 2006

DRAWN BY: MPG  
CHECKED BY: RTM

**TYLIN** INTERNATIONAL