

F.A.I. RTE.	SECTION	COUNTY	TOTAL SHEETS	SHEET NO.
94		COOK	764	71
STA. 88+60 (SB I-57) TO STA. 1313+00 (SB RYAN)				
FED. ROAD DIST. NO. ILLINOIS FED. AID PROJECT				
(1516.1, 1717, & 1818) R-5 62593				

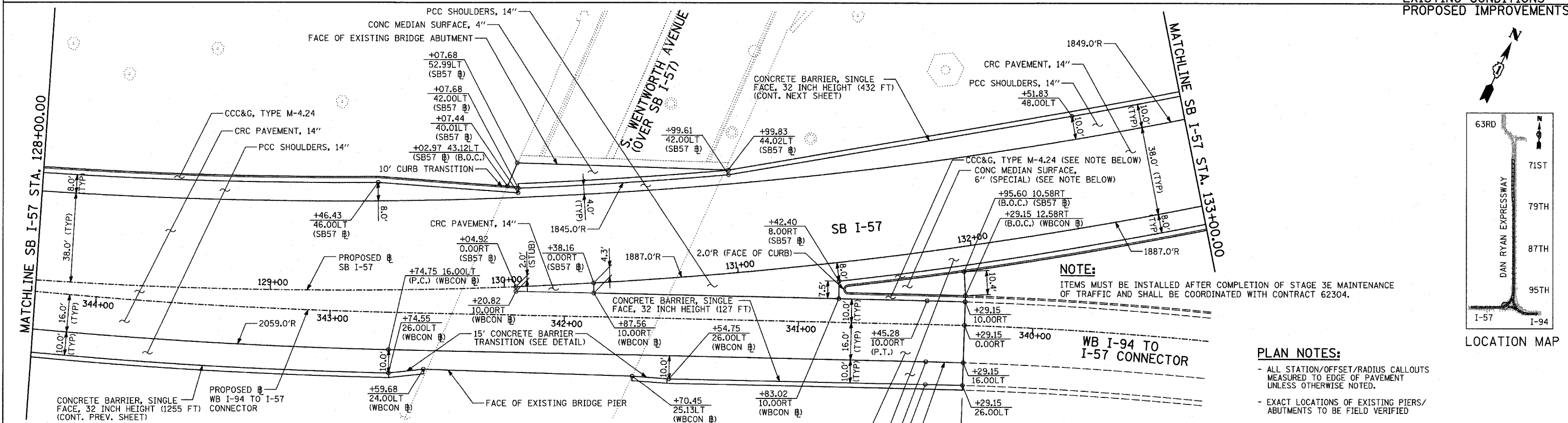

EXISTING CONDITIONS  
PROPOSED IMPROVEMENTS

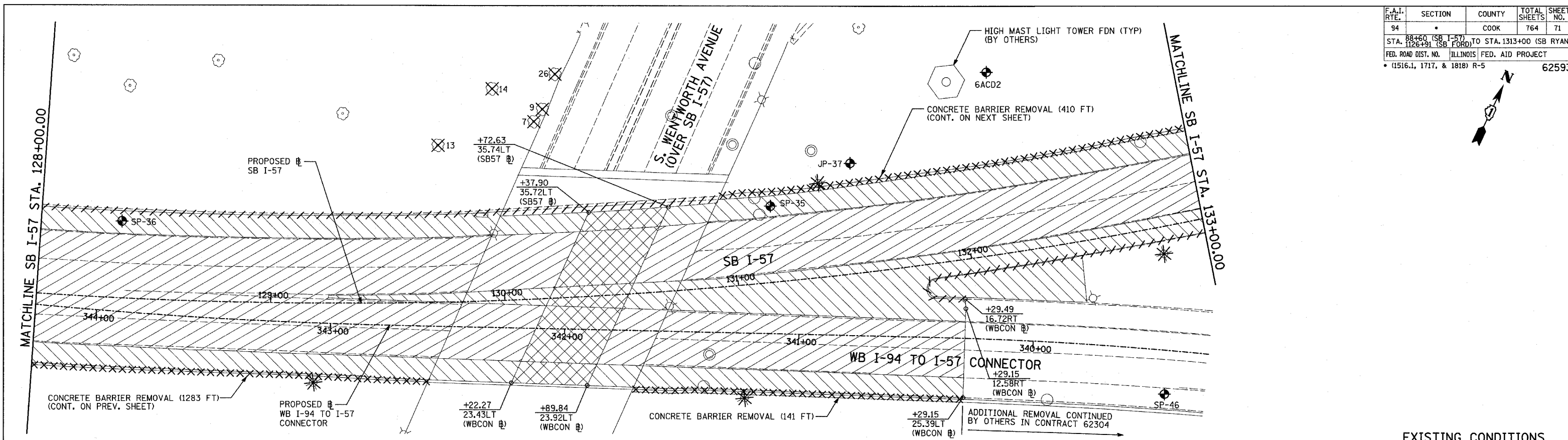
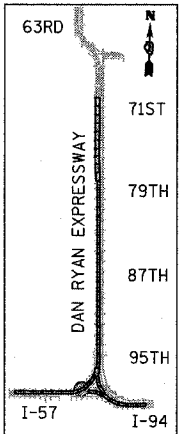

LOCATION MAP

**LEGEND:**

- |  |                                    |  |   |  |   |
|--|------------------------------------|--|---|--|---|
|  | PAVEMENT REMOVAL                   |  | BITUMINOUS SURFACE REMOVAL, 1 1/4"                            |  | SOIL BORING LOCATIONS   |
|  | PAVED SHOULDER REMOVAL             |  | PAVEMENT/SHOULDER REMOVAL (SPECIAL) (OVER EXISTING UTILITIES) |  | LIGHT POLE FOUNDATION REMOVAL (SEE ROADWAY LIGHTING & SURVEILLANCE PLANS) |
|  | BITUMINOUS SURFACE REMOVAL, 4"     |  | COMB CONC CURB & GUTTER REMOVAL                               |  | TREE REMOVAL (UNITS) (NO UNIT SHOWN = <6)                                 |
|  | BITUMINOUS SURFACE REMOVAL, 1 1/2" |  | CHAIN LINK FENCE REMOVAL                                      |  | MAINLINE STATION/OFFSET   |
|  |                                    |  | CONCRETE BARRIER/GUARDRAIL REMOVAL                            |  |   |

**TYLIN INTERNATIONAL**

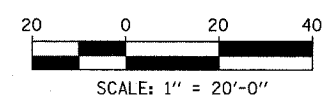

REVISIONS	
NAME	DATE

ILLINOIS DEPARTMENT OF TRANSPORTATION  
F.A.I. 94 (DAN RYAN EXPRESSWAY)  
**EXISTING AND PROPOSED PLAN**  
I-57  
SB I-57 STA. 128+00.00 TO 133+00.00

SCALE: 1"=20'  
DATE: MARCH 1, 2006  
DRAWN BY: MPG  
CHECKED BY: RTM