

S. LAFAYETTE AVENUE

F.A.I. RTE.	SECTION	COUNTY	TOTAL SHEETS	SHEET NO.
94		COOK	764	81
STA. 88+60 (SB I-57) TO STA. 1313+00 (SB RYAN)				
FED. ROAD DIST. NO. ILLINOIS FED. AID PROJECT				
(1516.1, 1717, & 1818) R-5 62593				

MATCHLINE STA. 1225+00.00

MATCHLINE STA. 1231+00.00

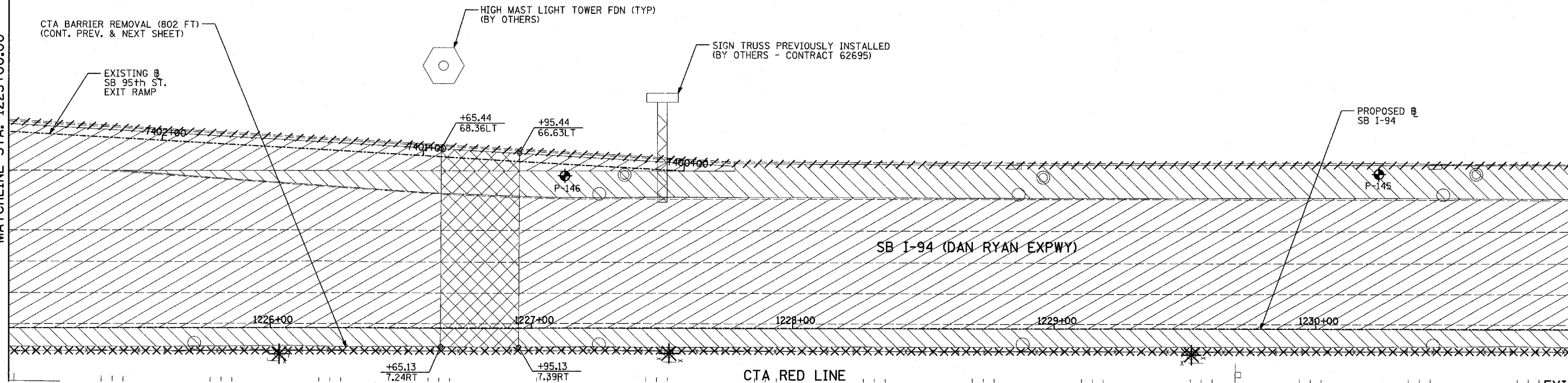

EXISTING CONDITIONS  
PROPOSED IMPROVEMENTS

S. LAFAYETTE AVENUE

MATCHLINE STA. 1225+00.00

MATCHLINE STA. 1231+00.00

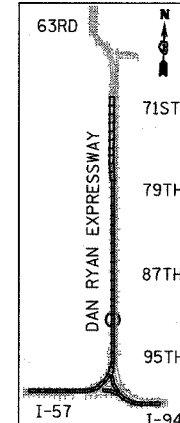
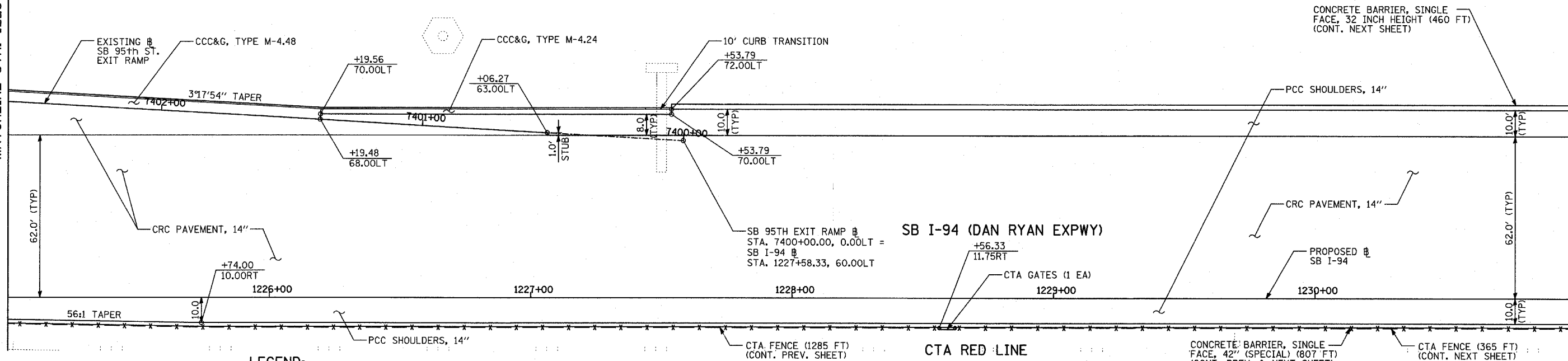

LOCATION MAP

LEGEND:

	PAVEMENT REMOVAL		BITUMINOUS SURFACE REMOVAL, 1 3/4"		SOIL BORING LOCATIONS
	PAVED SHOULDER REMOVAL		PAVEMENT/SHOULDER REMOVAL (SPECIAL) (OVER EXISTING UTILITIES)		LIGHT POLE FOUNDATION REMOVAL (SEE ROADWAY LIGHTING & SURVEILLANCE PLANS)
	BITUMINOUS SURFACE REMOVAL, 4"		COMB CONC CURB & GUTTER REMOVAL		TREE REMOVAL (UNITS) (NO UNIT SHOWN = <6)
	BITUMINOUS SURFACE REMOVAL, 1 1/2"		CHAIN LINK FENCE REMOVAL		MAINLINE # STATION/OFFSET
			CONCRETE BARRIER/GUARDRAIL REMOVAL		

PLAN NOTES:

- ALL STATION/OFFSET/RADIUS CALLOUTS MEASURED TO EDGE OF PAVEMENT UNLESS OTHERWISE NOTED.
- EXACT LOCATIONS OF EXISTING PIERS/ABUTMENTS TO BE FIELD VERIFIED

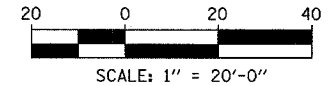

REVISIONS	
NAME	DATE

ILLINOIS DEPARTMENT OF TRANSPORTATION  
F.A.I. 94 (DAN RYAN EXPRESSWAY)  
EXISTING AND PROPOSED PLAN  
SB I-94 (DAN RYAN EXPRESSWAY)  
SB I-94 STA. 1225+00.00 TO 1231+00.00

SCALE: 1"=20'  
DATE: MARCH 1, 2006

DRAWN BY: MPG  
CHECKED BY: RTM

TYLIN INTERNATIONAL