

**EE-EE**  
STAGE 3C: SB I-94 DAN RYAN; STA. 1205+00 TO STA. 1215+53

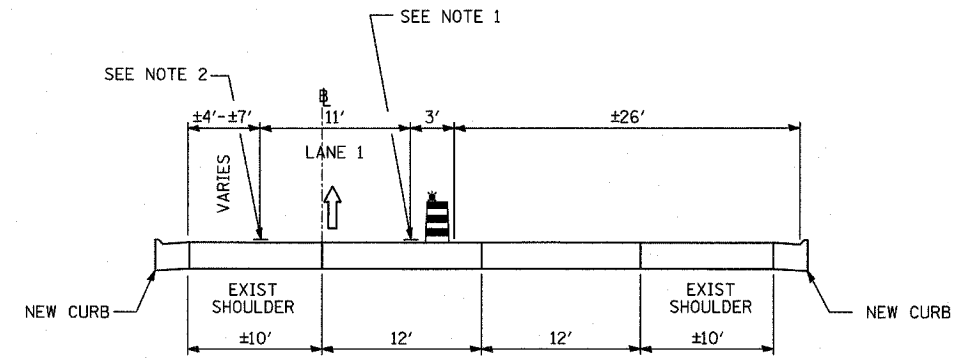

**HH-HH**  
STAGE 3C: EB CROSS CONNECTOR; STA. 415+06 TO STA. 421+81

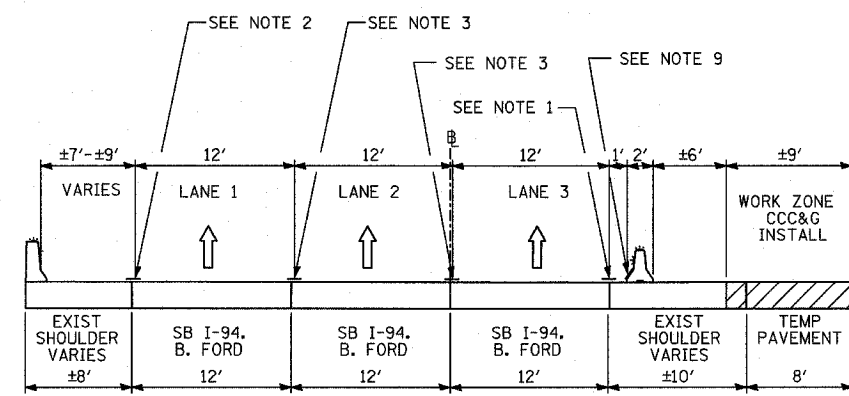

**FF-FF**  
STAGE 3C: SB I-94 BISHOP FORD; STA. 1127+00 TO STA. 1143+04

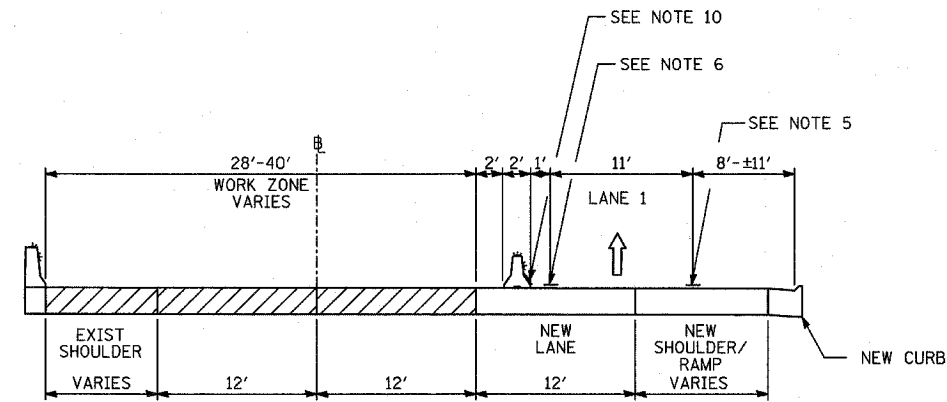

**II-II**  
STAGE 3C: SB I-57; STA. 88+60 TO STA. 103+98

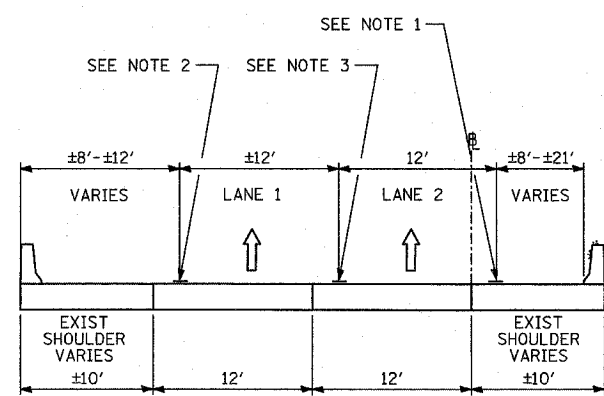

**GG-GG**  
STAGE 3C: SB I-94 BISHOP FORD; STA. 1152+00 TO STA. 1167+00

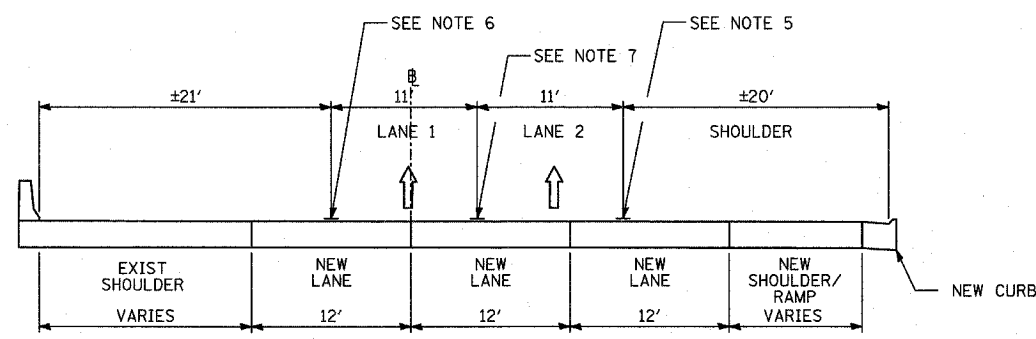

**JJ-JJ**  
STAGE 3D: SB I-57; STA. 87+48 TO 97+48

- NOTE 1 - EPOXY PAVEMENT MARKING-LINE 4" (WHITE)
- NOTE 2 - EPOXY PAVEMENT MARKING-LINE 4" (YELLOW)
- NOTE 3 - EPOXY PAVEMENT MARKING-SKIP-DASH 5" (WHITE), 10' LINE WITH 30' SPACE
- NOTE 4 - EPOXY PAVEMENT MARKING-LINE 8" (WHITE)
- NOTE 5 - PAVEMENT MARKING TAPE, TYPE III 4" LINE (WHITE)
- NOTE 6 - PAVEMENT MARKING TAPE, TYPE III 4" LINE (YELLOW)
- NOTE 7 - PAVEMENT MARKING TAPE, TYPE III 5" SKIP-DASH (WHITE), 10' LINE WITH 30' SPACE
- NOTE 8 - PAVEMENT MARKING TAPE, TYPE III 8" LINE (WHITE)
- NOTE 9 - TEMPORARY PAVEMENT MARKING-LINE 6" (WHITE)
- NOTE 10 - TEMPORARY PAVEMENT MARKING-LINE 6" (YELLOW)

**LEGEND:**

- TEMPORARY CONCRETE BARRIER (WITH REFLECTORS ON TOP AND SIDE FACING TRAFFIC)
- TRAFFIC MOVEMENT
- DRUM WITH MONO-DIRECTIONAL STEADY BURNING LIGHT
- SINGLE-FACE CONCRETE BARRIER, 32"
- SINGLE-FACE CONCRETE BARRIER, 32" (WITH REFLECTORS ON TOP AND SIDE FACING TRAFFIC)
- PAVEMENT REMOVAL AREA
- TEMPORARY PAVEMENT

\* ALL NOT TYPICAL SECTIONS ARE DRAWN IN THE DIRECTION OF TRAFFIC

**TYLIN**INTERNATIONAL

REVISIONS	
NAME	DATE

ILLINOIS DEPARTMENT OF TRANSPORTATION  
F.A.I. 94 (DAN RYAN EXPRESSWAY)  
GENERAL NOTES  
CONSTRUCTION STAGING NOTES  
MAINTENANCE OF TRAFFIC DETAILS  
SHEET 8 OF 12

SCALE: NO SCALE      DRAWN BY: RTM  
DATE: MARCH 1, 2006      CHECKED BY: TGB