

MATCHLINE SB I-94 STA. 1268+00.00 (PREV. SHEET)

MATCHLINE SB I-94 STA. 1283+00.00 (BELOW)

MATCHLINE SB I-94 STA. 1283+00.00 (ABOVE)

MATCHLINE SB I-94 STA. 1298+00.00 (NEXT SHEET)

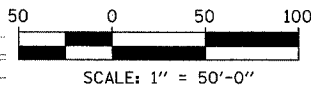
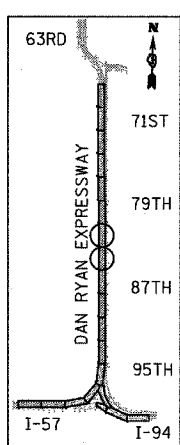
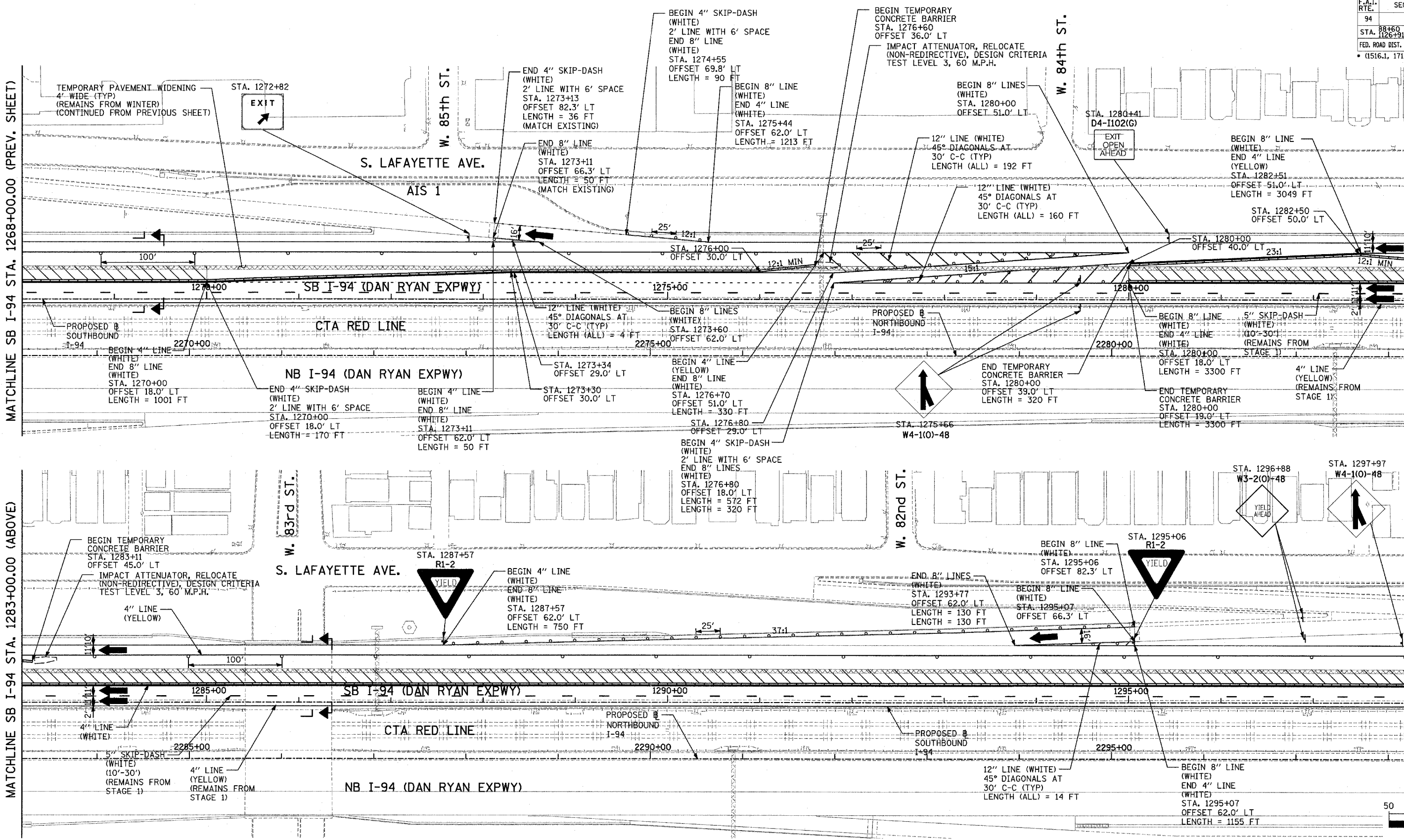

LEGEND:

- TEMPORARY CONCRETE BARRIER
- TRAFFIC LANE
- WORK ZONE
- BARRICADE, TYPE III
- DRUM WITH MONO-DIRECTIONAL STEADY BURNING LIGHT
- ARROW BOARD
- TEMPORARY PAVEMENT

REVISIONS	
NAME	DATE

ILLINOIS DEPARTMENT OF TRANSPORTATION
F.A.I. 94 (DAN RYAN EXPRESSWAY)
MAINTENANCE OF TRAFFIC PLAN
STAGE 2 - SB I-94
SB I-94 STA. 1268+00 TO 1298+00
SHEET 6 OF 9

SCALE: 1"=50'-0"
 DATE: MARCH 1, 2006
 DRAWN BY: JDF
 CHECKED BY: RTM

TYLIN INTERNATIONAL