

MATCHLINE SB I-94 STA. 1238+00.00 (STAGES 3A, 3B & 3C)

MATCHLINE SB I-94 STA. 1253+00.00 (BELOW)

MATCHLINE SB I-94 STA. 1253+00.00 (ABOVE)

MATCHLINE SB I-94 STA. 1268+00.00 (NEXT SHEET)

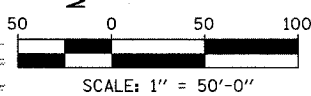
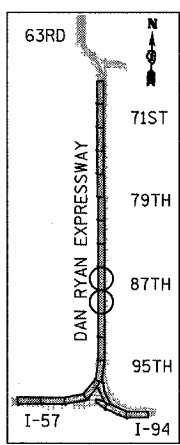
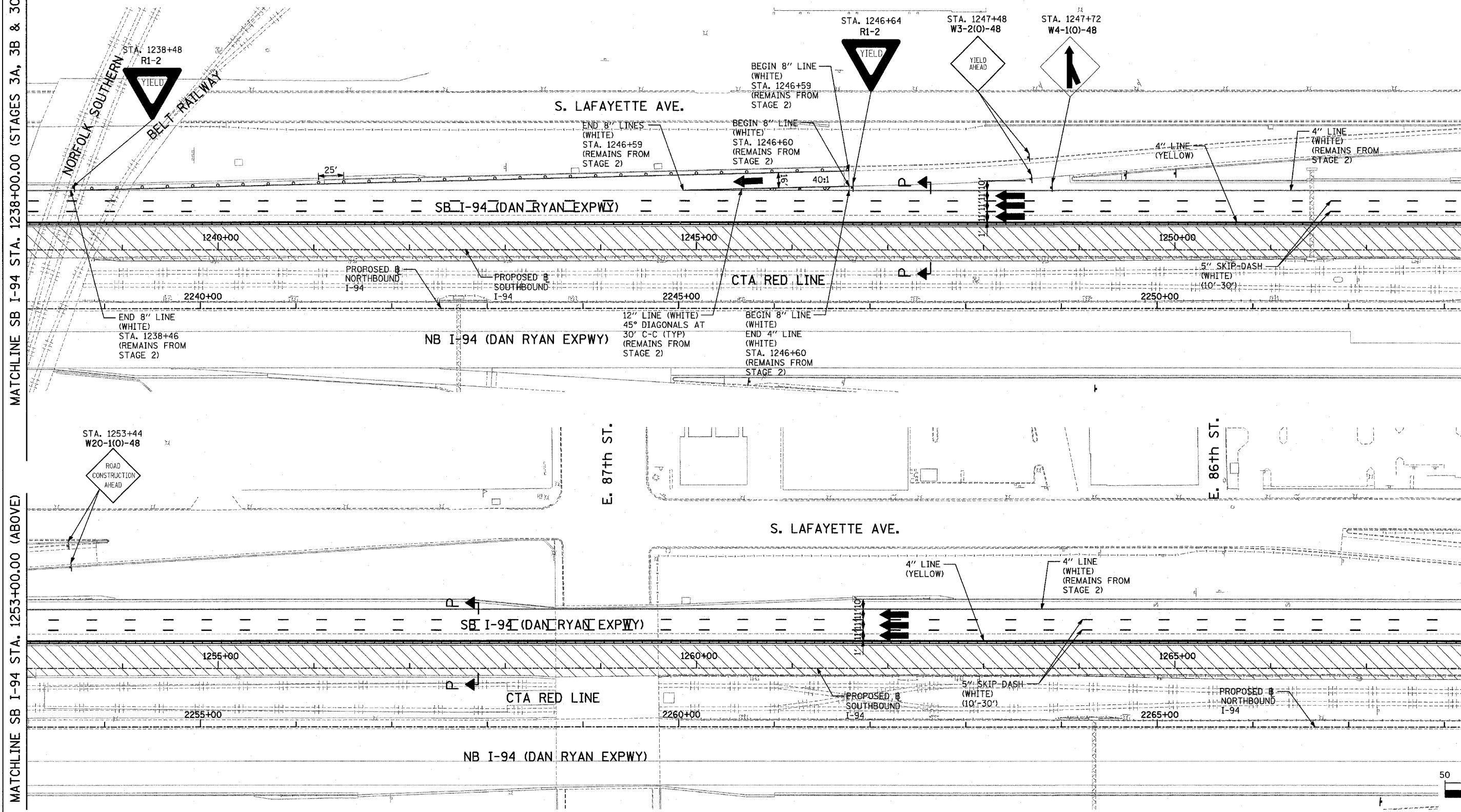

NOTE:
ON ALL THE STAGE 3 PLAN SHEETS, CALLOUTS FOR TEMPORARY CONCRETE BARRIER ARE TO THE FRONT FACE OF THE WALL.

LEGEND:

	TEMPORARY CONCRETE BARRIER		DRUM WITH MONO-DIRECTIONAL STEADY BURNING LIGHT
	TRAFFIC LANE		ARROW BOARD
	WORK ZONE		TEMPORARY PAVEMENT
	BARRICADE, TYPE III		

REVISIONS	
NAME	DATE

ILLINOIS DEPARTMENT OF TRANSPORTATION
F.A.I. 94 (DAN RYAN EXPRESSWAY)
MAINTENANCE OF TRAFFIC PLAN
STAGE 3 - SB I-94
SB I-94 STA. 1238+00 TO 1268+00
SHEET 1 OF 3

SCALE: 1"=50'-0" DRAWN BY: JDF
DATE: MARCH 1, 2006 CHECKED BY: RTM

TYLIN INTERNATIONAL