

F.A.I. RTE.	SECTION	COUNTY	TOTAL SHEETS	SHEET NO.
94		COOK	764	233

STA. 88+60 (SB I-57) TO STA. 131+00 (SB RYAN)
 FED. ROAD DIST. NO. ILLINOIS FED. AID PROJECT
 * (1516.1, 1717, & 1818) R-5 62593

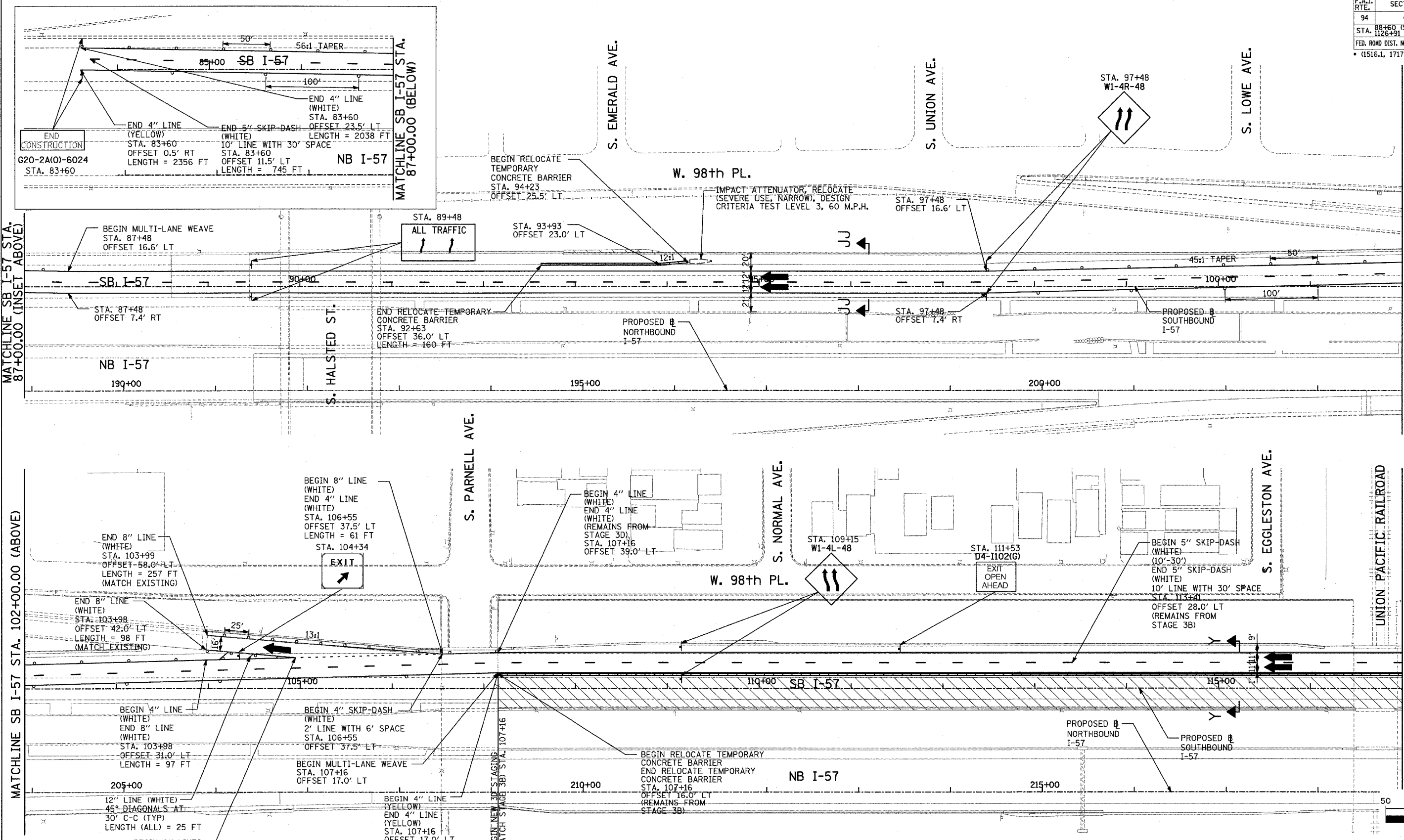

MATCHLINE SB I-57 STA. 87+00.00 (INSET ABOVE)

MATCHLINE SB I-57 STA. 102+00.00 (BELOW)

MATCHLINE SB I-57 STA. 102+00.00 (ABOVE)

MATCHLINE SB I-57 STA. 117+00.00 (SEE STAGE 3B SHEET 2 OF 6)

NOTE:

ON ALL THE STAGE 3D PLAN SHEETS, CALLOUTS FOR TEMPORARY CONCRETE BARRIER ARE TO THE FRONT FACE OF THE WALL.

LEGEND:

- TEMPORARY CONCRETE BARRIER
- TRAFFIC LANE
- WORK ZONE
- BARRICADE, TYPE III
- DRUM WITH MONO-DIRECTIONAL STEADY BURNING LIGHT
- ARROW BOARD
- TEMPORARY PAVEMENT

REVISIONS	
NAME	DATE

ILLINOIS DEPARTMENT OF TRANSPORTATION
 F.A.I. 94 (DAN RYAN EXPRESSWAY)
 MAINTENANCE OF TRAFFIC PLAN
 STAGE 3D - SB I-94
 SB I-57 STA. 87+00 TO 117+00
 SHEET 1 OF 1

SCALE: 1"=50'-0"
 DATE: MARCH 1, 2006

DRAWN BY: JDF
 CHECKED BY: RTM

TYLIN INTERNATIONAL

