

|  |         |        |              |           |
|--|---------|--------|--------------|-----------|
| F.A.I. RTE.                                    | SECTION | COUNTY | TOTAL SHEETS | SHEET NO. |
| 94   | *       | COOK   | 764          | 240       |
| STA. 88+60 (SB I-57) TO STA. 1313+00 (SB RYAN) |         |        |              |           |
| FED. ROAD DIST. NO. ILLINOIS FED. AID PROJECT  |         |        |              |           |
| * (1516.1, 1717, & 1818) R-5                   |         |        |              |           |

62593

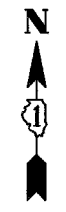

**SIGNING LEGEND:**

- EXISTING GROUND MOUNTED SIGN
- EXISTING OVERHEAD TRUSS MOUNTED SIGN
- EXISTING OVERHEAD SIGN STRUCTURE-BRIDGE MOUNTED
- EXISTING OVERHEAD CANTILEVER MOUNTED SIGN
- PROPOSED GROUND MOUNTED SIGN
- PROPOSED OVERHEAD SIGN STRUCTURE - TRUSS
- CONSTRUCTION ZONE
- EXISTING SIGN
- EXISTING SIGN TO BE REMOVED
- PROPOSED SIGN

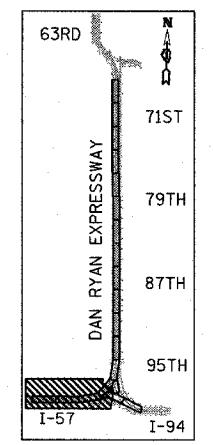
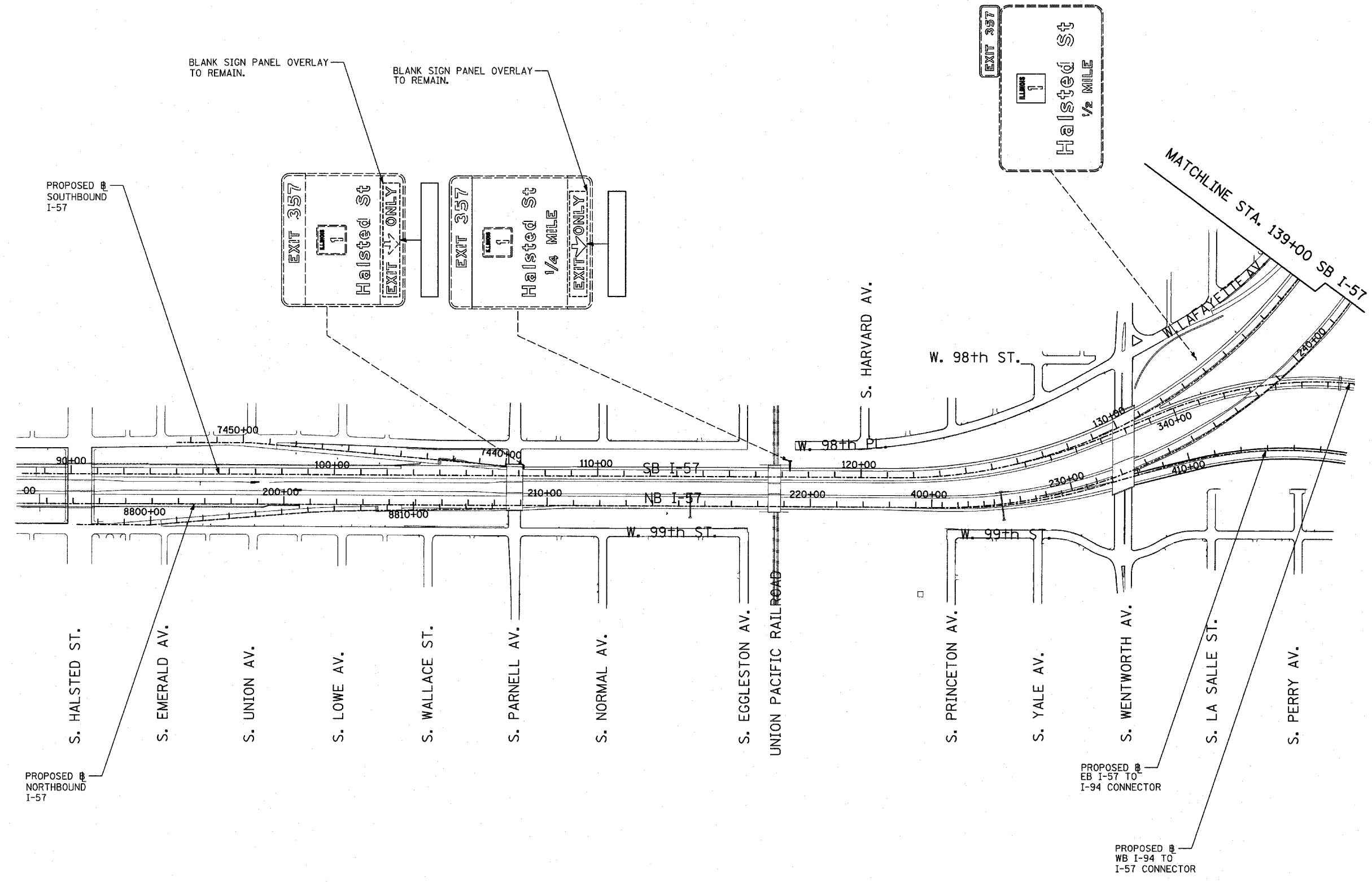

LOCATION MAP

**TYLIN** INTERNATIONAL

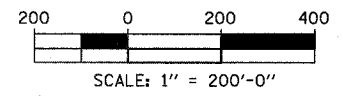

| REVISIONS |      |
|-----------|------|
| NAME      | DATE |
|           |      |
|           |      |
|           |      |
|           |      |
|           |      |
|           |      |
|           |      |
|           |      |
|           |      |
|           |      |

ILLINOIS DEPARTMENT OF TRANSPORTATION  
**F.A.I. 94 (DAN RYAN EXPRESSWAY)**  
**CONSTRUCTION SIGNING-WINTER**  
**SB I-57 STA. 100+00 TO STA 139+00**  
**SHEET 1 OF 2**

SCALE: 1" = 200'  
DATE: MARCH 1, 2006

DRAWN BY: AMB  
CHECKED BY: TGB