

F.A.I. RTE.	SECTION	COUNTY	TOTAL SHEETS	SHEET NO.
94		COOK	764	271
STA. 88+60 (SB I-57) TO STA. 1313+00 (SB RYAN)				
FED. ROAD DIST. NO. ILLINOIS FED. AID PROJECT				
(1516.1, 1717, & 1818) R-5				

62593

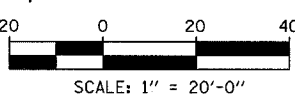
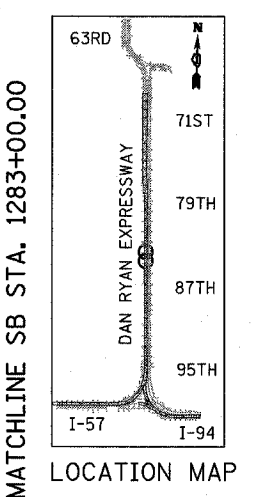
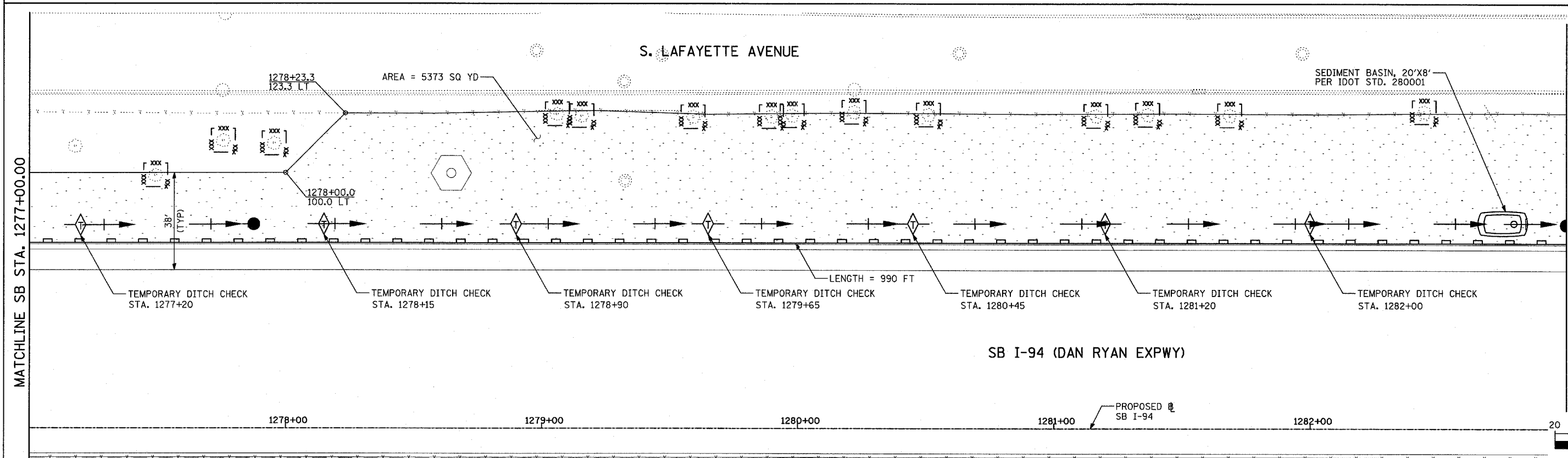
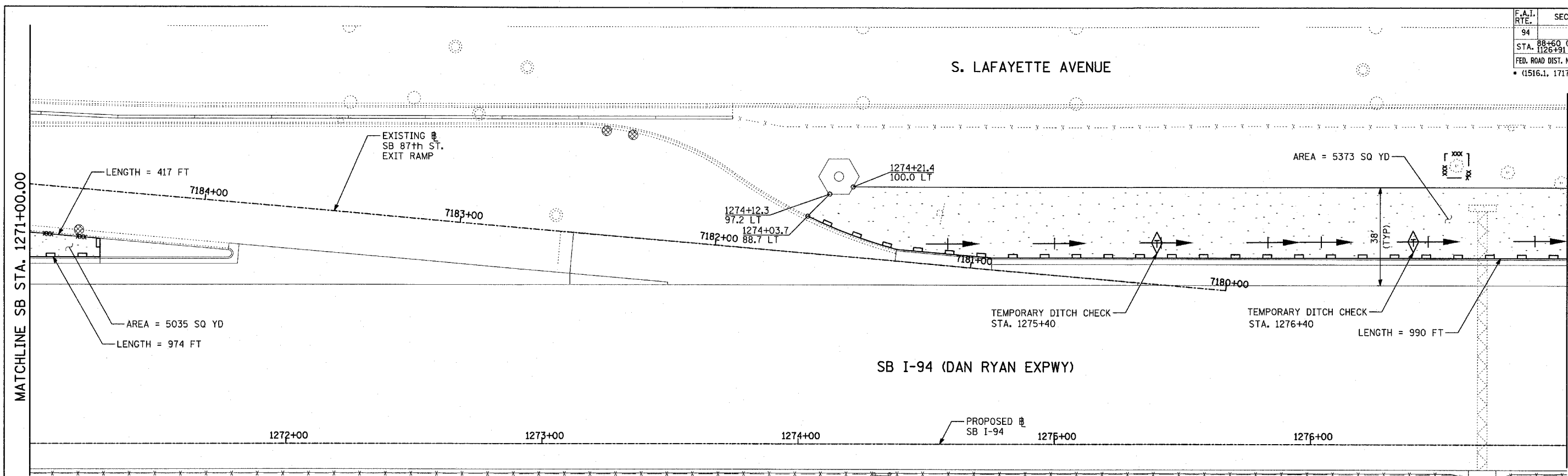

TYLIN INTERNATIONAL

TOTAL NUMBER OF INLET FILTERS THIS SHEET: 3
 TOTAL NUMBER OF TEMPORARY DITCH CHECKS THIS SHEET: 9
 TOTAL NUMBER OF TREES TO BE PROTECTED THIS SHEET: 15

LEGEND:

	TEMPORARY EROSION CONTROL SEEDING		TEMPORARY DITCH CHECK
	SEDIMENT CONTROL, SILT FENCE		PROPOSED DRAINAGE SWALE (SEE DRAINAGE PLANS)
	INLET FILTER, TO BE INSTALLED IN OFF PROJECT DRAINAGE STRUCTURES ACCEPTING STORMWATER RUNOFF		EXISTING DRAINAGE SWALE
	TEMPORARY FENCE		TEMPORARY FENCE FOR TREE PROTECTION (15 FEET PER SIDE = 60 FEET TOTAL)

REVISIONS	
NAME	DATE

ILLINOIS DEPARTMENT OF TRANSPORTATION
 F.A.I. 94 (DAN RYAN EXPRESSWAY)
 EROSION CONTROL PLAN
 SB I-94 (DAN RYAN EXPRESSWAY)
 STA. 1271+00.00 TO 1283+00.00
 SHEET 16 OF 24

SCALE: 1"=20'
 DATE: MARCH 1, 2006

DRAWN BY: JJS
 CHECKED BY: MPG