

F.A.I. RTE.	SECTION	COUNTY	TOTAL SHEETS	SHEET NO.
94		COOK	764	367
STA. 88+60 (SB I-57) TO STA. 1313+00 (SB RYAN)				
FED. ROAD DIST. NO. ILLINOIS FED. AID PROJECT				
• (1516.1, 1717, & 1818) R-5				

62593

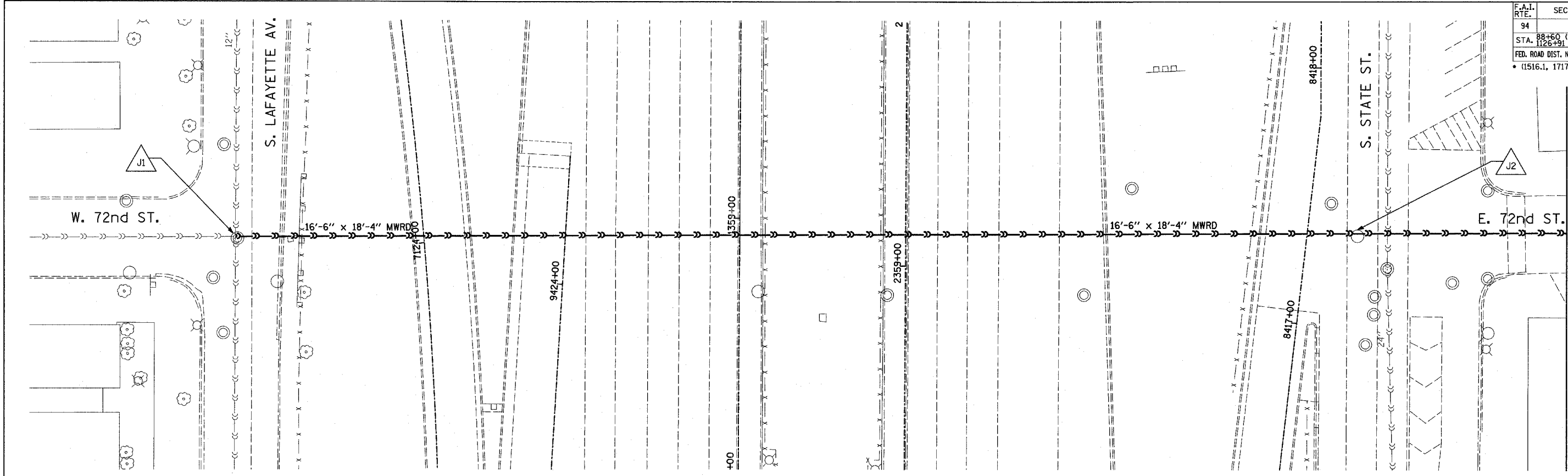

MATCHLINE BELOW

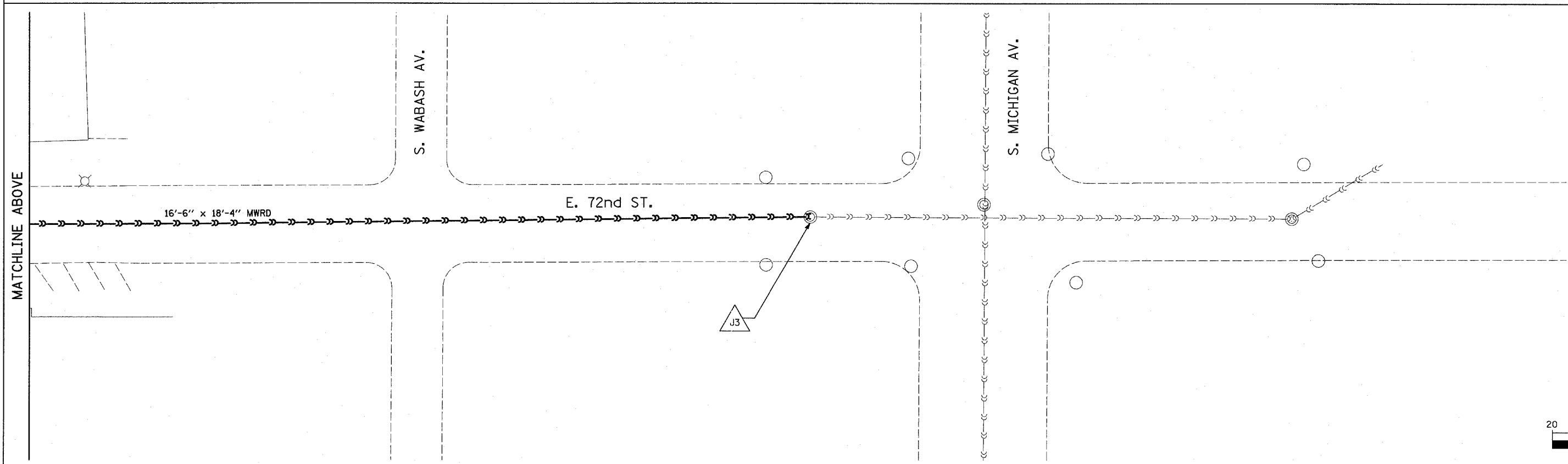

MATCHLINE ABOVE

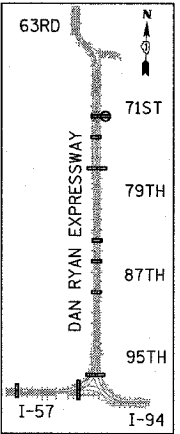

LOCATION MAP

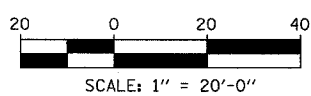

**TYLIN** INTERNATIONAL

**LEGEND:**

- EXISTING COMBINED SEWER
- EXISTING COMBINED SEWER TO BE TELEVISIED
- △ XY MANHOLE STRUCTURE NO.

REVISIONS	
NAME	DATE

ILLINOIS DEPARTMENT OF TRANSPORTATION  
**F.A.I. 94 (DAN RYAN EXPRESSWAY)**  
**SEWER TELEVISING**  
**72ND STREET CROSSING**

SCALE: 1"=20'-0"  
 DATE: MARCH 1, 2006  
 DRAWN BY: MPG  
 CHECKED BY: TGB