

DATE	
BT	
PROFILE	REVIEWED
	PLOTTED
	CHECKED
	DATE
	BY
	NO.
	STRUCTURE NOTATION CHD

F.A.I. RTE.	SECTION	COUNTY	TOTAL SHEETS	SHEET NO.
94	*	COOK	764	550
STA. 88+60 (SB I-57) TO STA. 131+00 (SB RYAN)				
FED. ROAD DIST. NO. ILLINOIS FED. AID PROJECT				
* (1516.1, 1717, & 1818) R-5				
				62593

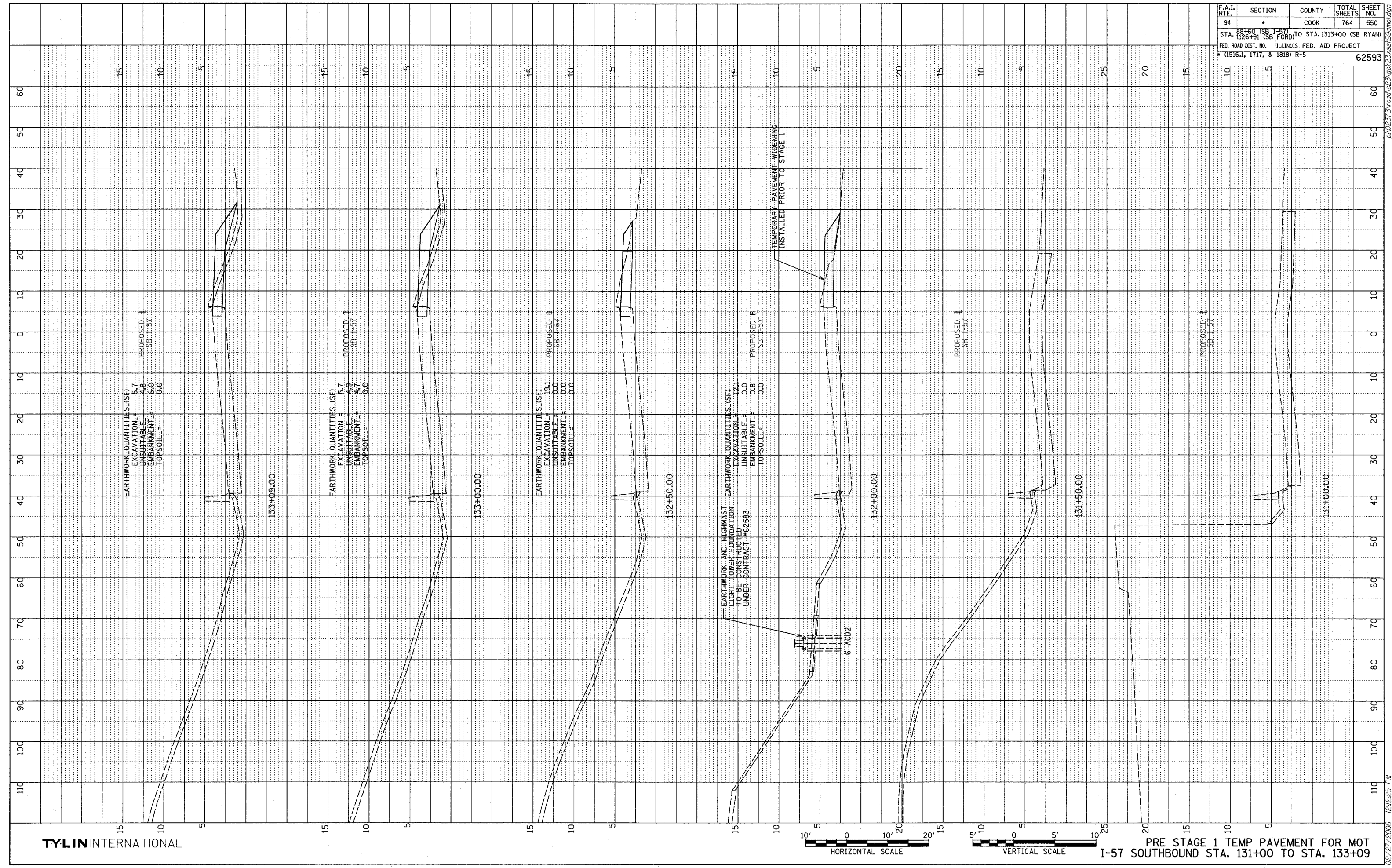

TYLIN INTERNATIONAL

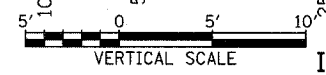
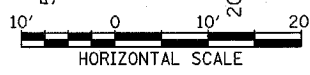

PRE STAGE 1 TEMP PAVEMENT FOR MOT I-57 SOUTHBOUND STA. 131+00 TO STA. 133+09

02/27/2006 12:25 PM P:\02373\road\2373\gpk23\ss1999\mat.dgn