

PROFILE SUBMITTED: \_\_\_\_\_ DATE: \_\_\_\_\_  
 PRINTED: \_\_\_\_\_  
 NOTE BOOK: \_\_\_\_\_  
 NO. \_\_\_\_\_ STRUCTURE NOTATION: \_\_\_\_\_

F.A.I. RTE.	SECTION	COUNTY	TOTAL SHEETS	SHEET NO.
84	88+60 (SB) TO STA. 1313+00 (SB RYAN)	COOK	764	555
STA. 1126+91 (SB) TO STA. 1313+00 (SB RYAN)	ILLINOIS FED. AID PROJECT		62593	
(1516.1, 1717, & 1818) R-5				

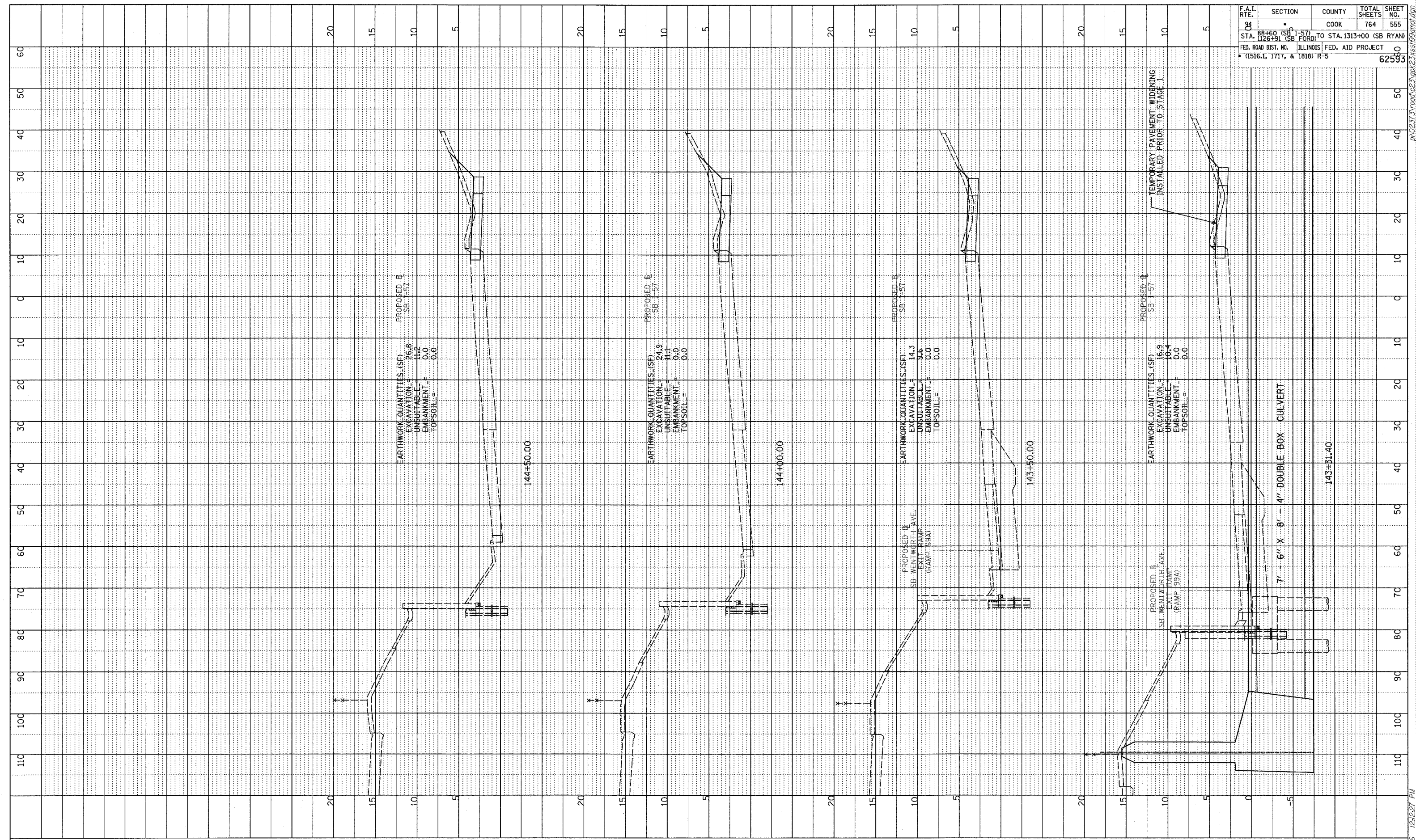

TYLIN INTERNATIONAL

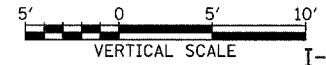

PRE STAGE 1 TEMP PAVEMENT FOR MOT I-57 SOUTHBOUND STA. 143+31.40 TO STA. 144+50

02/27/2006 12:12:27 PM