

PROFILE
 DATE: _____
 PLOTTED: _____
 NOTE BOOK NO.: _____
 STRUCTURE NOTATION: _____
 NO.: _____

F.A.I. RTE.	SECTION	COUNTY	TOTAL SHEETS	SHEET NO.
94	88+60 (SB I-57) TO STA. 1126+31 (SB FORD)	COOK	764	559
FED. ROAD DIST. NO. ILLINOIS FED. AID PROJECT				
(1516.1, 1717, & 1818) R-5				62593

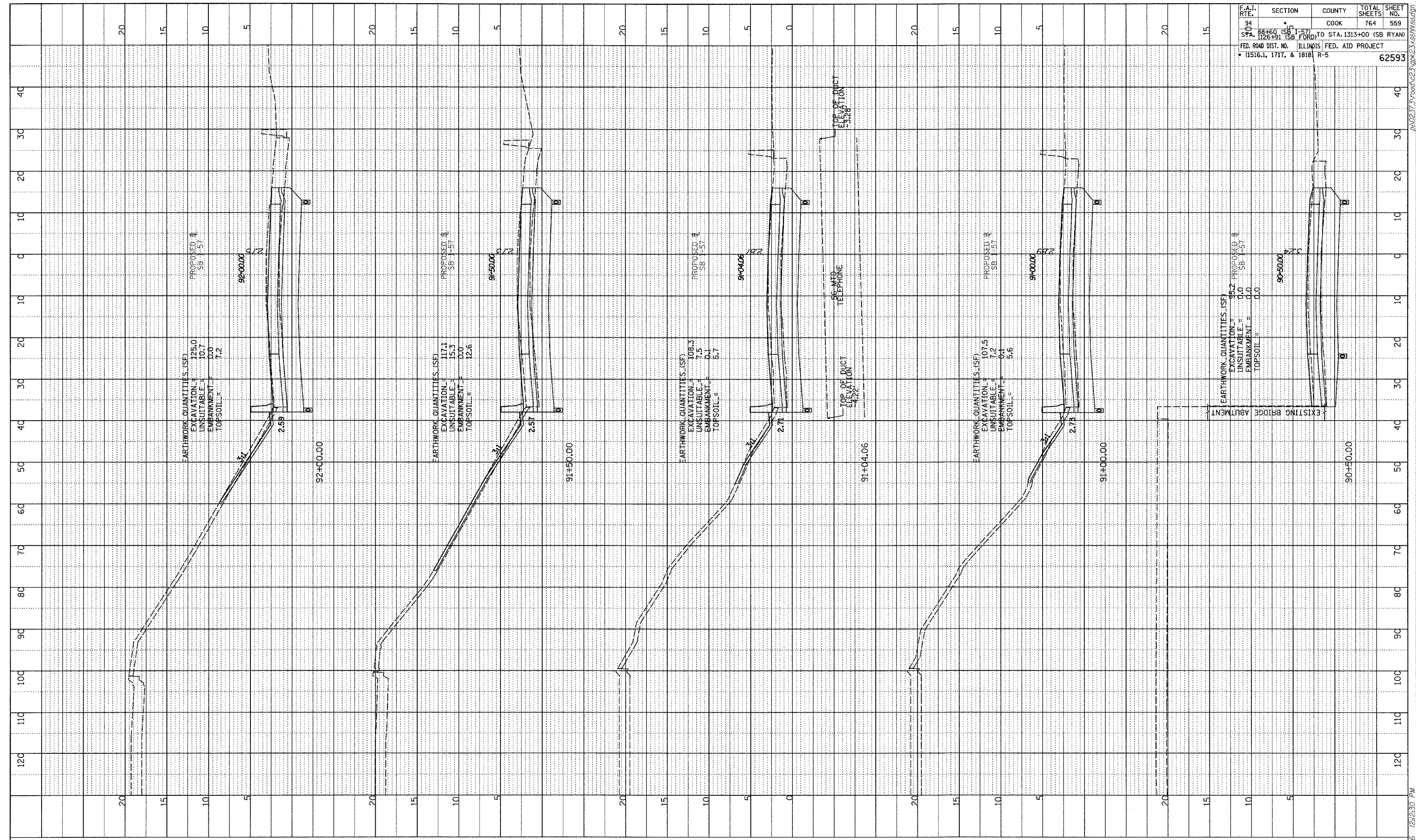

TYLIN INTERNATIONAL

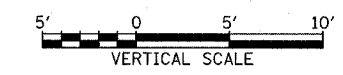
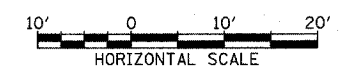

I-57 SOUTHBOUND
 STA. 90+50 TO STA. 92+00

02/27/2006 12:12:30 PM