

PROFILE SUBMITTED BY DATE  
 PLOTTED BY  
 NOTE BOOK NO. CHECKED BY  
 STRUCTURE NOTATIONS CIRCD NO.

F.A.I. RTE.	SECTION	COUNTY	TOTAL SHEETS	SHEET NO.
94	SB I-57	COOK	764	562
STA. 88+60 (SB I-57) TO STA. 1313+00 (SB RYAN)				
FED. ROAD DIST. NO. ILLINOIS FED. AID PROJECT				
• (1516.1, 1717, & 1888) R-5				
62593				

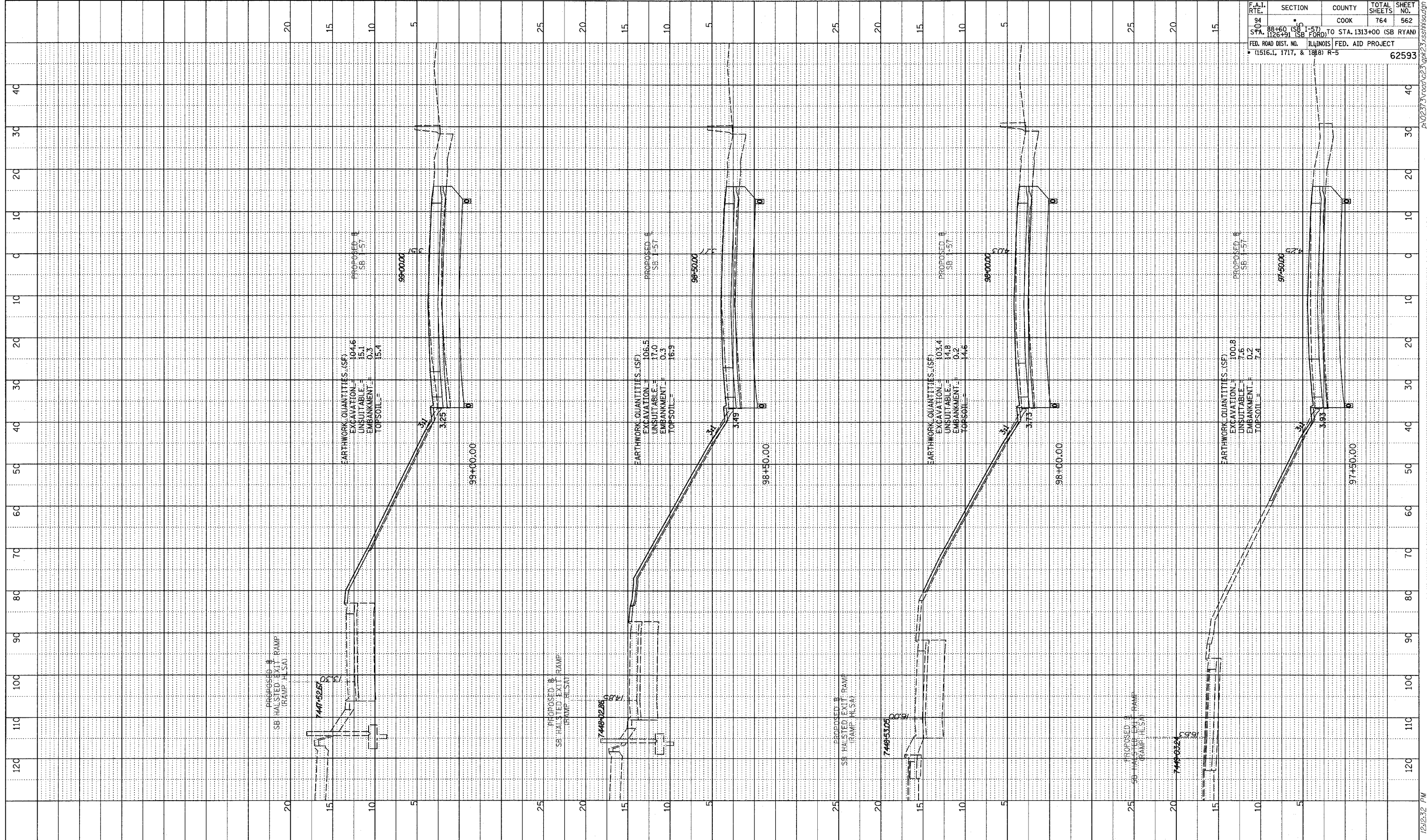

TYLIN INTERNATIONAL

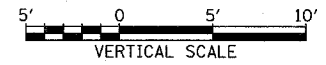

I-57 SOUTHBOUND  
 STA. 97+50 TO STA. 99+00

02/27/2006 12:12:32 PM