

PROFILE SUBMITTED BY: \_\_\_\_\_ DATE: \_\_\_\_\_  
 GRADES CHECKED BY: \_\_\_\_\_  
 NOTE BOOK NO. \_\_\_\_\_  
 E.M. NO. \_\_\_\_\_  
 EMBANKMENT NOTATION: \_\_\_\_\_

F.A.I. RTE.	SECTION	COUNTY	TOTAL SHEETS	SHEET NO.
94		COOK	764	567
STA. 107+50 (SB I-57) TO STA. 108+50 (SB I-57) STA. 107+50 (SB I-57) TO STA. 108+50 (SB I-57)				
FED. ROAD DIST. NO. ILLINOIS FED. AID PROJECT • (1516.1, 1717, & 1818) R-5				
				62593

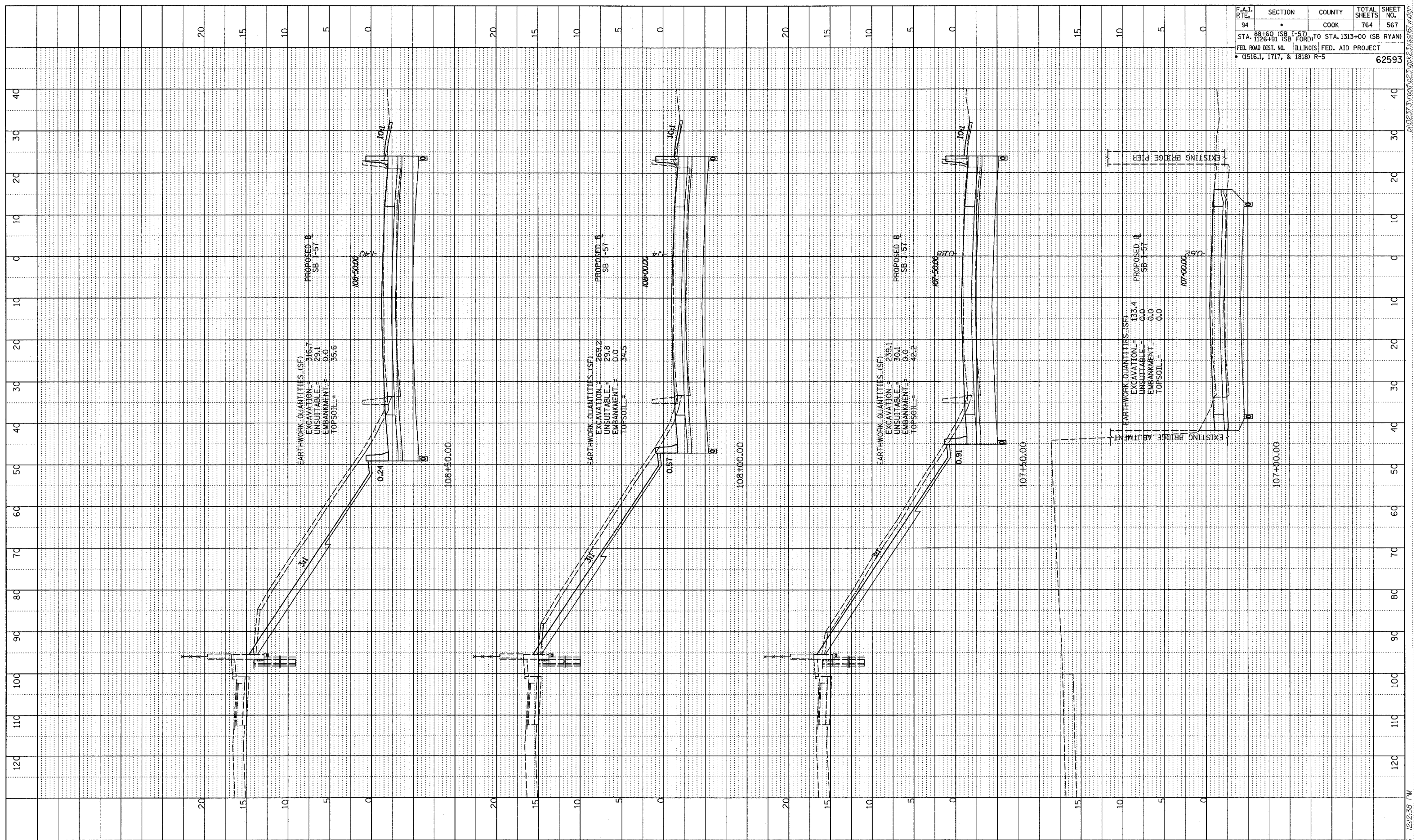

TYLIN INTERNATIONAL

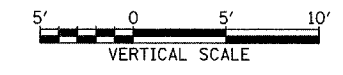
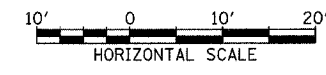

I-57 SOUTHBOUND  
 STA. 107+00 TO STA. 108+50

02/27/2006 12:23:38 PM