

PROFILE SURVEYED \_\_\_\_\_ DATE \_\_\_\_\_  
 PLOTTED \_\_\_\_\_  
 NOTE BOOK \_\_\_\_\_  
 NO. \_\_\_\_\_  
 STRUCTURE NOTATIONS CHNG

F.A.I. RTE.	SECTION	COUNTY	TOTAL SHEETS	SHEET NO.
94	88+60 (SB I-57) TO STA. 126+91 (SB FORD)	COOK	764	578
FED. ROAD DIST. NO. ILLINOIS FED. AID PROJECT				
(1516.1, 1717, & 1818) R-5				
				62593

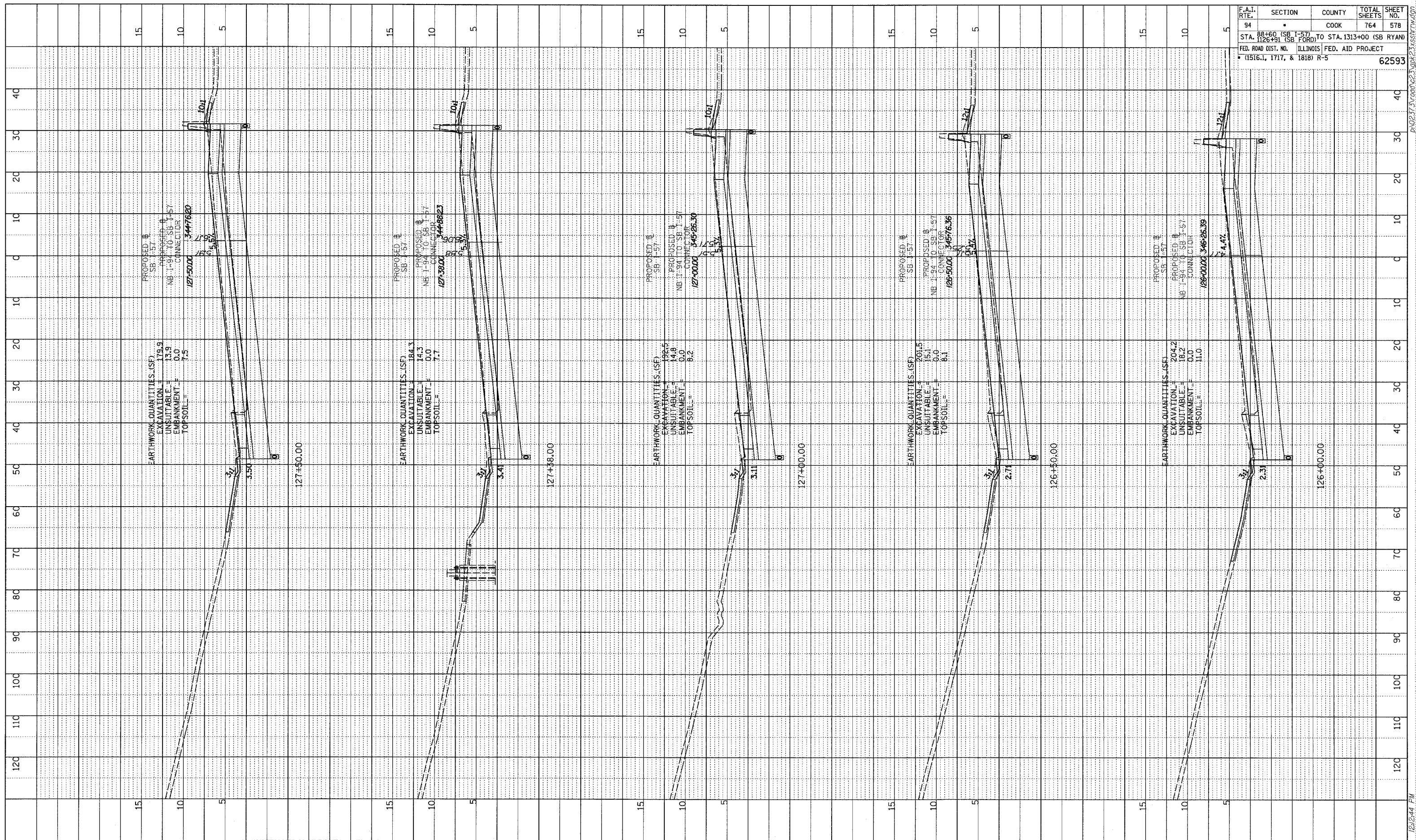

TYLIN INTERNATIONAL

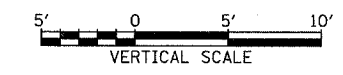
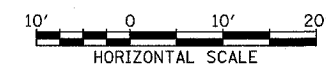

I-57 SOUTHBOUND  
 STA. 126+00 TO STA. 127+50

02/27/2006 12:24:44 PM